



## **Electric Conversion Procedures**



### **WARNING!**

When transitioning from the VESLA Gas to an Electric one, it is crucial to **avoid** reconnecting the **on/off switch from the battery box to the receiver**. The on/off switch has been relocated to the ESC (Electronic Speed Controller). Neglecting this precaution could lead to a short circuit in the ESC, rendering it unprogrammable. Moreover, there is a risk of fire and potential harm. Therefore, it is imperative to exercise caution during the conversion process.



The receiver should have only two wires connected to it:

- Channel 1 - Steering Servo plug
- Channel 2 - ESC wire plug

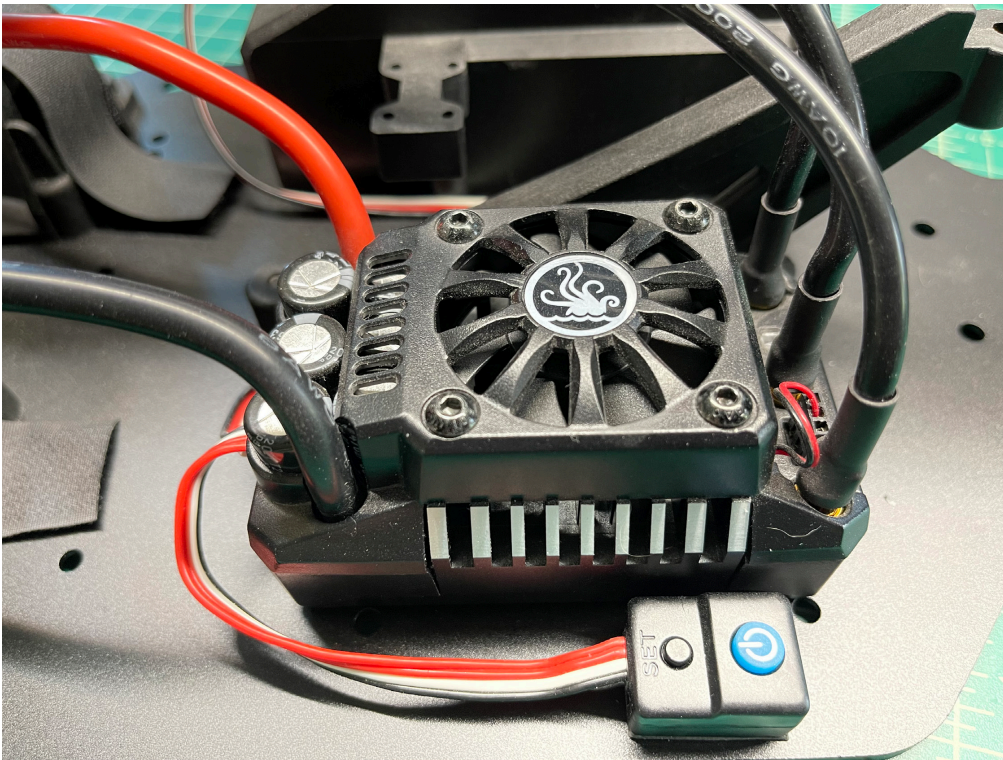

## VESLA.5 Conversion Installation

Please follow the steps to finish the transmission case by using the steps indicated for Gas

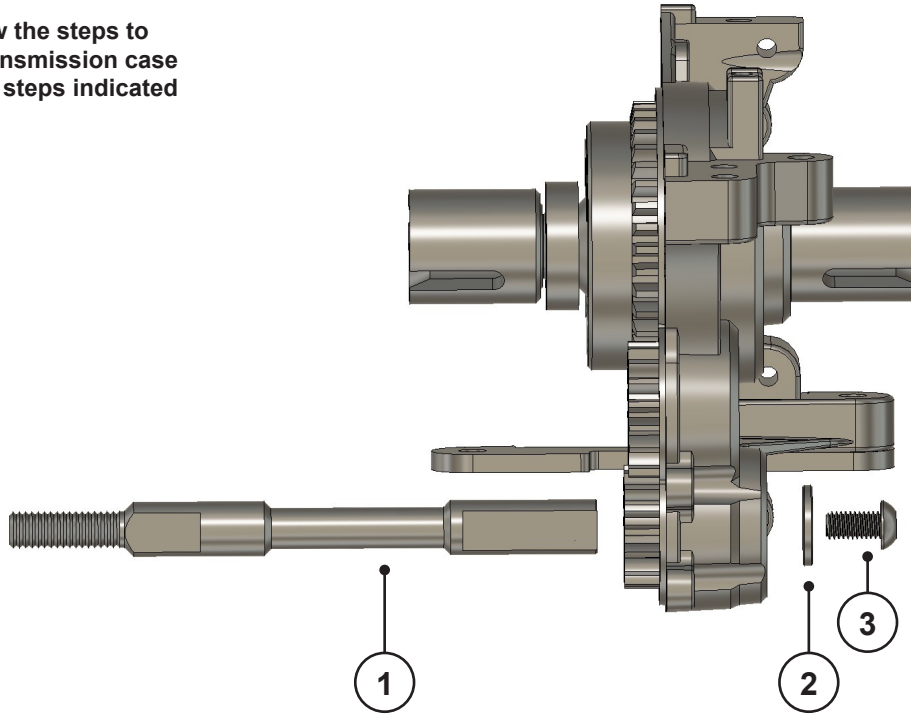

Assembly	Item Number	Name	Quantity
1		Electric Drive Shaft	1
2		Washer 6x18x2	1
3		BH 6x12mm	1

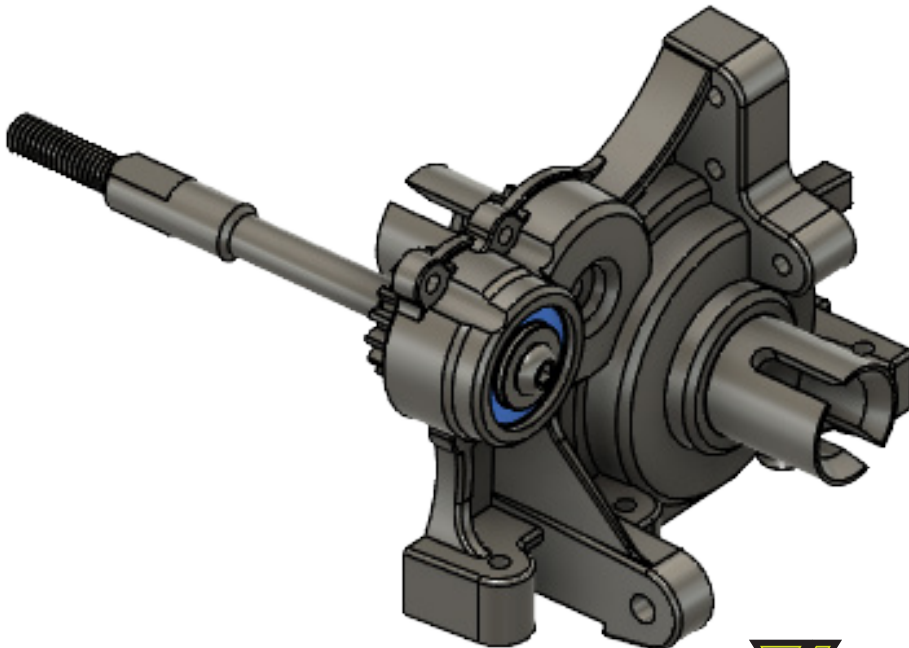

**VESLA.5**



# VESLA.5 Conversion Installation

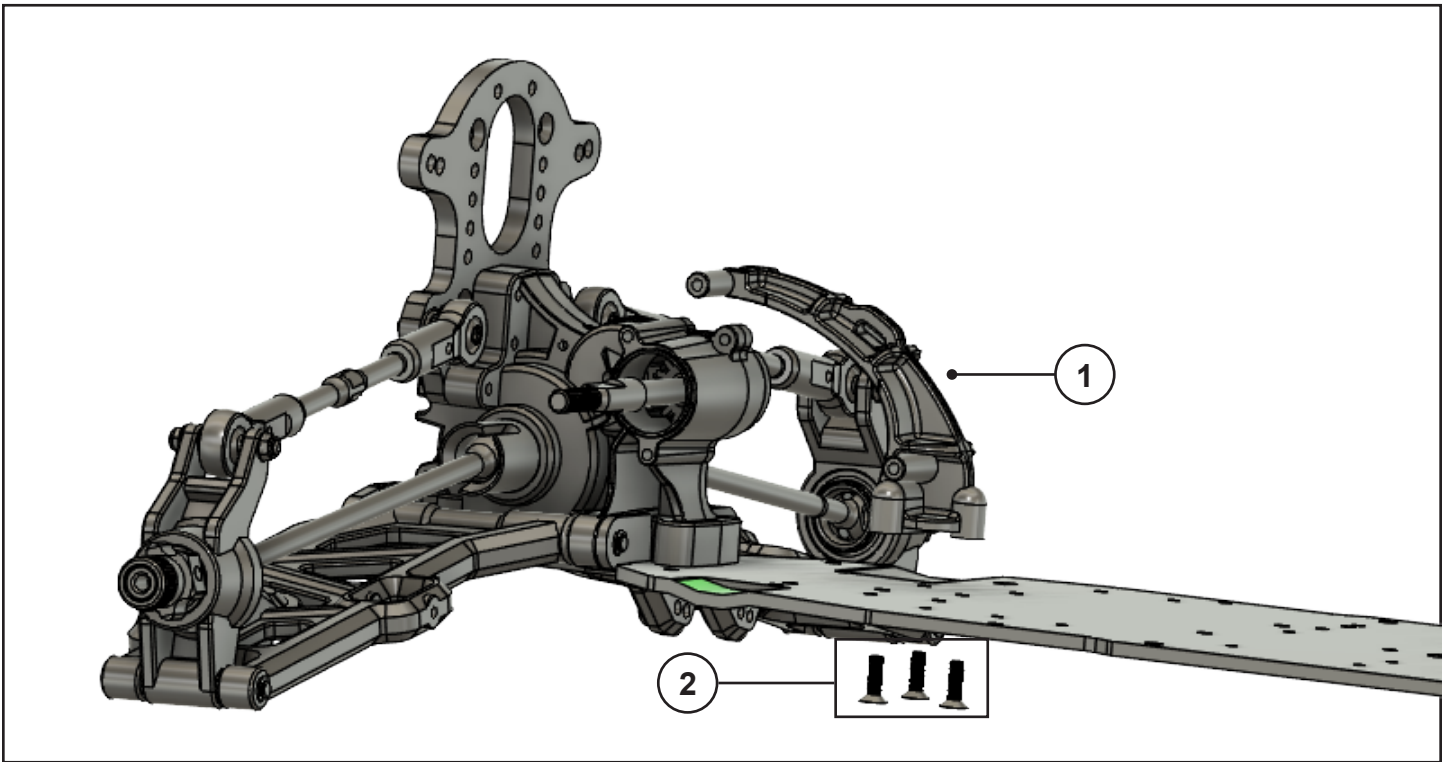

Assembly	Item Number	Name	Quantity
1		Bracket	1
2		FH 5x16	3

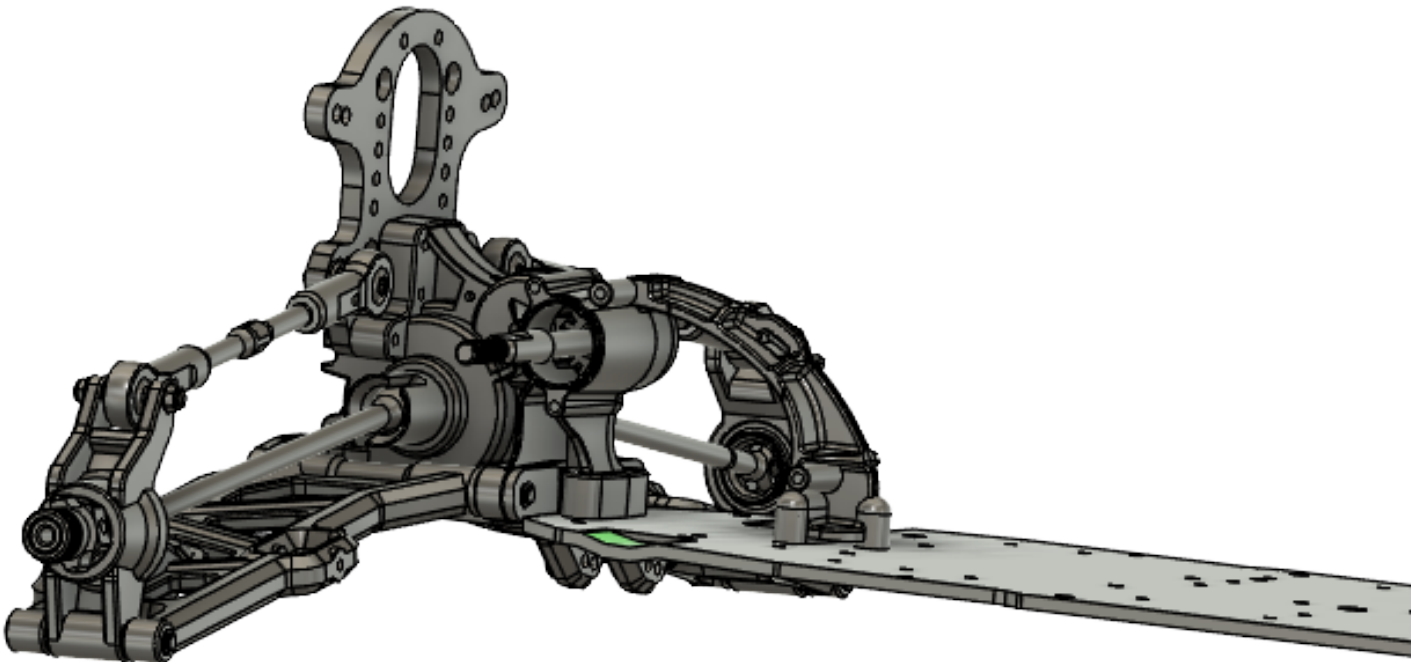

# VESLA.5 Conversion Installation

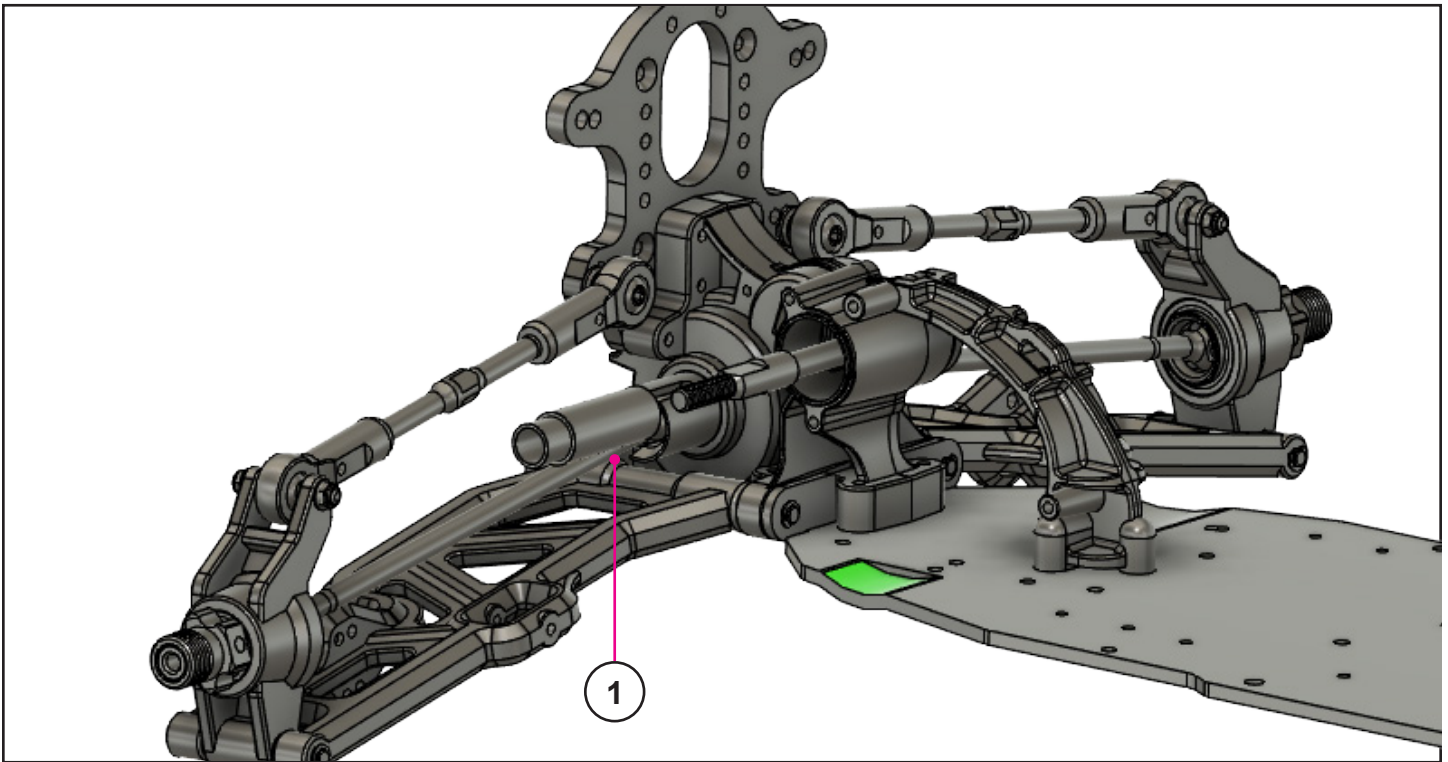

Assembly	Item Number	Name	Quantity
1		Spacer	1

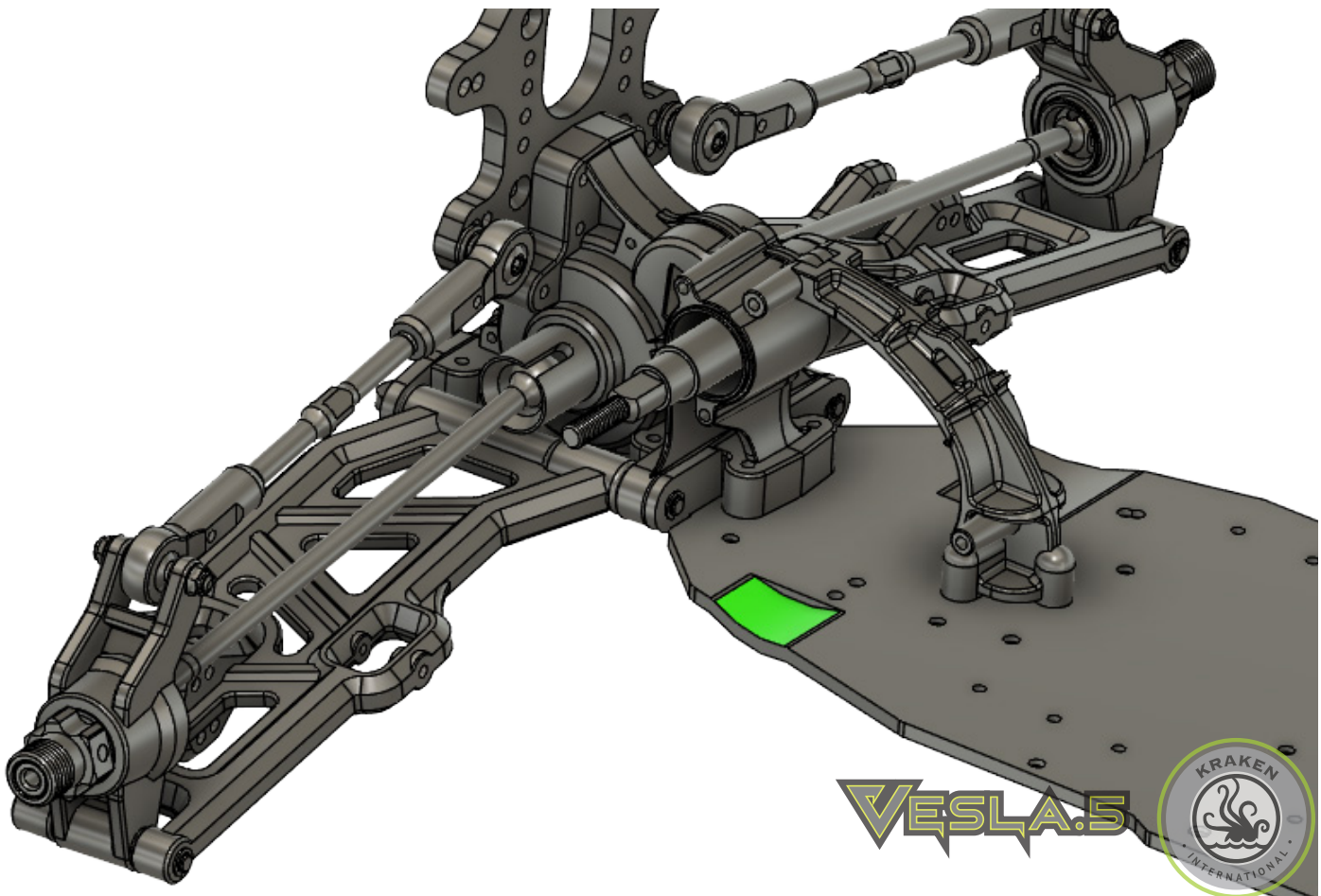

## VESLA.5 Conversion Installation

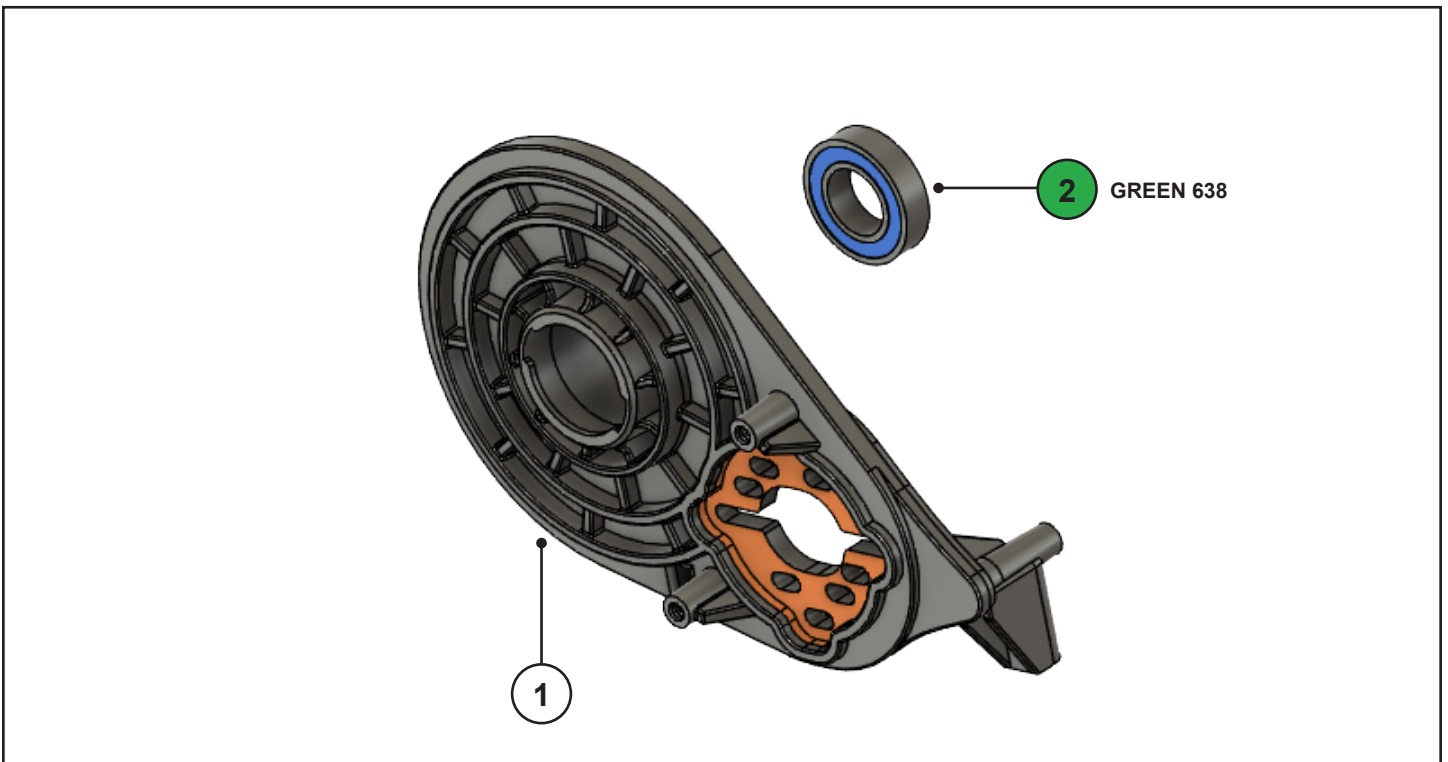

Assembly	Item Number	Name	Quantity
1		Motor Plate	1
2		Bearing 15x28x7	1



**VESLA.5**



# VESLA.5 Conversion Installation

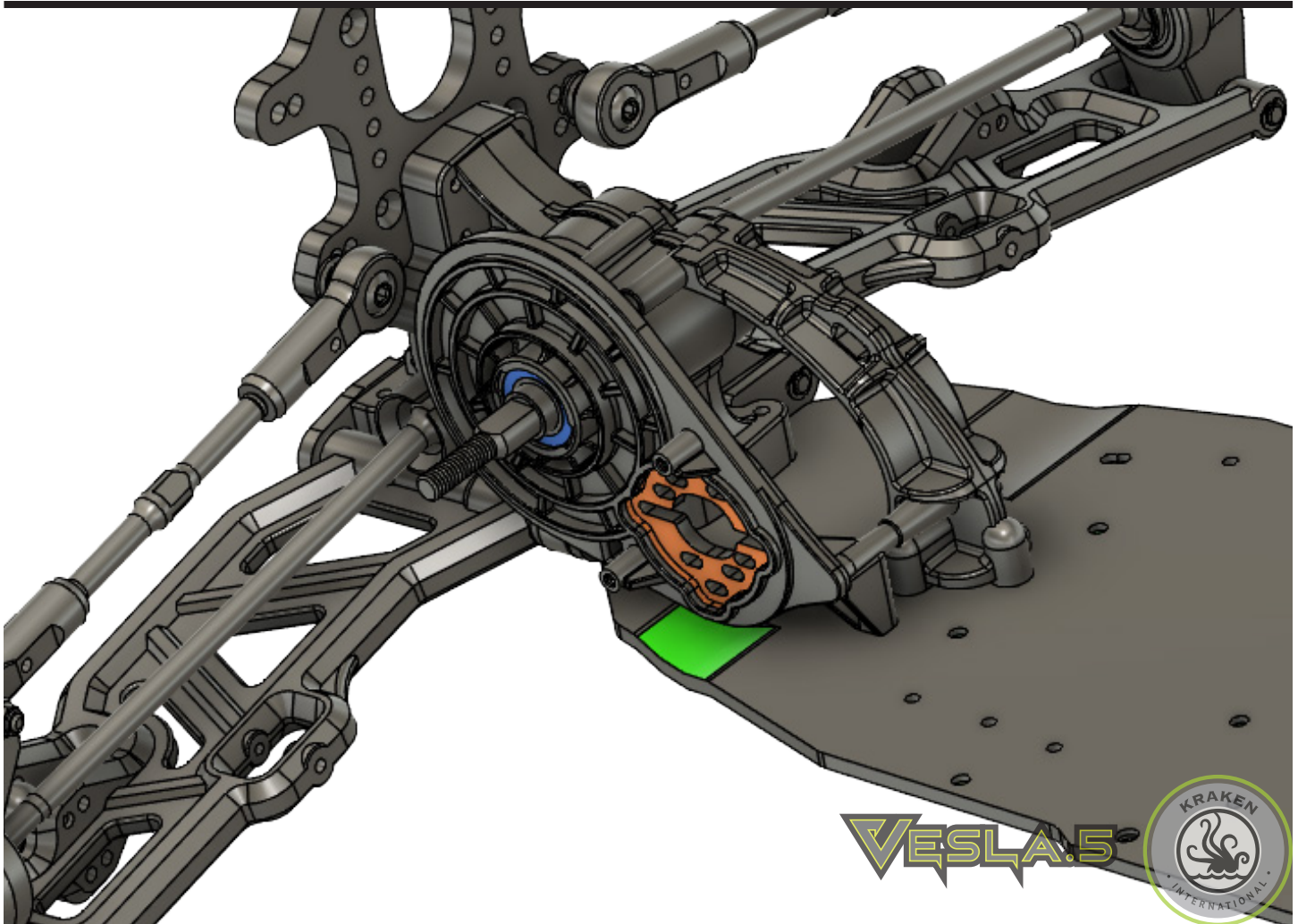
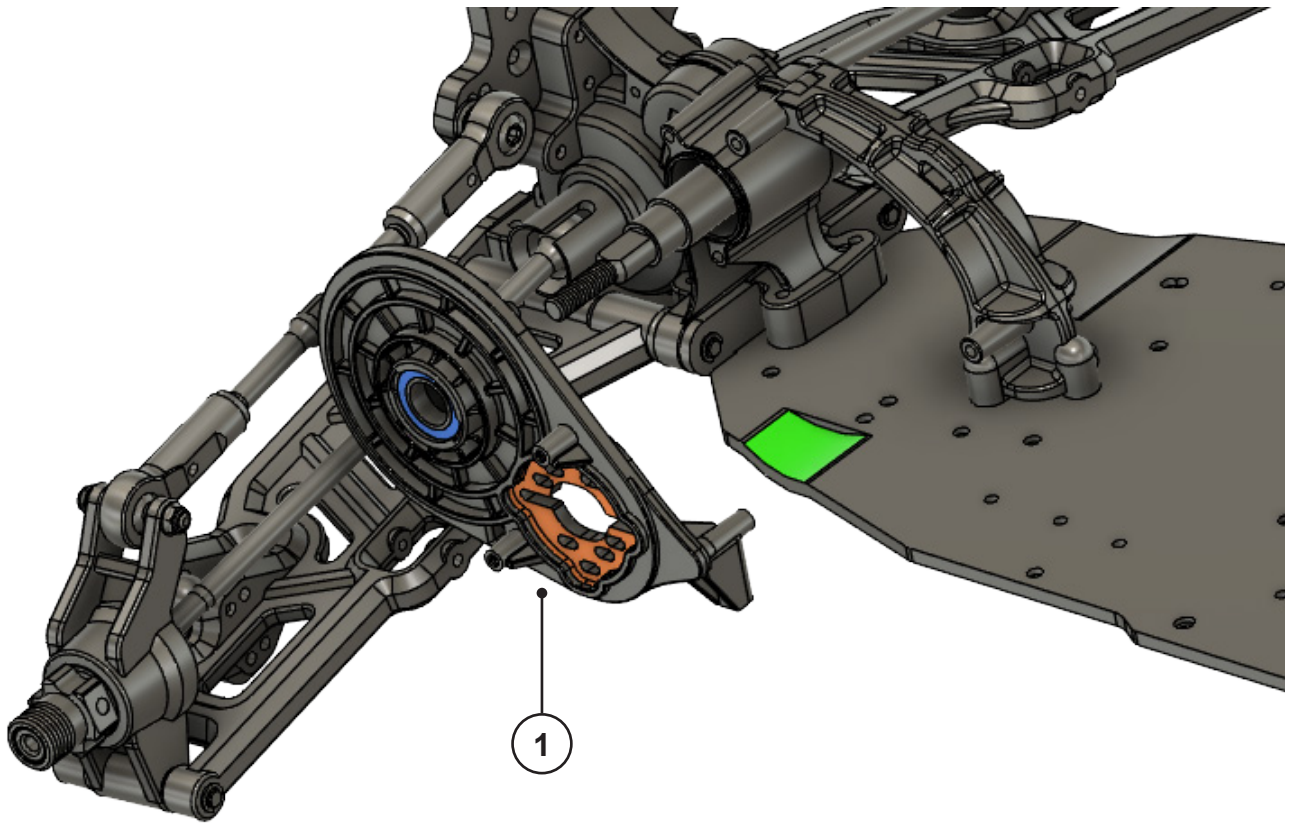

# VESLA.5 Conversion Installation

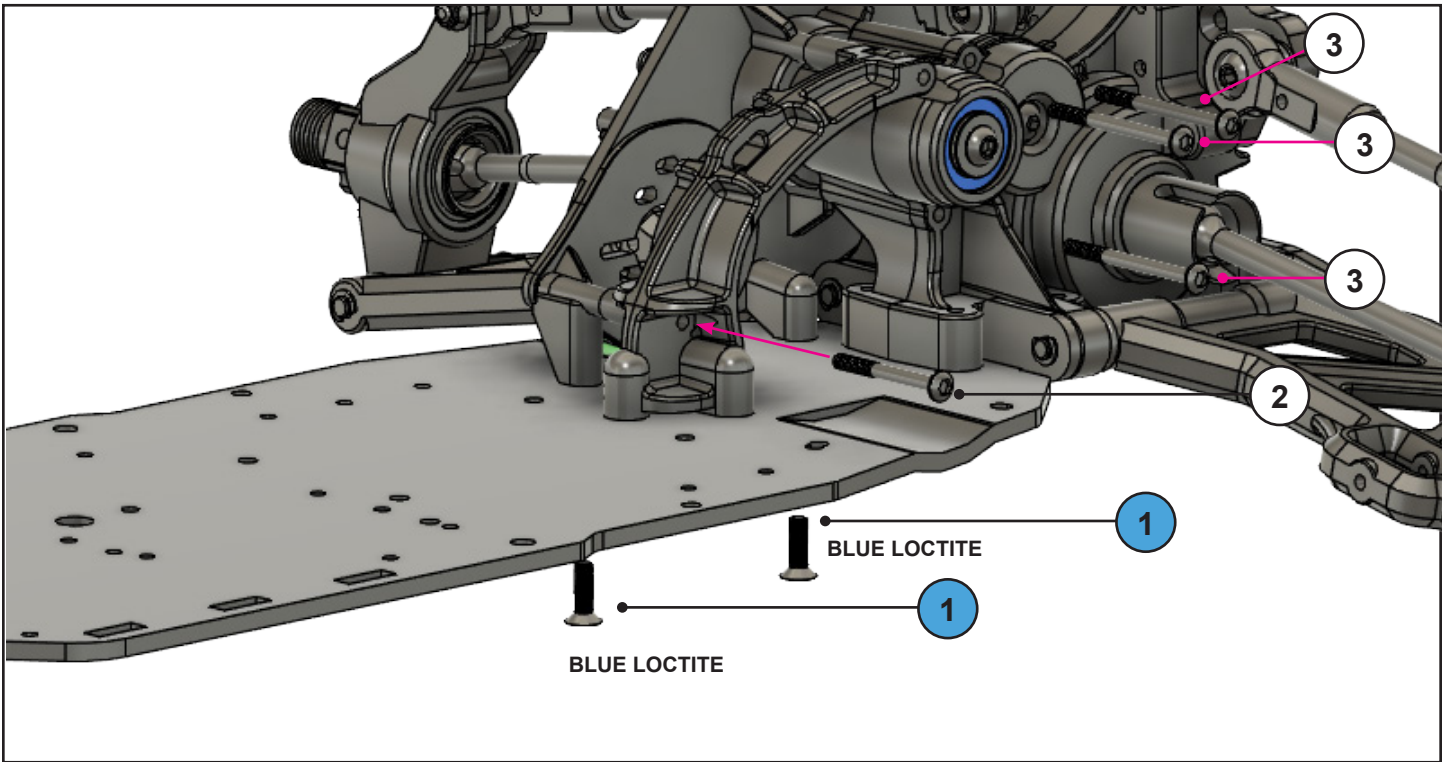

Assembly	Item Number	Name	Quantity
1		FH 5x16	2
2		BH 4x40	1
3		BH 4x50	3

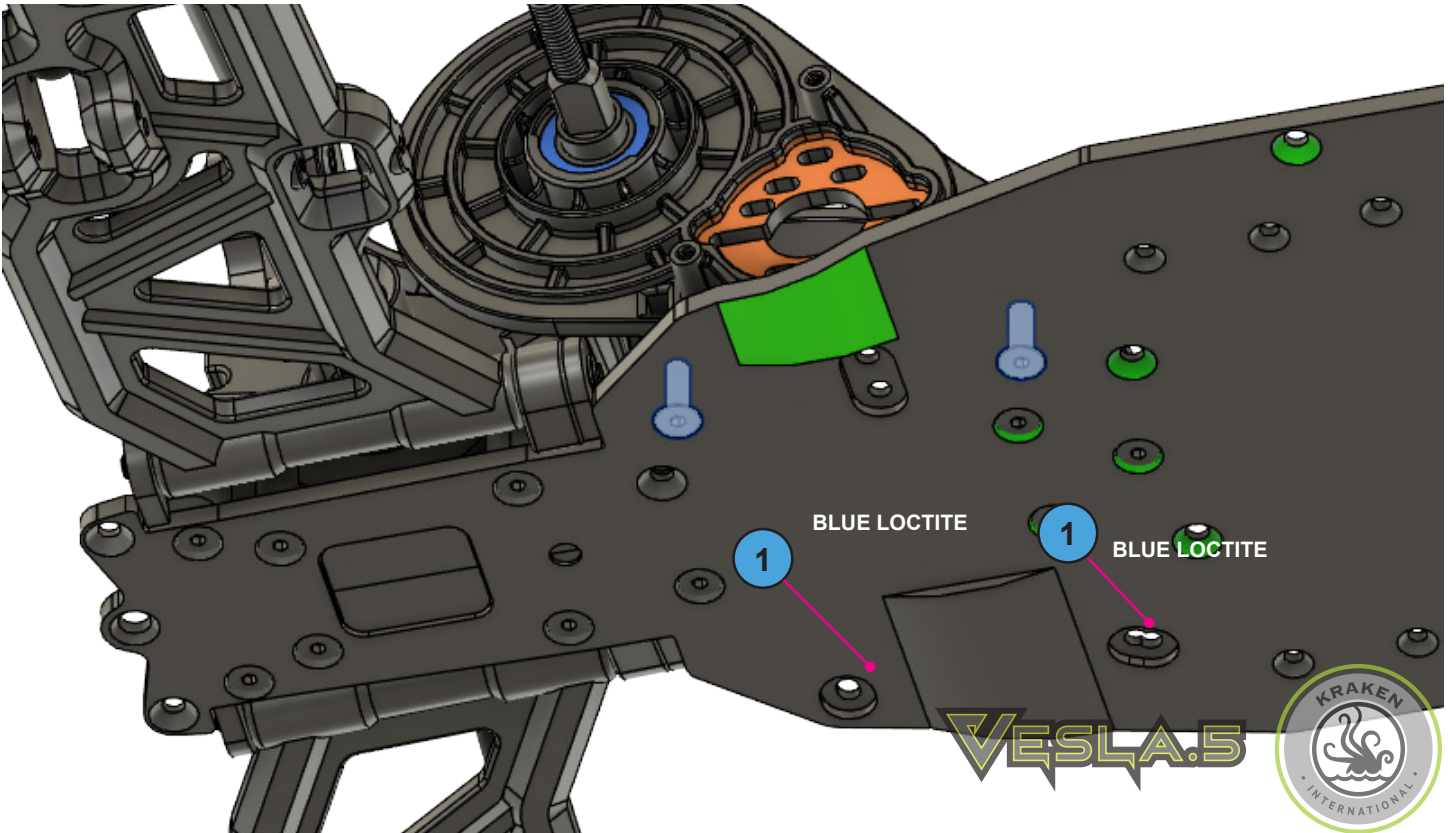



## VESLA.5 Conversion Installation

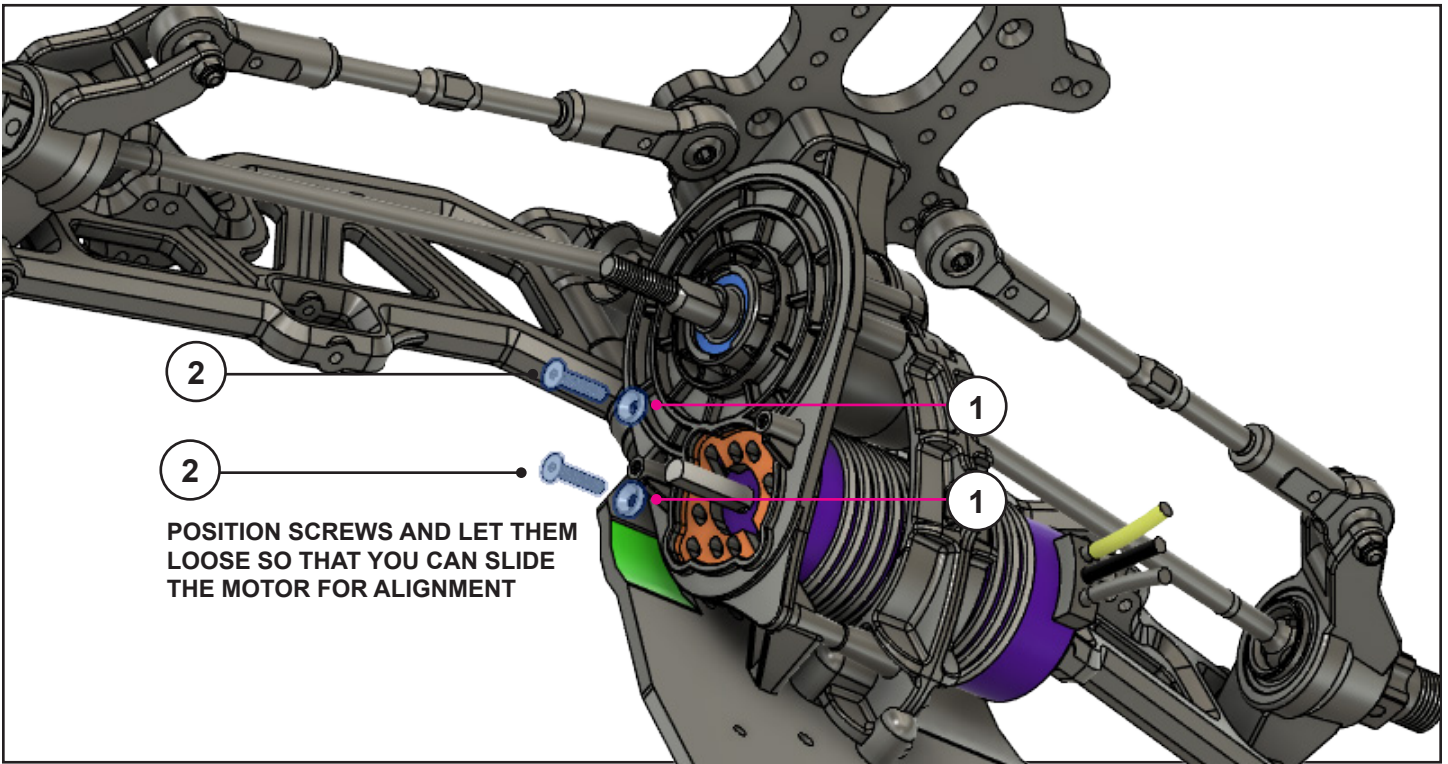

Assembly	Item Number	Name	Quantity
1		Washer FH4	2
2		Screw FH4x16	2

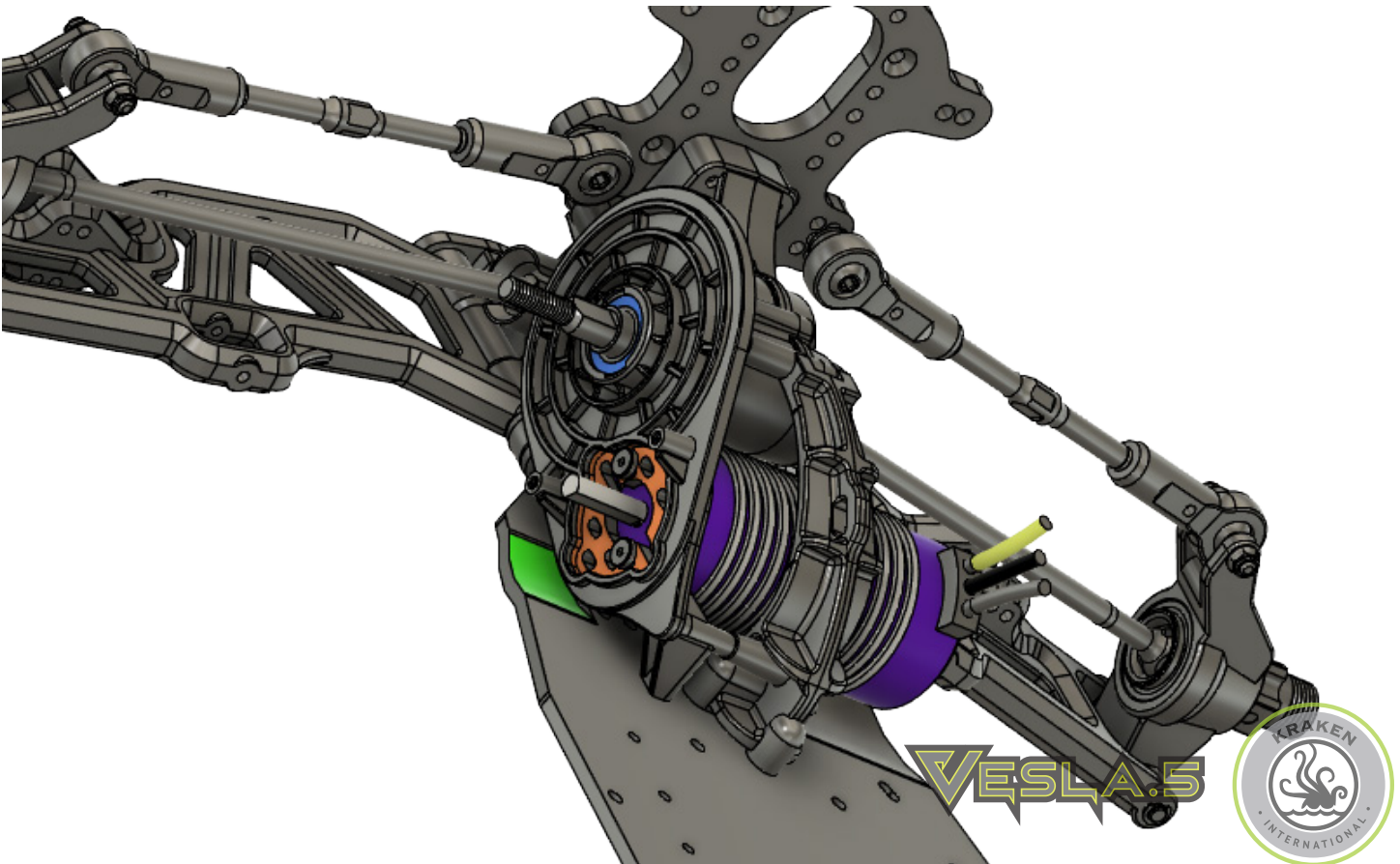

## VESLA.5 Conversion Installation

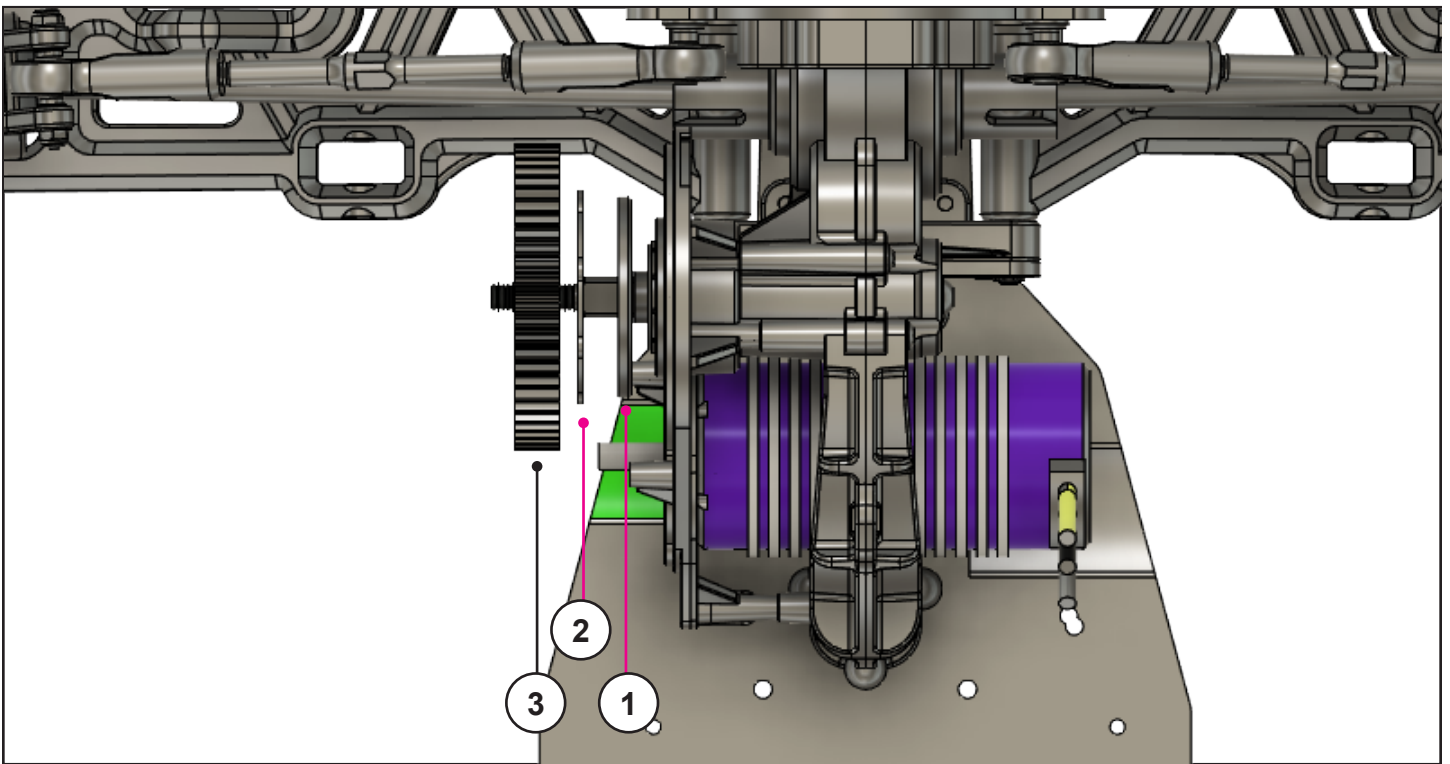

Assembly	Item Number	Name	Quantity
1		Slipper Disk	1
2		Slipper Pad	1
3		Slipper Gear M1.5 T57	1

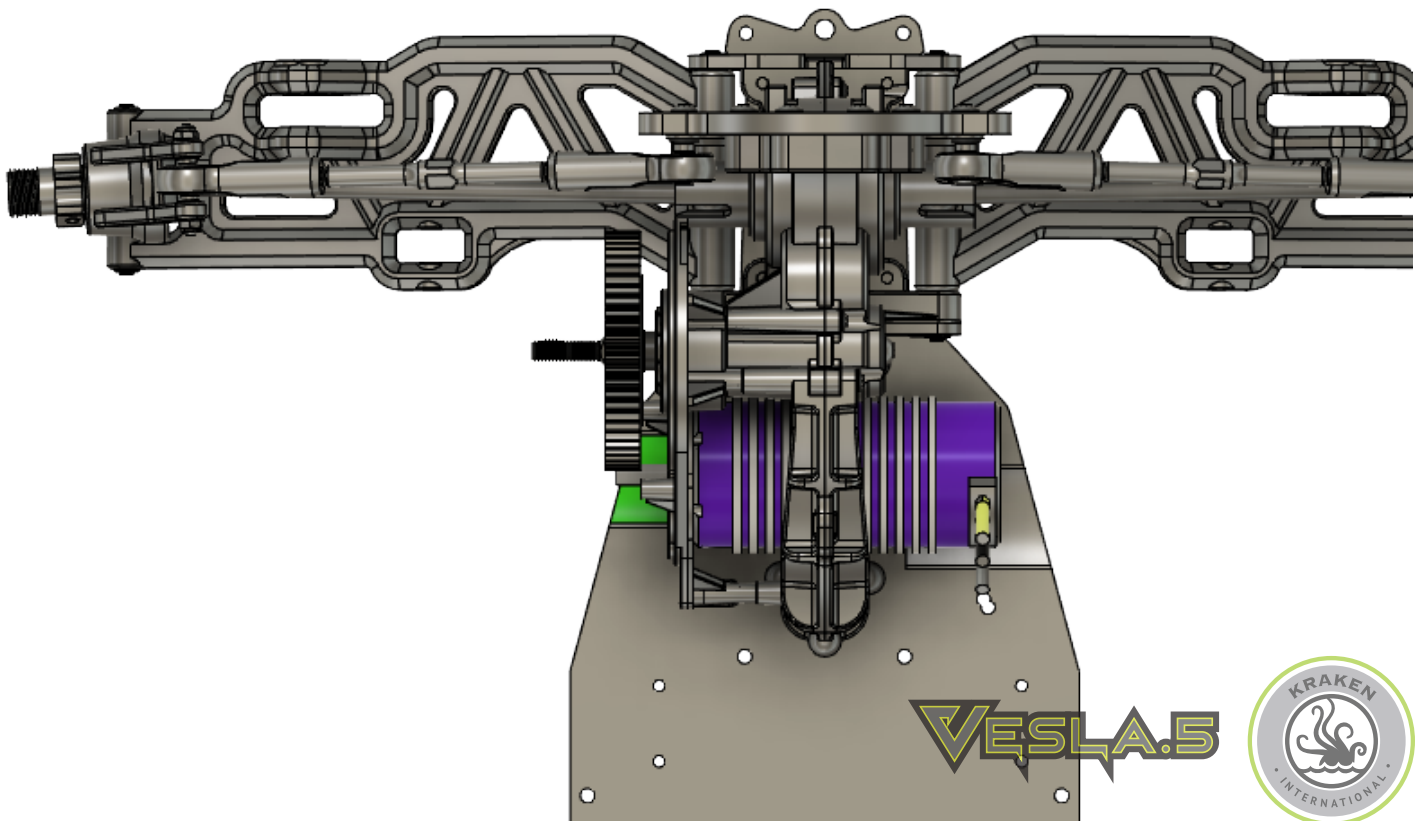

**VESLA.5**



# VESLA.5 Conversion Installation

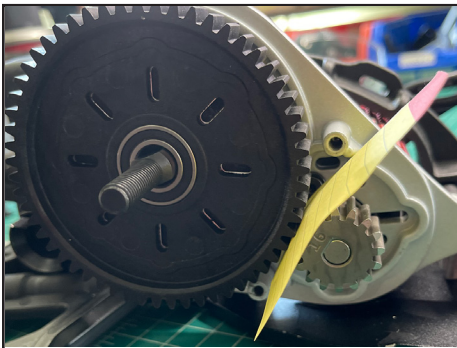

Align the Spur Gear "Squarely" to the Pinion Gear and put a piece of paper in between them for correct gear mesh alignment. Then tighten the 2 set screws with Red Loctite

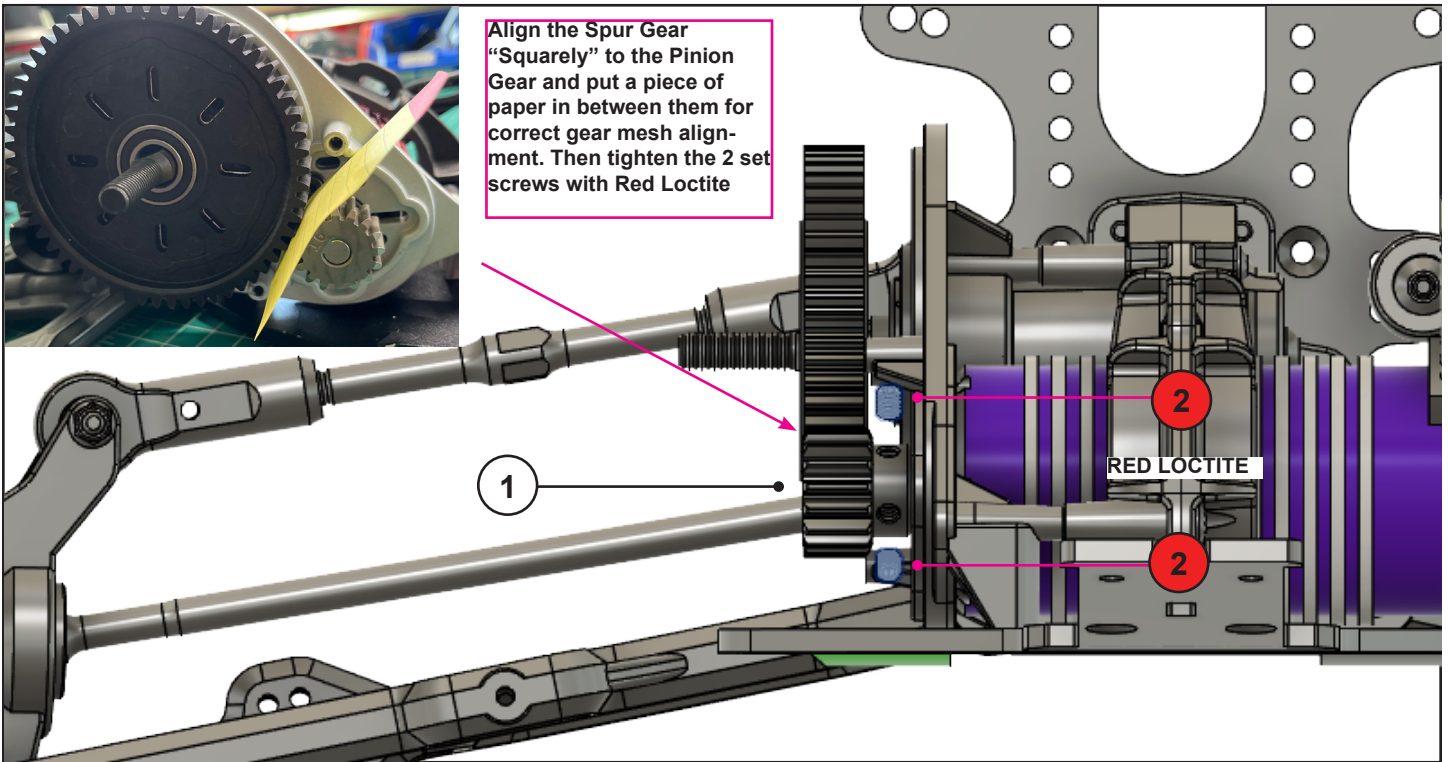

Assembly	Item Number	Name	Quantity
1		Pinion Gear T16	1
2		Set Screw 5x6	2

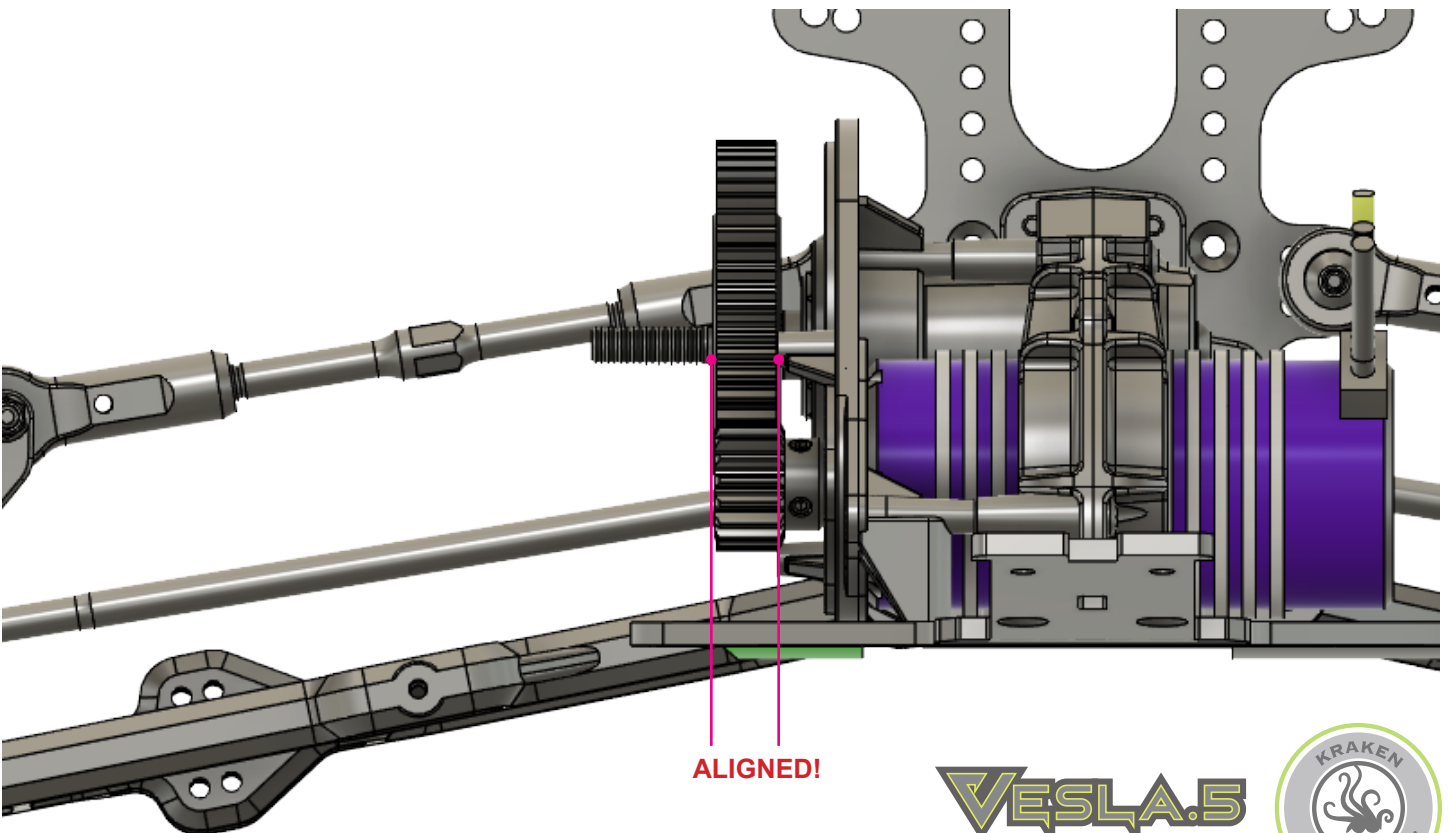

# VESLA.5 Conversion Installation

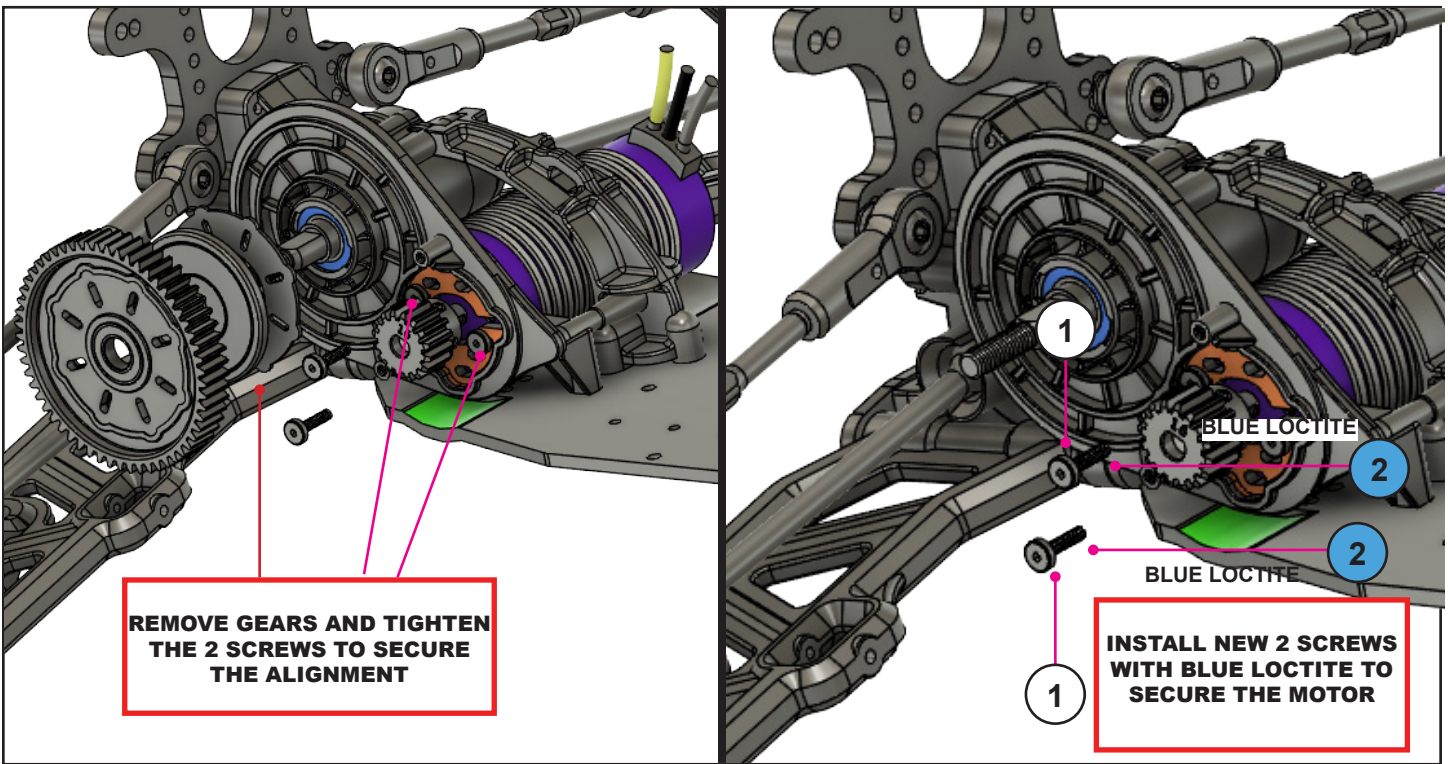

Assembly	Item Number	Name	Quantity
1		Washer FH4	2
2		Screw FH4x16	2

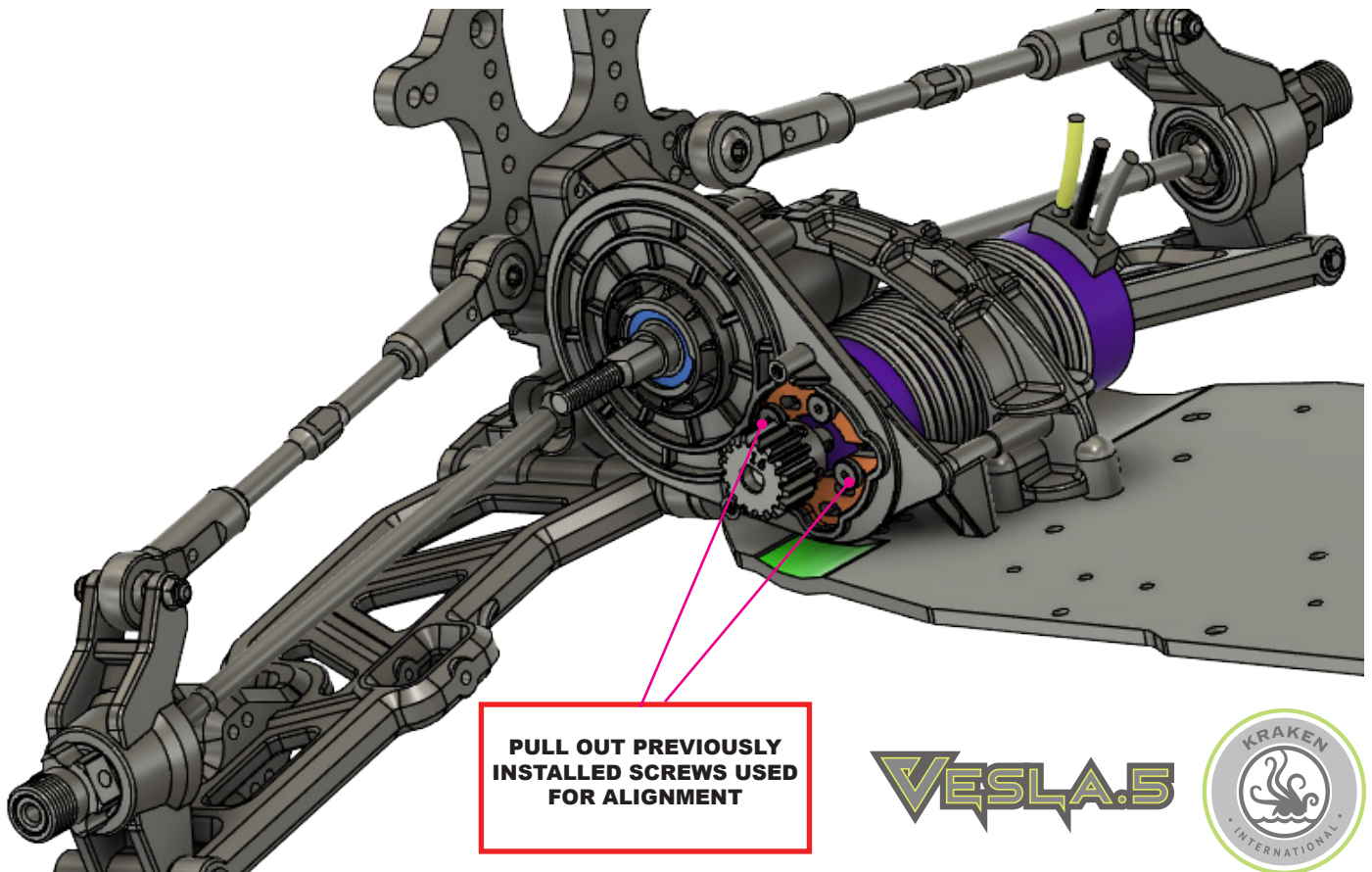

## VESLA.5 Conversion Installation

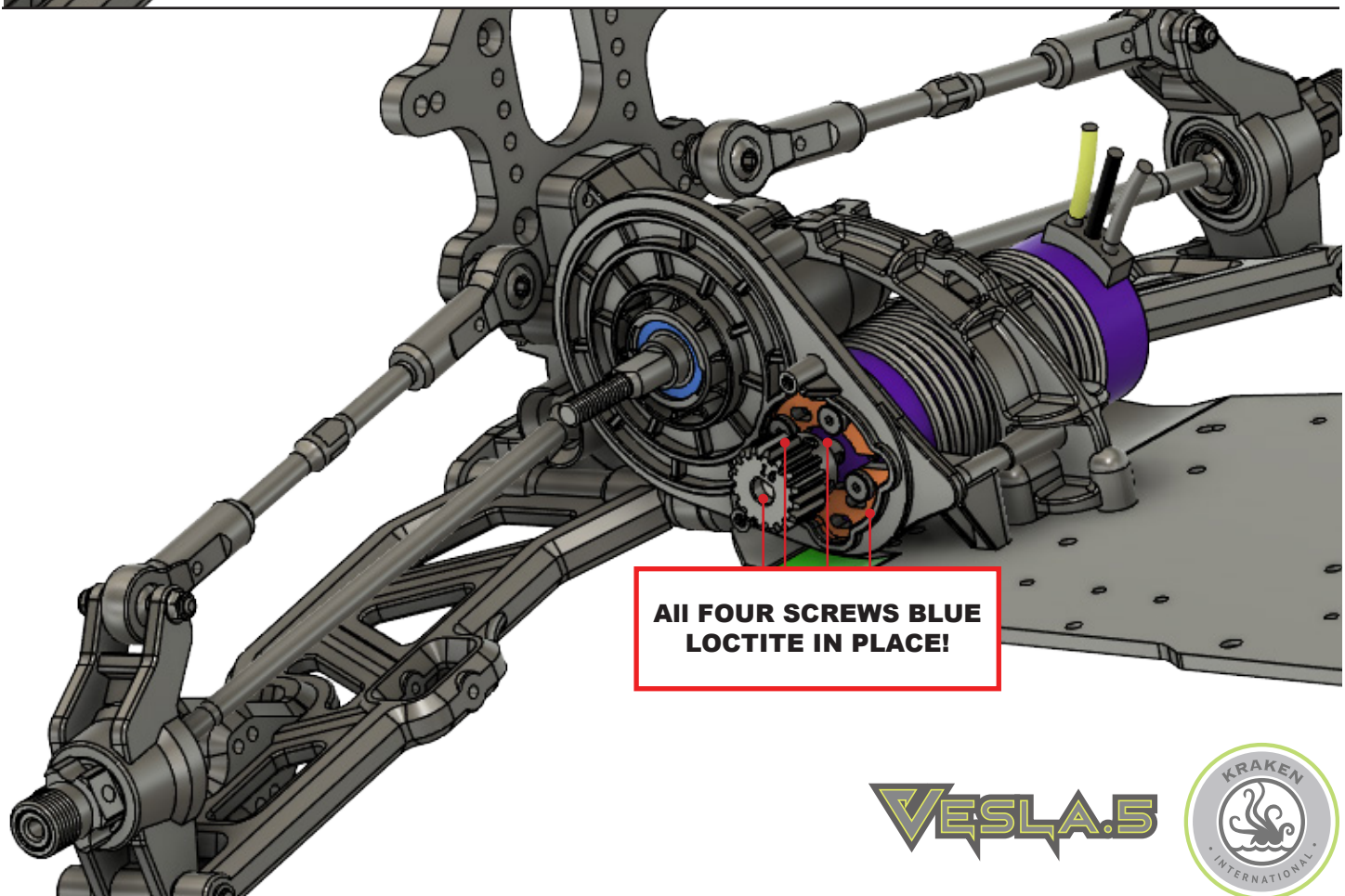
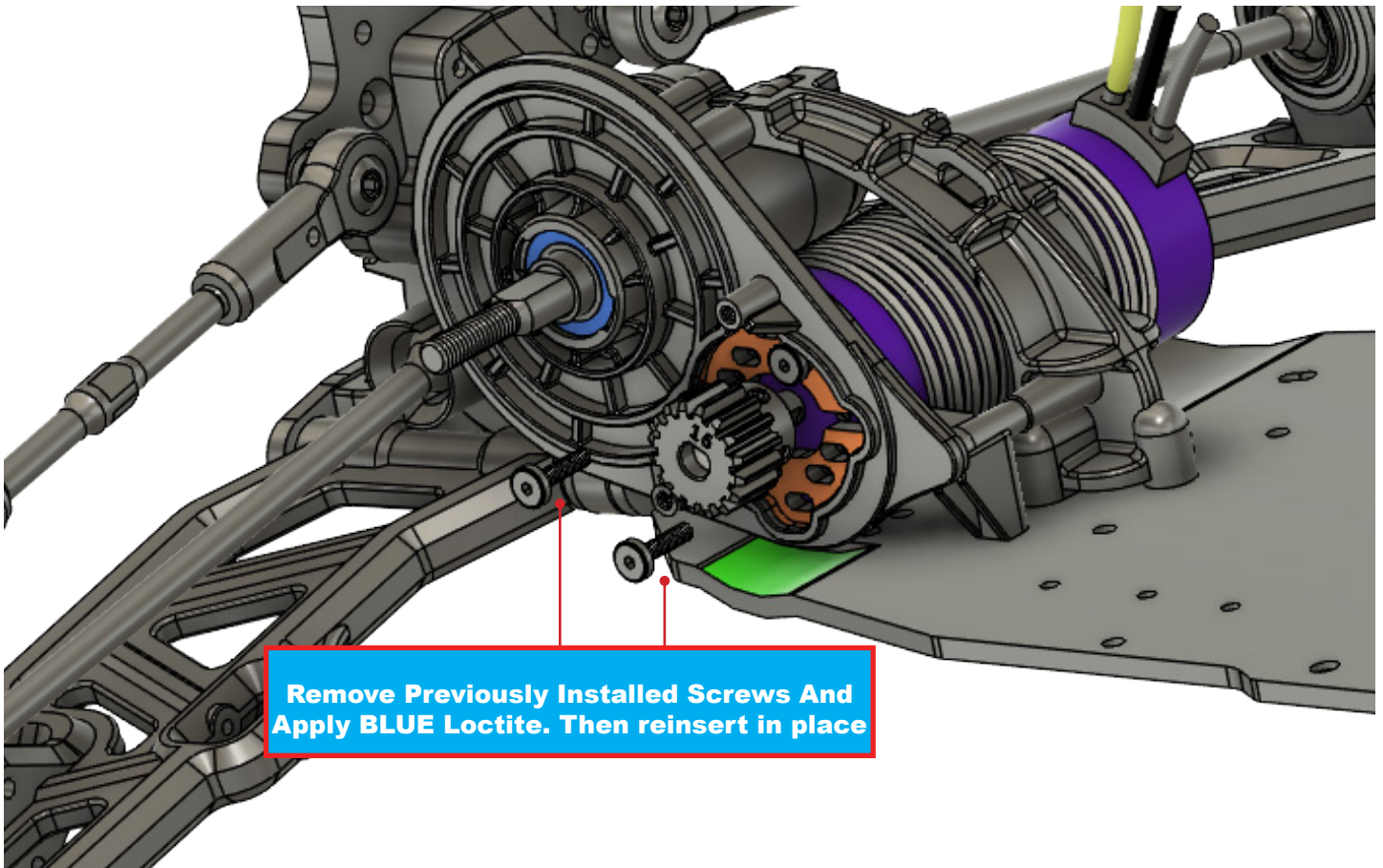

VESLA.5



# VESLA.5 Conversion Installation

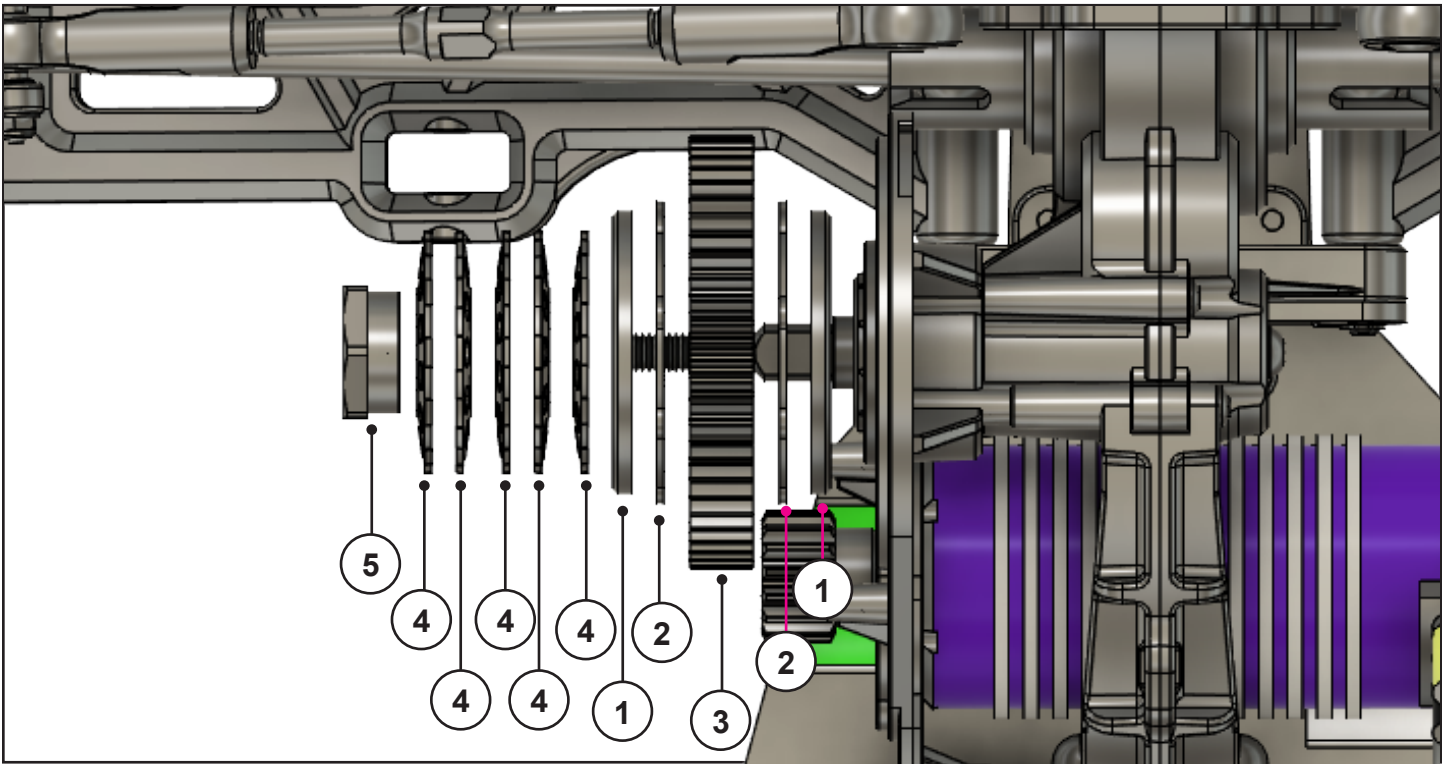

Assembly	Item Number	Name	Quantity
1		Slipper Disk	2
2		Slipper Pad	2
3		Slipper Gear M1.5 T57	1
4		Disk Spring	5
5		Slipper Adjusting Nut	1

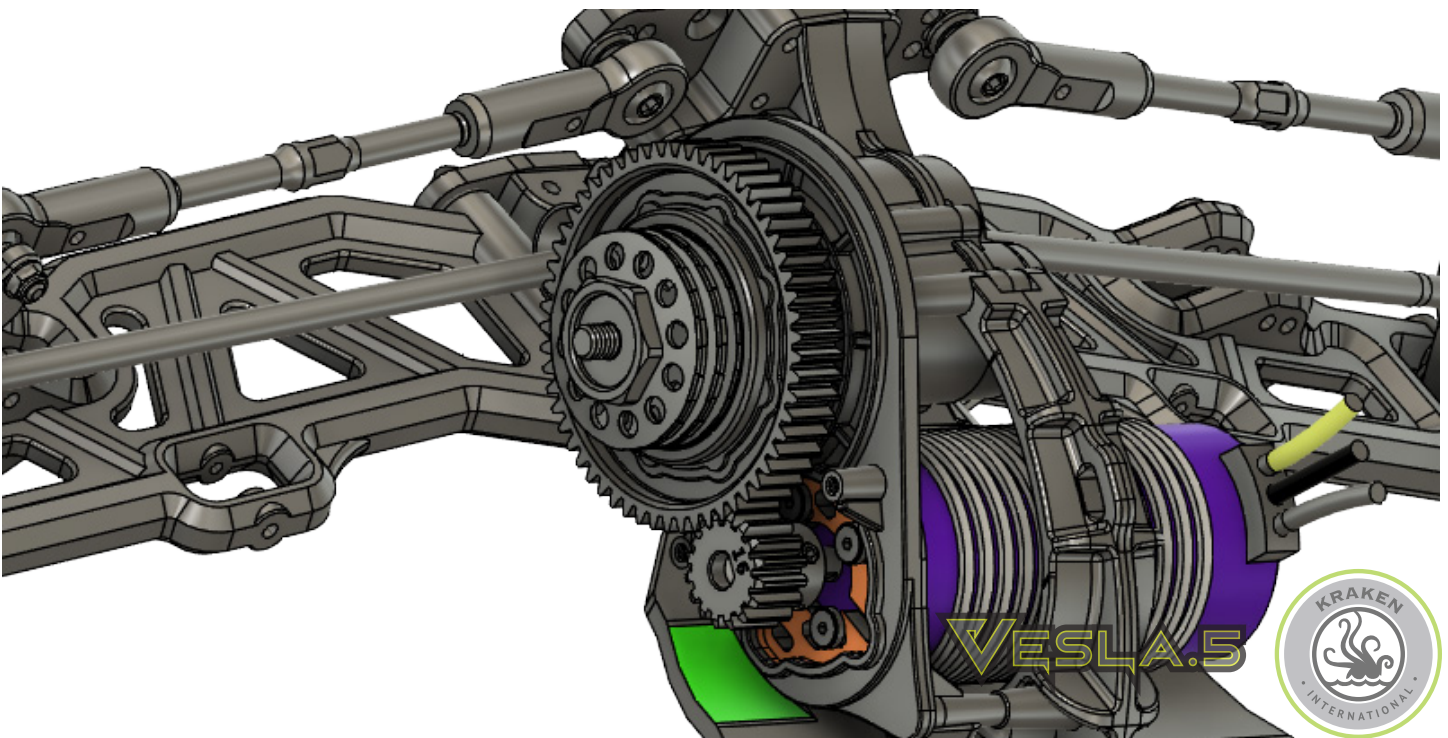

## VESLA.5 Conversion Installation

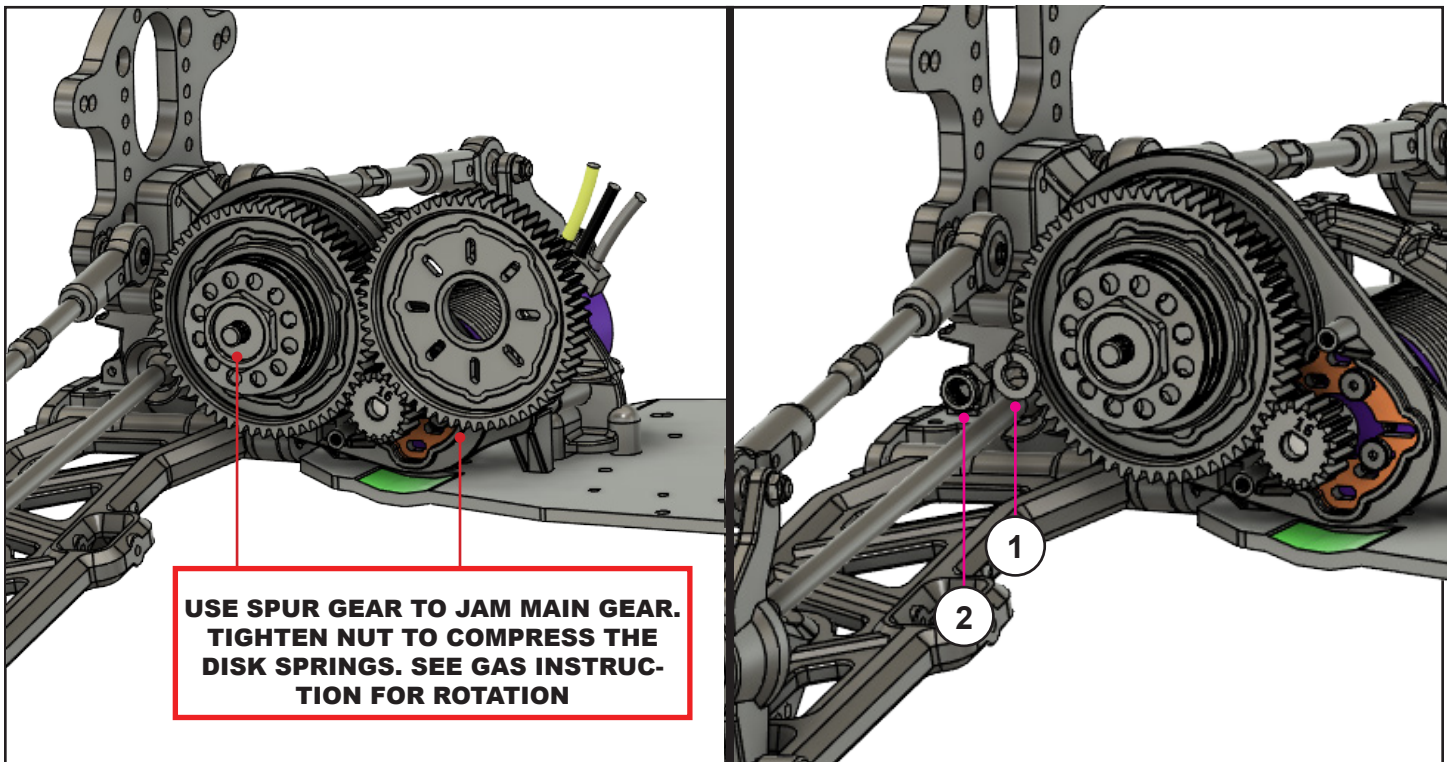

Assembly	Item Number	Name	Quantity
1		Washer S8x15.6x2.5	1
2		Lock Nut 080	1

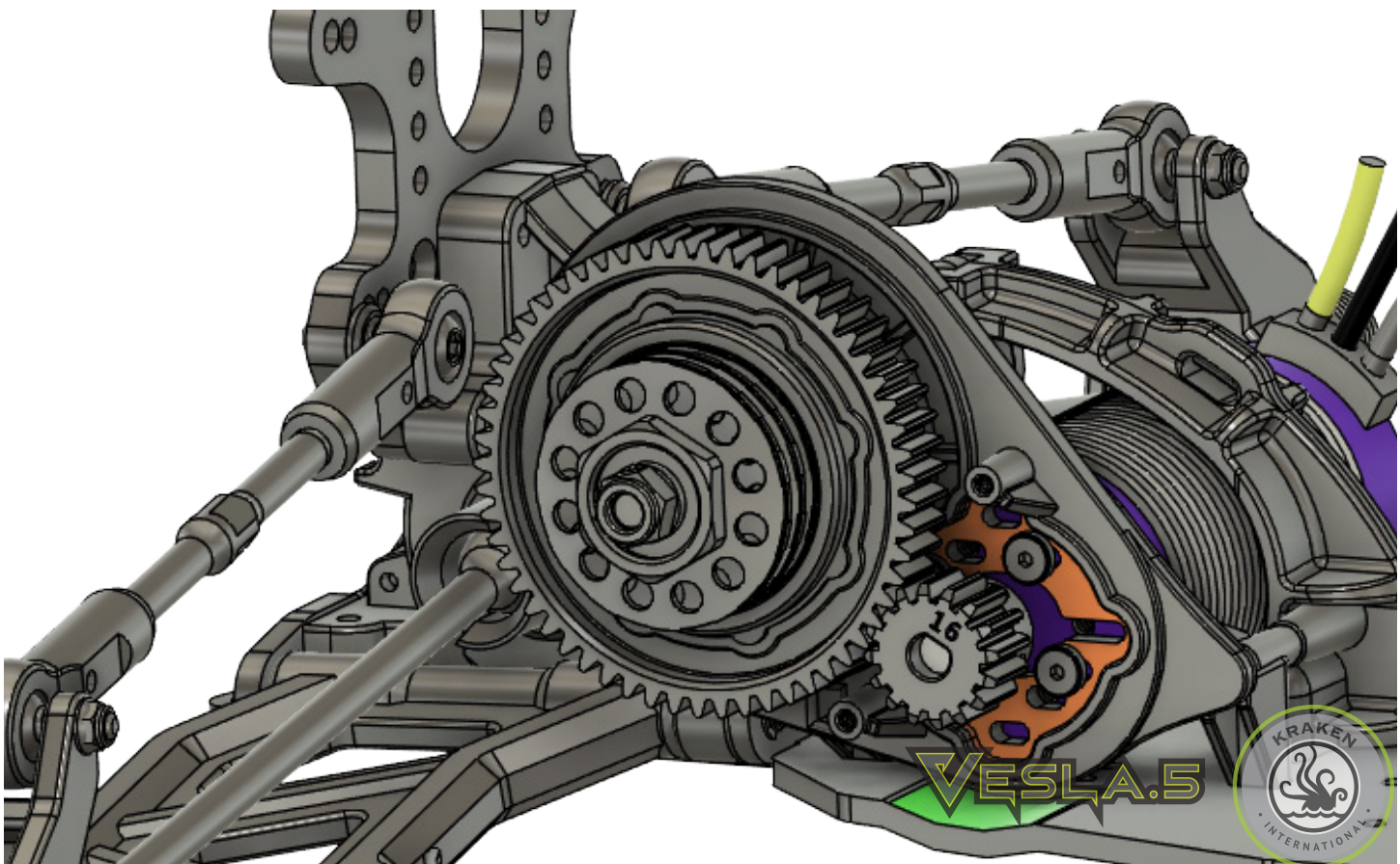

## VESLA.5 Conversion Installation

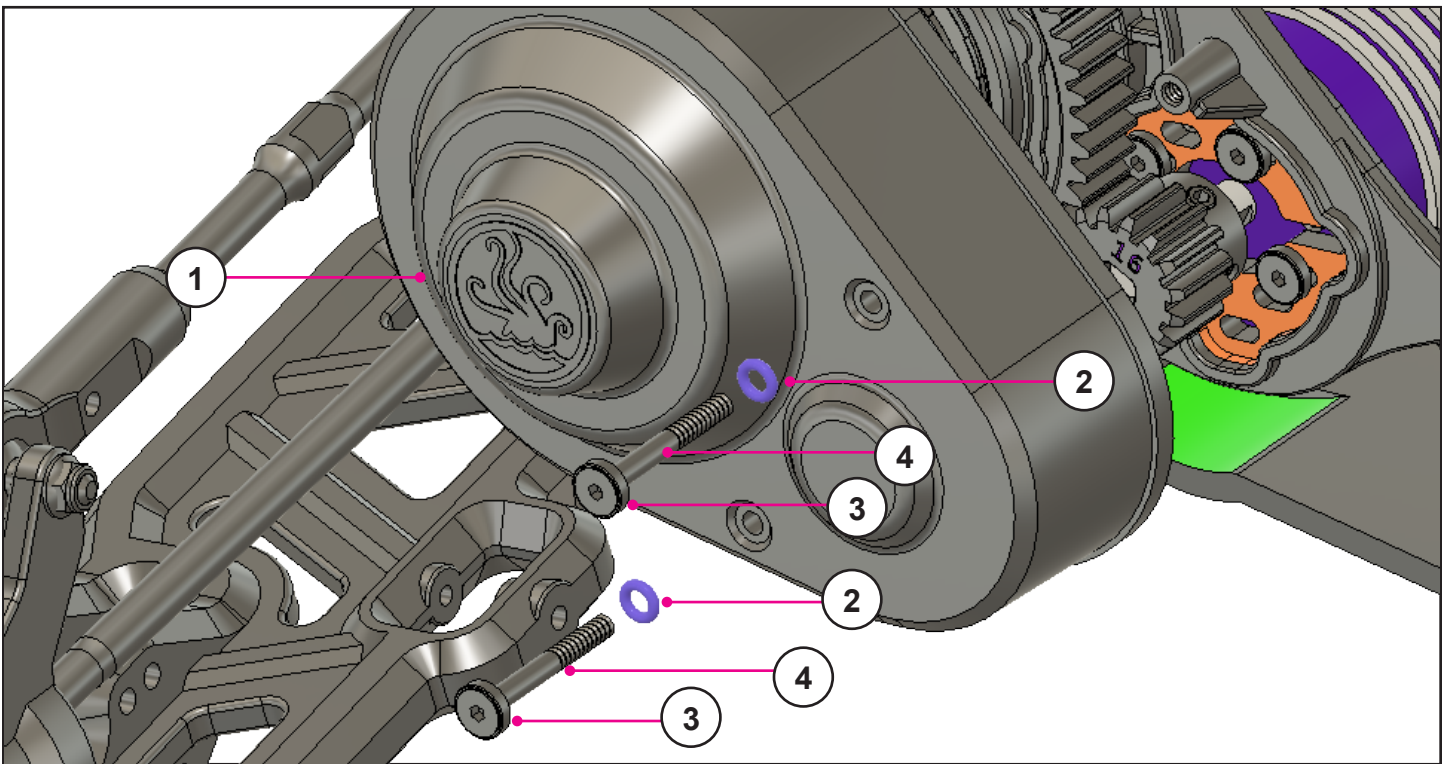

Assembly	Item Number	Name	Quantity
1		Gear Cover	1
2		O-Ring,038x019	2
3		Washer FH4	2
4		Screw FH4x30	2

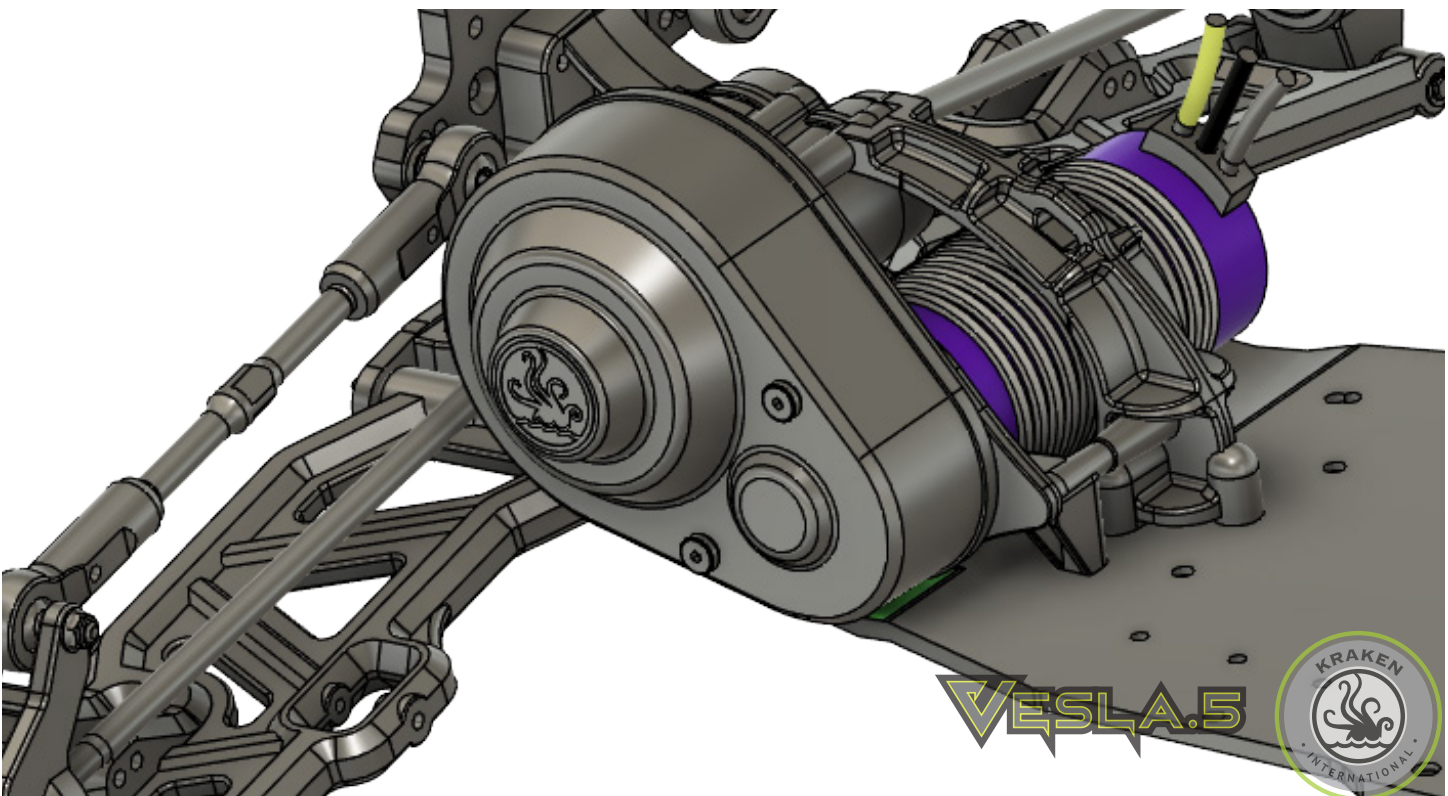



## VESLA.5 Conversion Installation

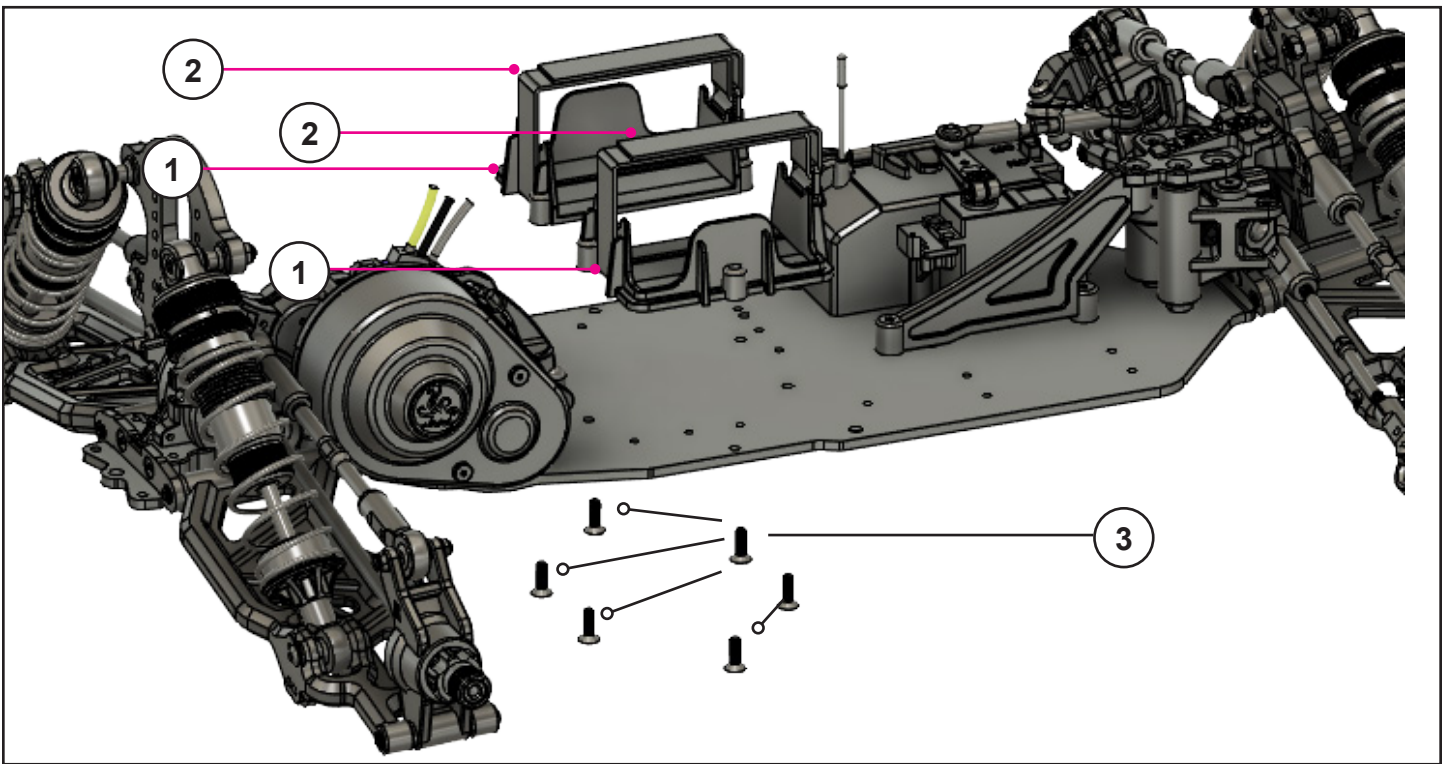

Assembly	Item Number	Name	Quantity
1		Battery Holder	2
2		Velcro Straps	2
3		Screw FH5x16	6

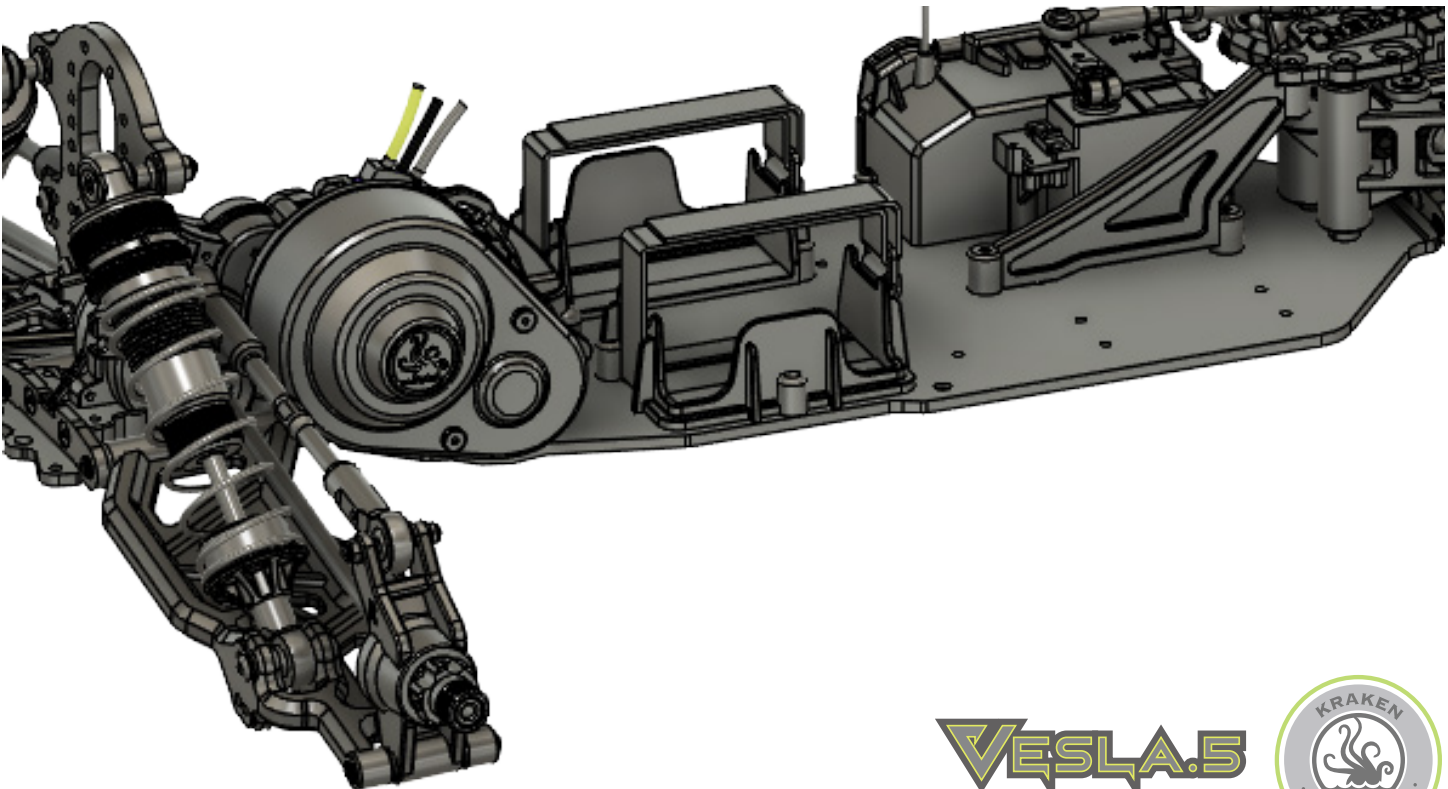

# VESLA.5 Conversion Installation

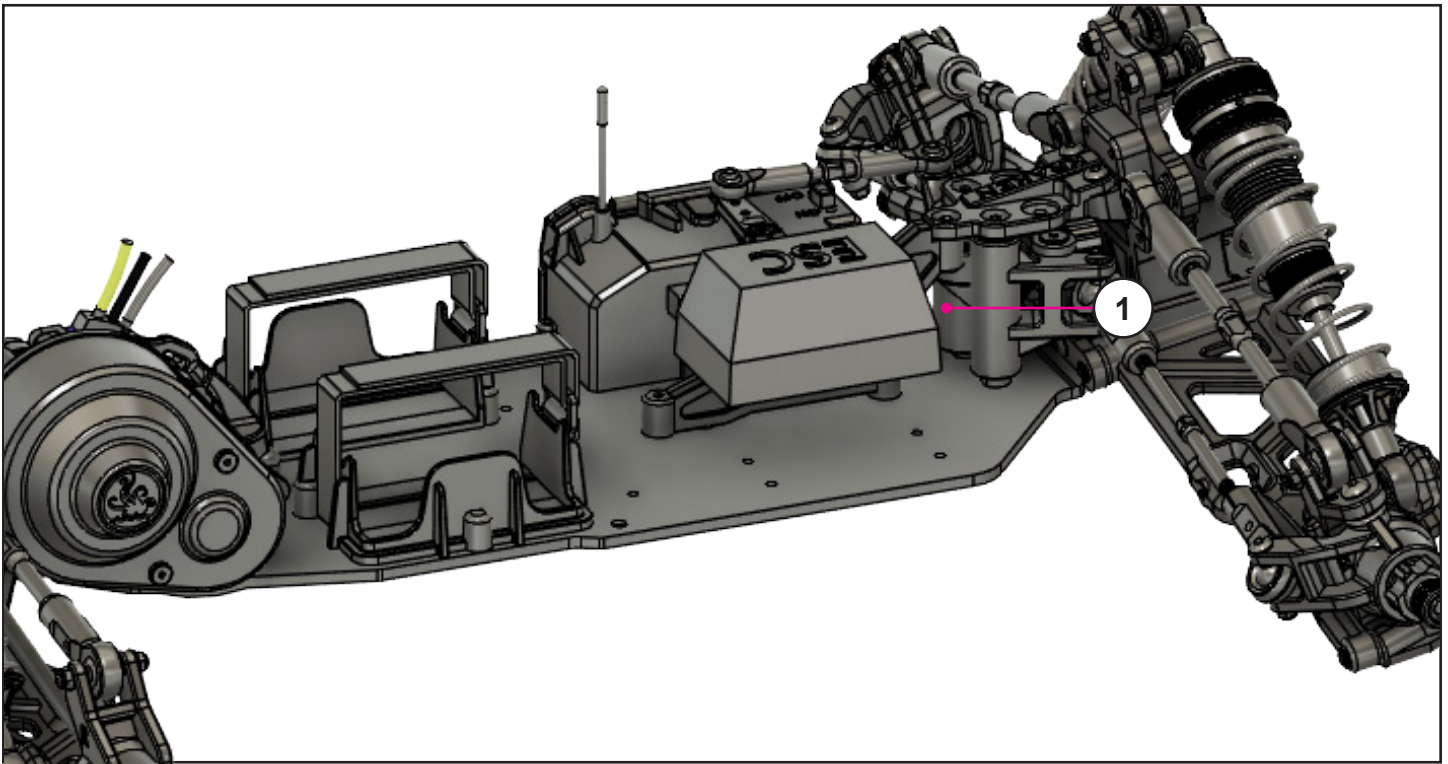

Assembly	Item Number	Name	Quantity
1		Motor ESC Combo	1
2		Mini Zip Ties (2x60mm) Or Cut if longer	2

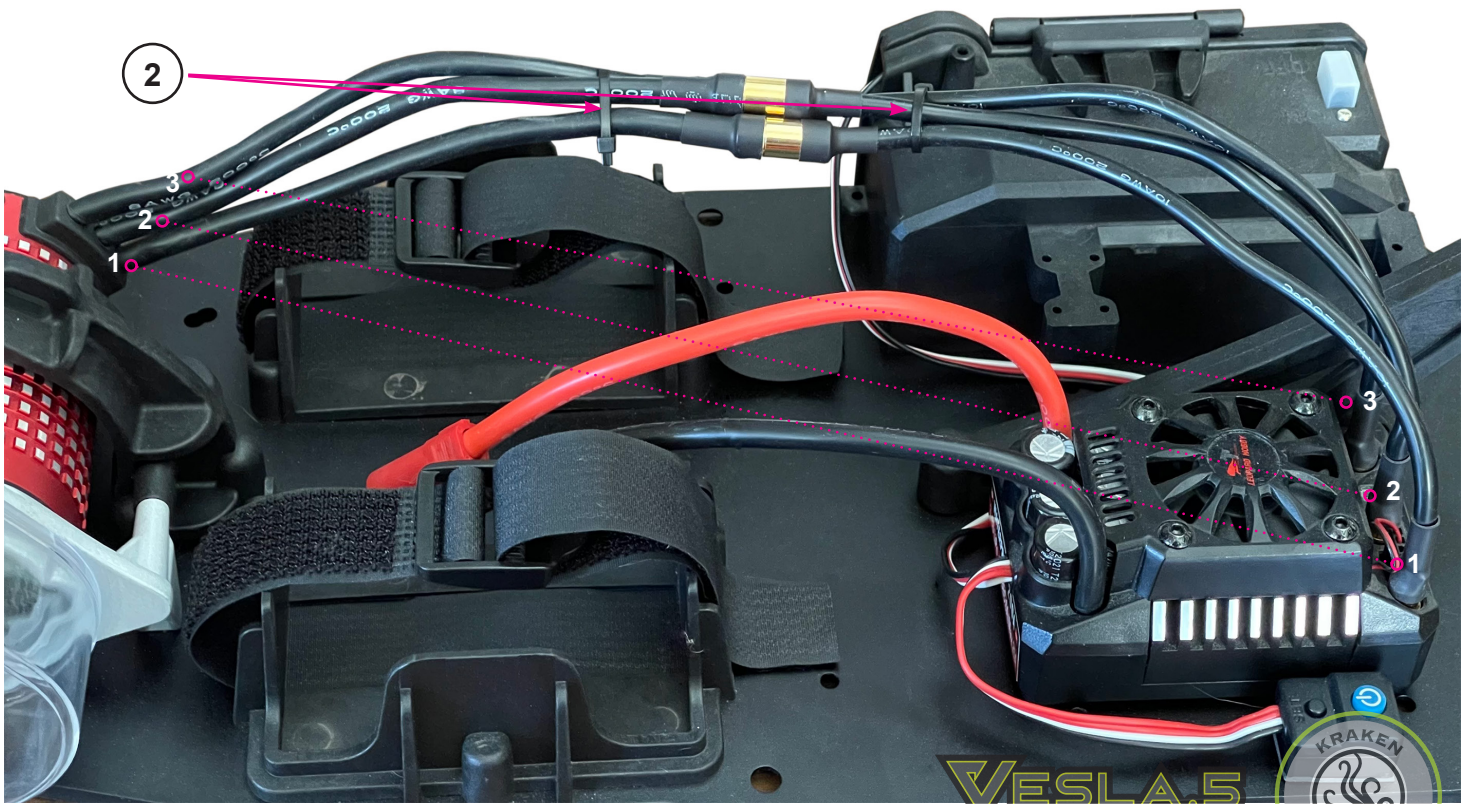

VESLA.5

