

# VEKTA-5<sup>®</sup>

CLASS 1500 UNLIMITED BUGGY



KV7701/2



INSTRUCTION MANUAL

### DISCLAIMER

All information on this document is subject to change at the sole discretion of Kraken RC, Inc. For up-to-date product information, please visit [krakenrc.com](http://krakenrc.com) for the latest updates.

 **ATTENTION:** Please read this manual in its entirety and observe applicable suggestions and recommendations. Failure to operate the product correctly may result in damage to the product, personal property and cause serious injury.

**WARNING:** VEKTA.5 is recommended only for professional or advanced RC drivers.

 VEKTA.5 uses a 2 stroke high-capacity engine. Please be advised that the engine may be hot during its operation and all caution should be exercised for safety reasons.

 Failure to follow all instructions can lead to damage to your vehicle, property damage and bodily injury or death.

**CAUTION:** Making modifications to your car not specified in this manual may void the warranty and cause your vehicle to malfunction.

VEKTA.5 is a remote control vehicle operated by radio frequencies. Please be aware of radio interference in your area or you may lose reception. Always be aware of your surroundings while driving VEKTA.5. We highly recommend using a Kill Switch which can be purchased from [Davesmotors.com](http://Davesmotors.com). A Kill Switch will allow you to "kill" your engine remotely should you lose control of the vehicle.

- Never run your vehicle on the street where people are present
- Exercise common sense when using gasoline. Keep away from children
- Invest in a Kill Switch.
- VEKTA.5 battery box is not waterproof, avoid running in water
- Never run your vehicle with low transmitter batteries
- Invest in a high quality radio transmitter and batteries
- Always turn off engine first, then receiver, then transmitter
- Inspect your vehicle after each run and perform maintenance on the vehicle when necessary



### **KRAKEN RC LIMITED WARRANTY (USA)**

VEKTA.5 is warranted to be free of defects in material and workmanship. This warranty does not cover damage due to normal wear and tear, user error of assembly, installation, user modifications and after-market hop ups used. This warranty is not transferable. Kraken RC will, at our discretion, repair or replace products or parts, provided our inspection indicates that an original defect exists. Kraken RC reserves the right to replace any product or part which is no longer available with a product of comparable value and function. If Kraken RC determines that the repairs or replacements are not covered under warranty guidelines, there could be a charge applied for repair and return shipping charges.

### **International Customers Warranty**

Please return product to your local dealer where the purchase was made. Kraken RC assumes no responsibility for Kraken RC products sold internationally by online retailers.

### **THANK YOU!**

Kraken RC would like to thank you for purchasing the VEKTA.5. Only through hard work, great investments, and time were we able to bring this vehicle into reality. The VEKTA.5 is the product of our passion and joy for our RC hobby and we are so grateful to be able to share our dream with you. We wish you many hours of fun and hope that the VEKTA.5 brings you miles of smiles.

Happy Bashing!

Team Kraken

## TABLE OF CONTENTS

<b>INTRODUCTION</b>	<b>5</b>
<b>HOW TO INSTALL ENGINE</b>	<b>6 . 7</b>
<b>BATTERY &amp; RECEIVER INSTALLATION</b>	<b>8</b>
<b>ADJUSTING STEERING AND THROTTLE TRIMS</b>	<b>9</b>
<b>FUEL MIXTURE AND FUELING</b>	<b>10</b>
<b>HOW TO START THE CAR</b>	<b>11</b>
<b>PRE-RUN CHECK UP</b>	<b>12</b>
<b>BASIC MAINTENANCE</b>	<b>13</b>
<b>SHOCKS MAINTENANCE</b>	<b>14 . 15 . 16</b>
<b>ADJUSTING FRONT TOE IN AND CAMBER</b>	<b>17</b>
<b>ADJUSTING REAR SOLID AXLE TOE IN AND CAMBER</b>	<b>18</b>
<b>FRONT AND REAR DIFFERENTIAL GEAR MAINTENANCE</b>	<b>19 . 20 . 21</b>
<b>ADJUSTING THE SLIPPER CLUTCH</b>	<b>22</b>
<b>EXPLODED VIEW</b>	<b>27 . 28 . 29</b>
<b>PARTS LIST</b>	<b>27 . 28 . 29</b>





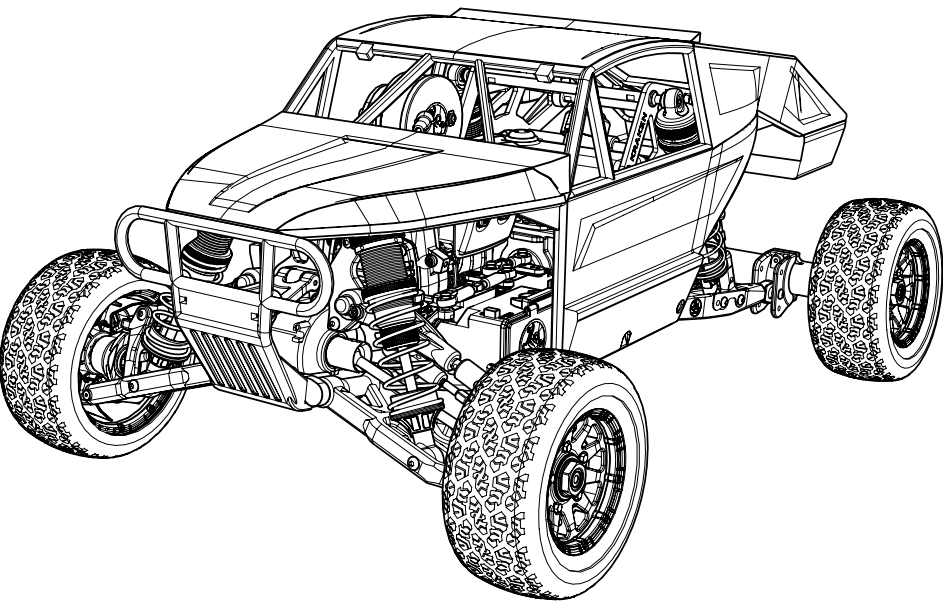

The VEKTA.5 comes in 2 ARTR iterations with 2 servos. You will need a radio transmitter and a battery to complete it. If you choose the KV7701, we recommend using the Zenoah G320RC engine for optimal power and torque.

Parts needed to complete:  
KV7701  
Engine, Radio and Battery.  
KV7702  
Radio and Battery.  
We highly recommend using a 7.4/2s Lipo for our servos.

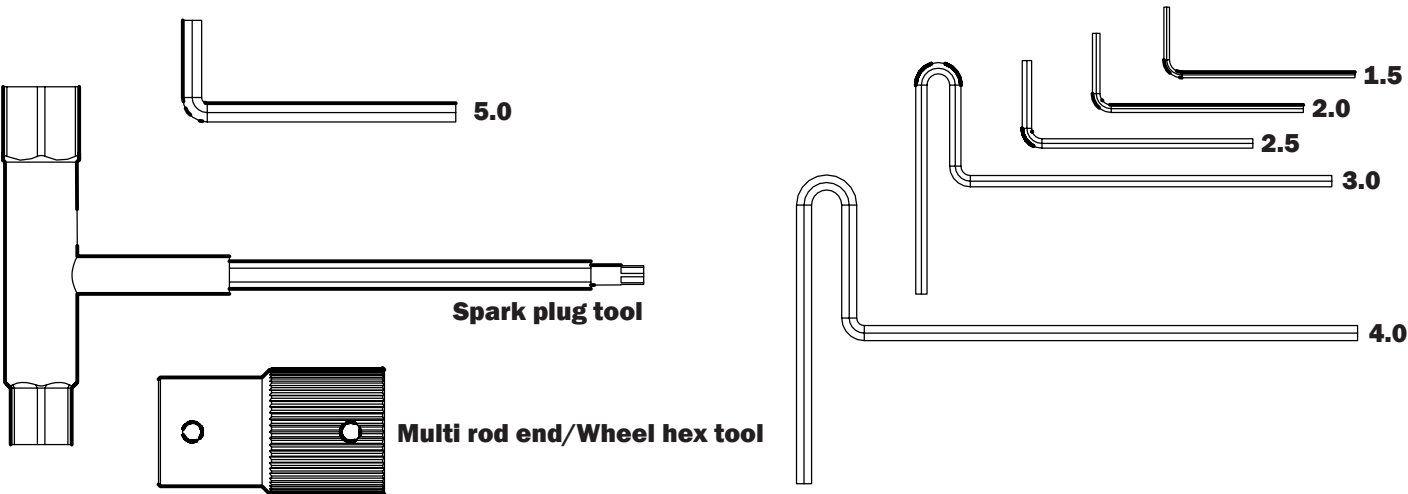
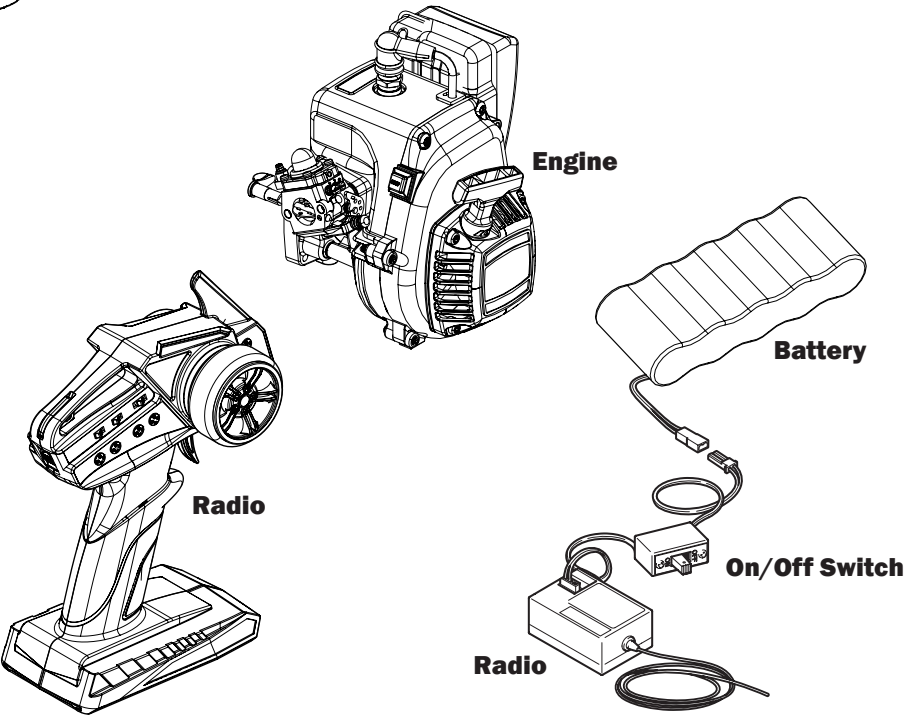



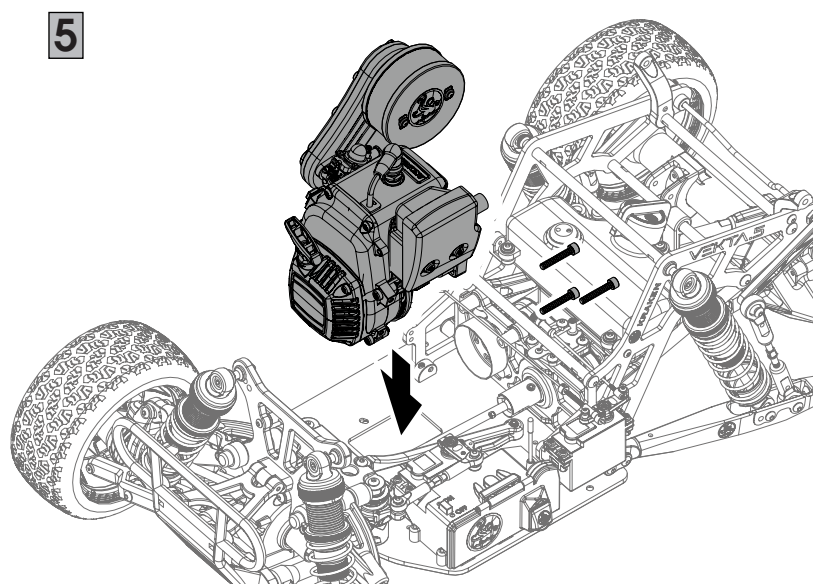
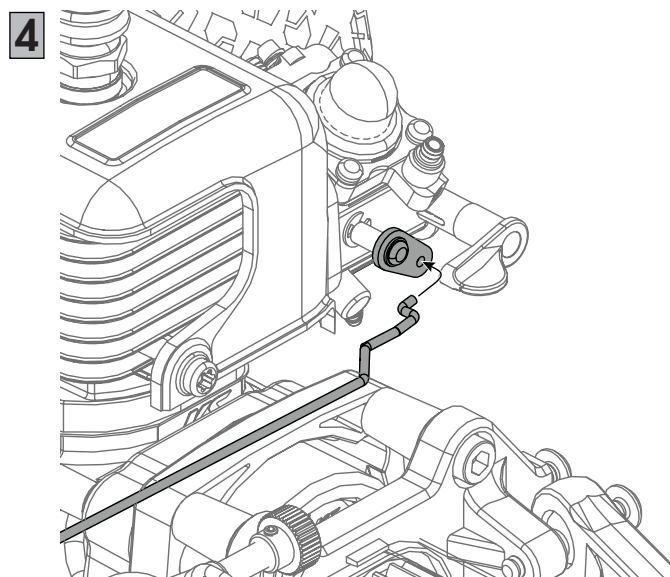
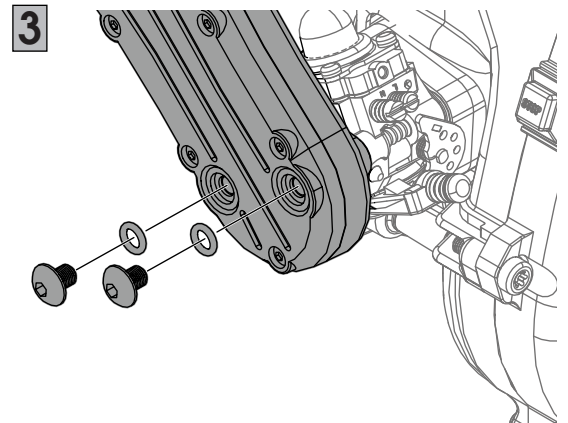
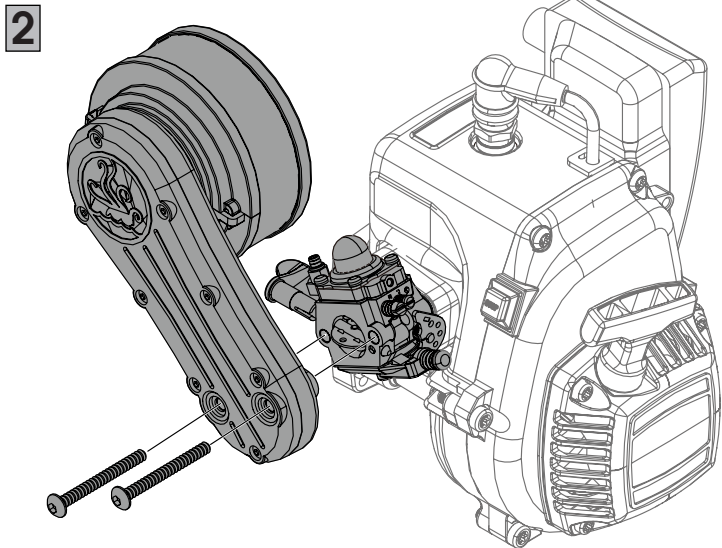
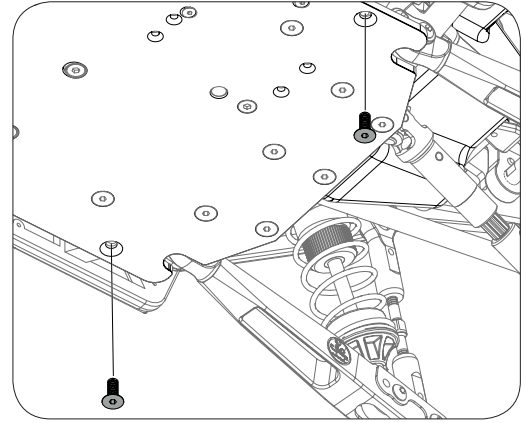
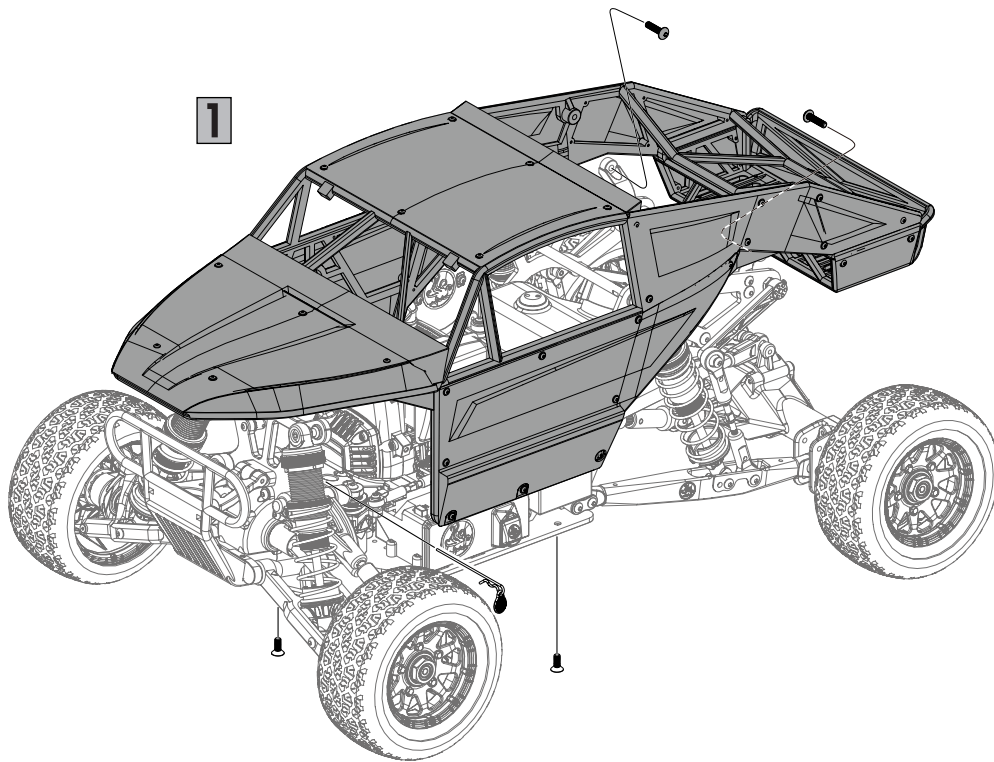

6

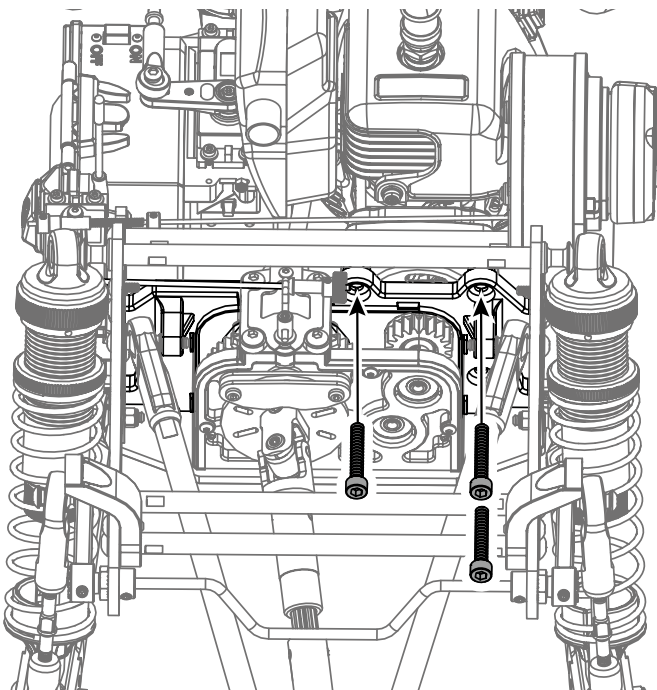

7

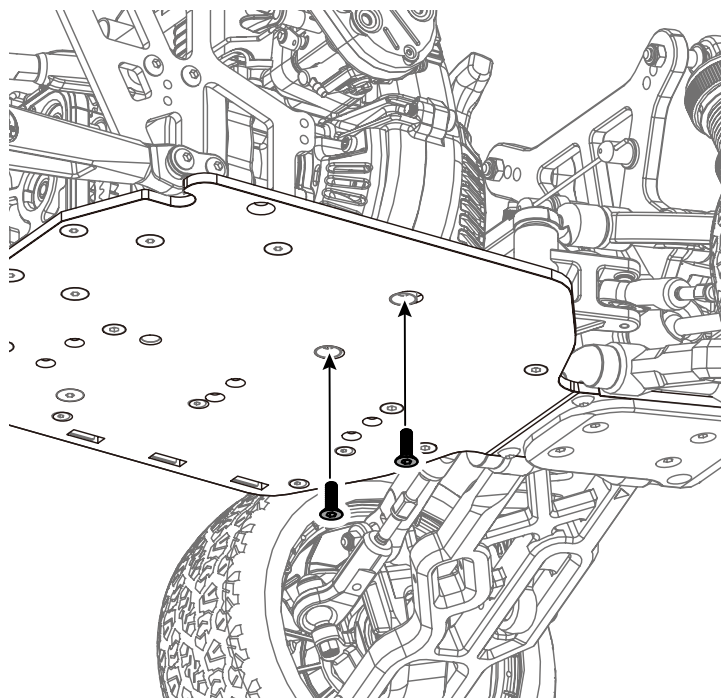

1. Remove roll cage and body from chassis.
2. Install supplied air filter onto the carburetor. Do NOT over tighten screws.
3. Align carburetor in a way that the throttle linkage can be inserted into the hole before bolting down engine.
- 4-6. Use provided screws to finish installing engine using diagrams.

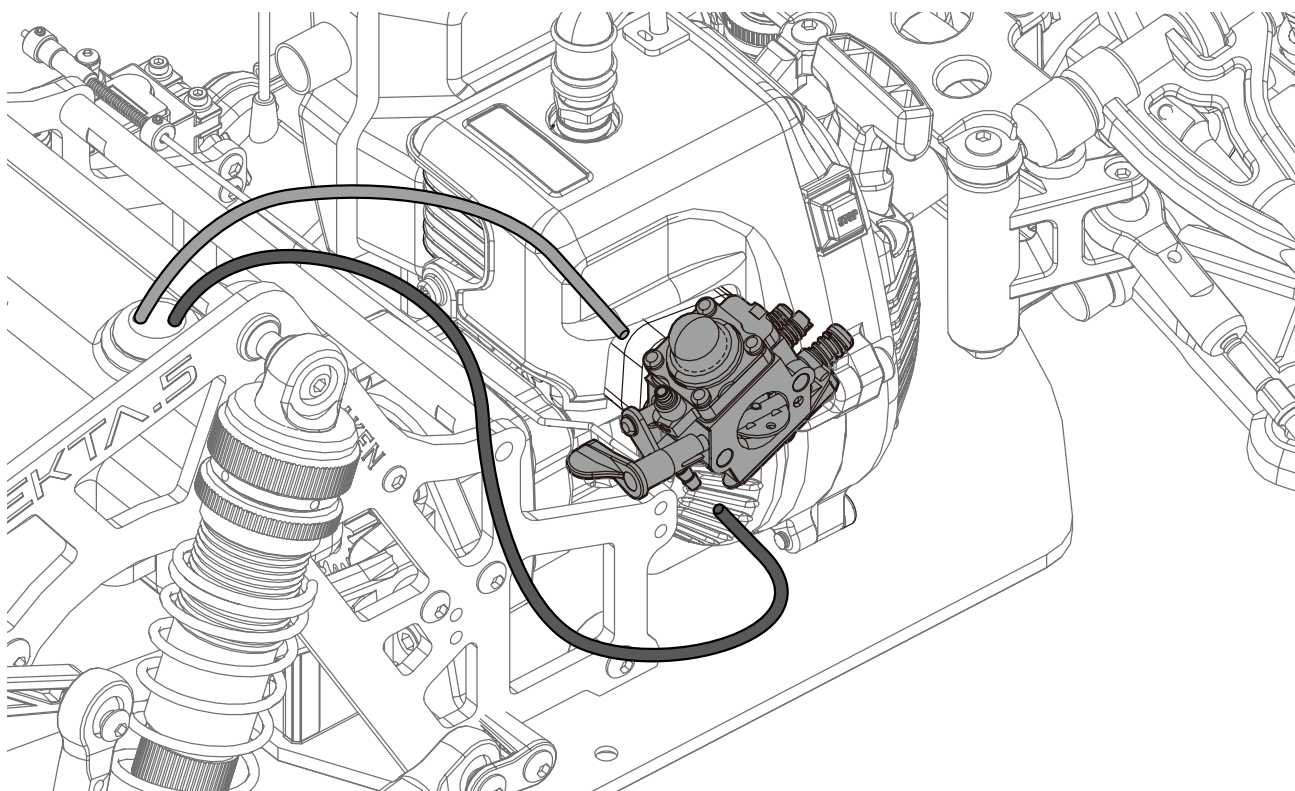

Locate the fuel lines that extend from the fuel tank. The black fuel line and the yellow choke line connect to the bottom and top of the carburetor, respectively. Use diagram for additional help.



## BATTERY & RECEIVER INSTALLATION

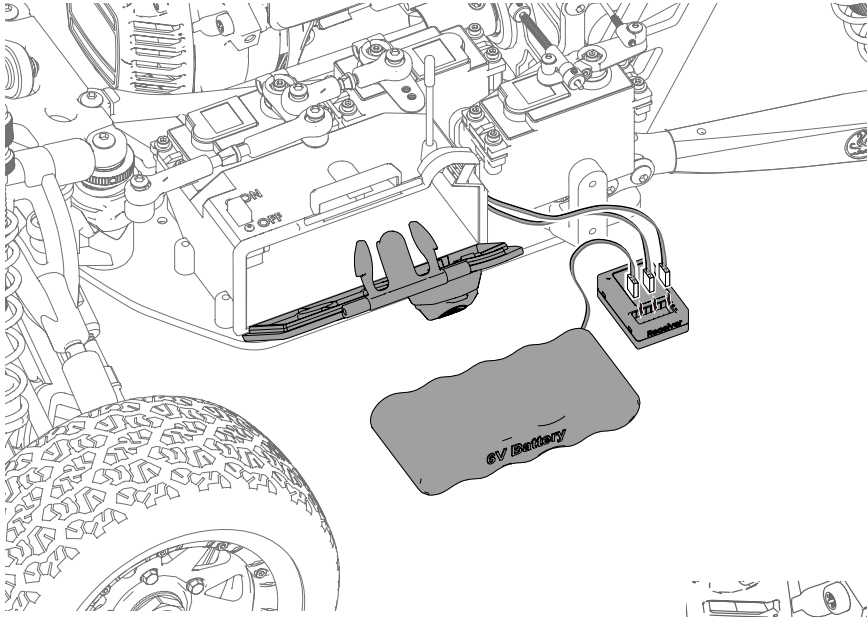

Install your receiver and battery into the battery compartment. Please find an appropriate battery that will fit into the battery compartment. Make sure that your battery is freshly charged. Refer to your battery instruction manual as to how to fully charge your battery. Kraken TS-555HV Servos operation voltage is between 6V-7.4V. To fully take advantage of the TS-555HV Servos, please use a 7.4V 2S LIPO battery. Battery compartment dimension is - L: 120mm W: 51mm H: 47.5mm

Use the supplied grommet for the battery box to secure the servos' wires. Securely fasten the battery compartment using the clip. Please note that the battery compartment is not waterproof. Avoid driving in wet conditions.

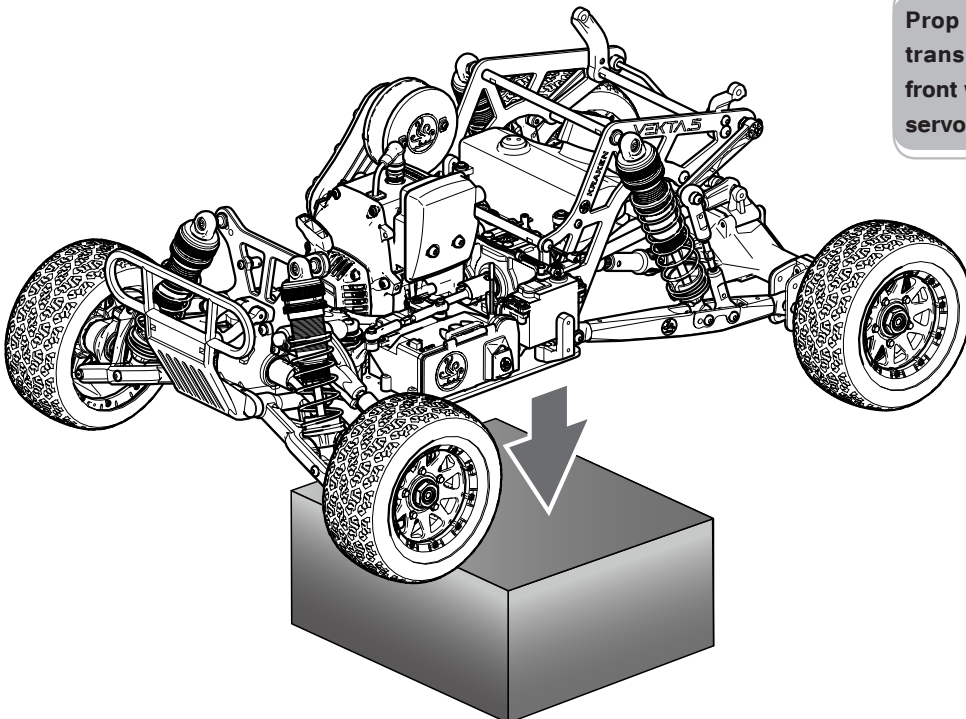
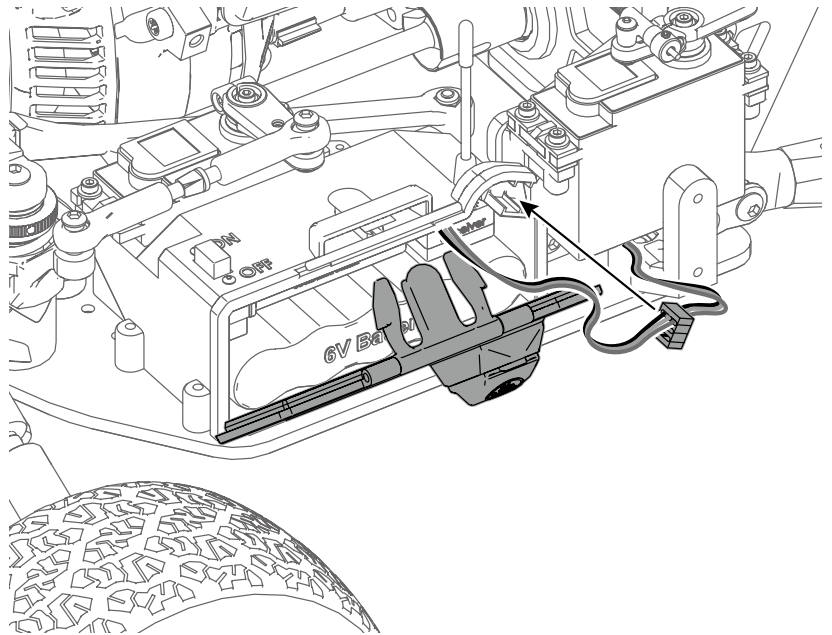

Prop your vehicle on a platform. Turn on the transmitter and receiver. Check to see if the front wheels respond to the steering servo and are centered.

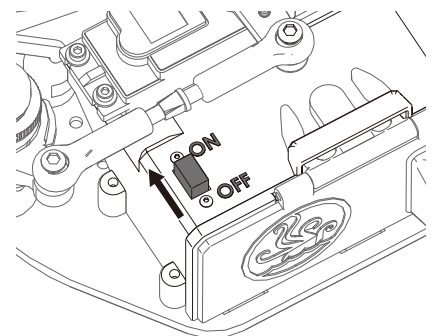

## ADJUSTING STEERING AND THROTTLE TRIMS

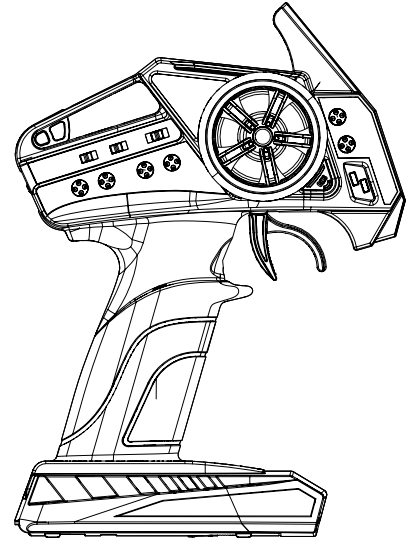
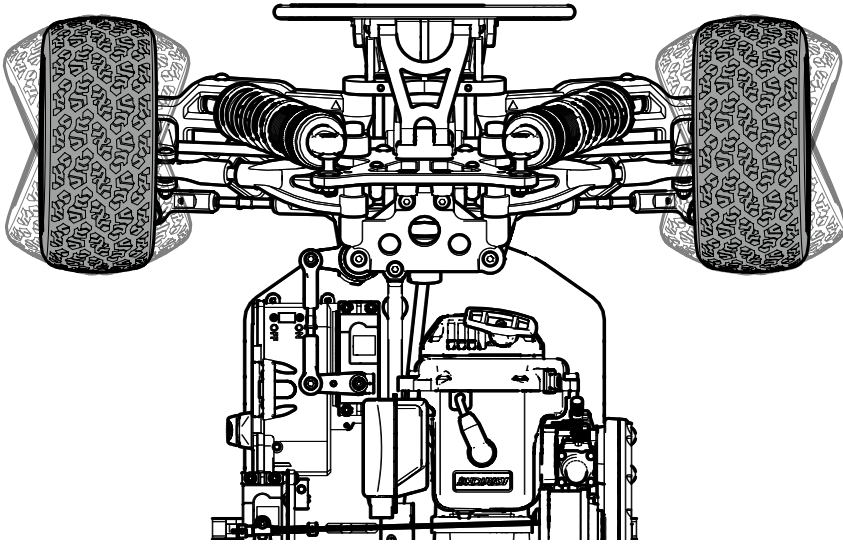

Center the tires by adjusting the steering trim. Use subtrim if necessary (see your transmitter's instruction manual for further direction).

If steering is not in the desired neutral position after binding and steering cannot be centered using trim and subtrim, please follow these tips.

1. Reset trim and subtrim are set to its neutral factory settings.
2. Remove the servo horn and reinstall.
3. Retrim as needed.

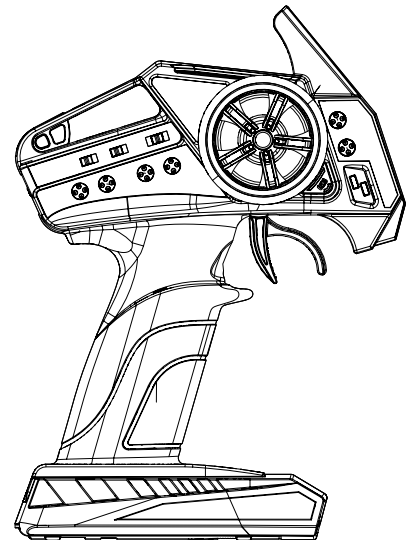
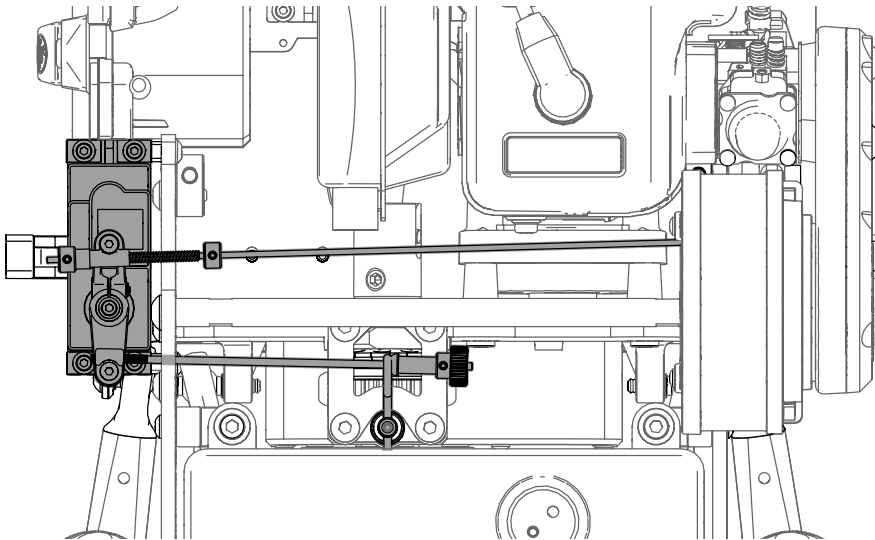

Make sure your receiver and servo are turned on and check that they are in neutral position. Use the diagram above as a guide for the position of the throttle/brake horn. Adjust the throttle linkage as needed to ensure that they are not binding. The brake linkage knob can be adjusted to improve braking conditions. Use your transmitter trim and subtrims to fine tune the adjustments.

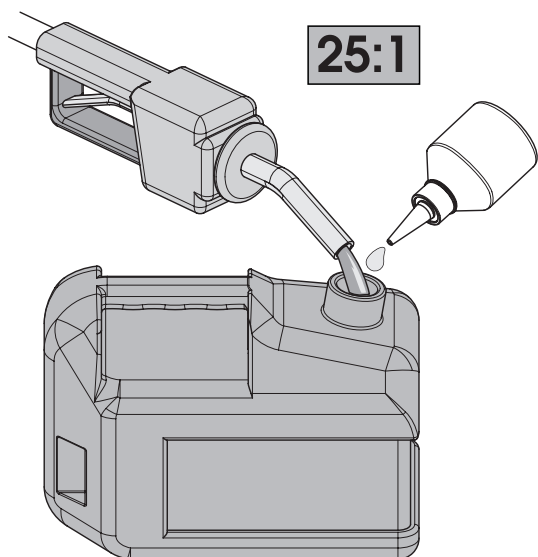

### FUEL MIXTURE

Please use 2 Cycle Engine Oil for your fuel mixture.  
We recommend a gas to oil ratio of 25:1 for the stock Zenoah G320RC.

If you are using after market engines, be sure to contact your manufacturer on the correct mix ratio.

### BASIC FUEL GUIDELINES

Never operate your vehicle near open flames.  
Never smoke while operating your vehicle or while handling fuel.  
Always use caution when handling gasoline.  
Always run your engine in a well ventilated area.  
Model engines produce harmful carbon monoxide fumes.

### PRECAUTIONS AND GUIDELINE FOR FUEL STORAGE

Always observe all warnings and instructions supplied by the fuel provider.

Only use gasoline mixed with 2 cycle engine oil.

Only use premix 2 cycle engine oil. Do NOT use any other kind of oil.

Always mix fuel in a resealable water resistant container made specifically for gasoline.

Always drain your engine after you have finished running your vehicle. Do NOT store your vehicle with fuel in the gas tank.

Never handle model engines until they have had time to cool. They are extremely hot when in use.

Always store fuel in a clearly marked container well away from the reach of children.

Never allow fuel to come into contact with eyes or mouth. Gasoline and other fuels are poisonous.

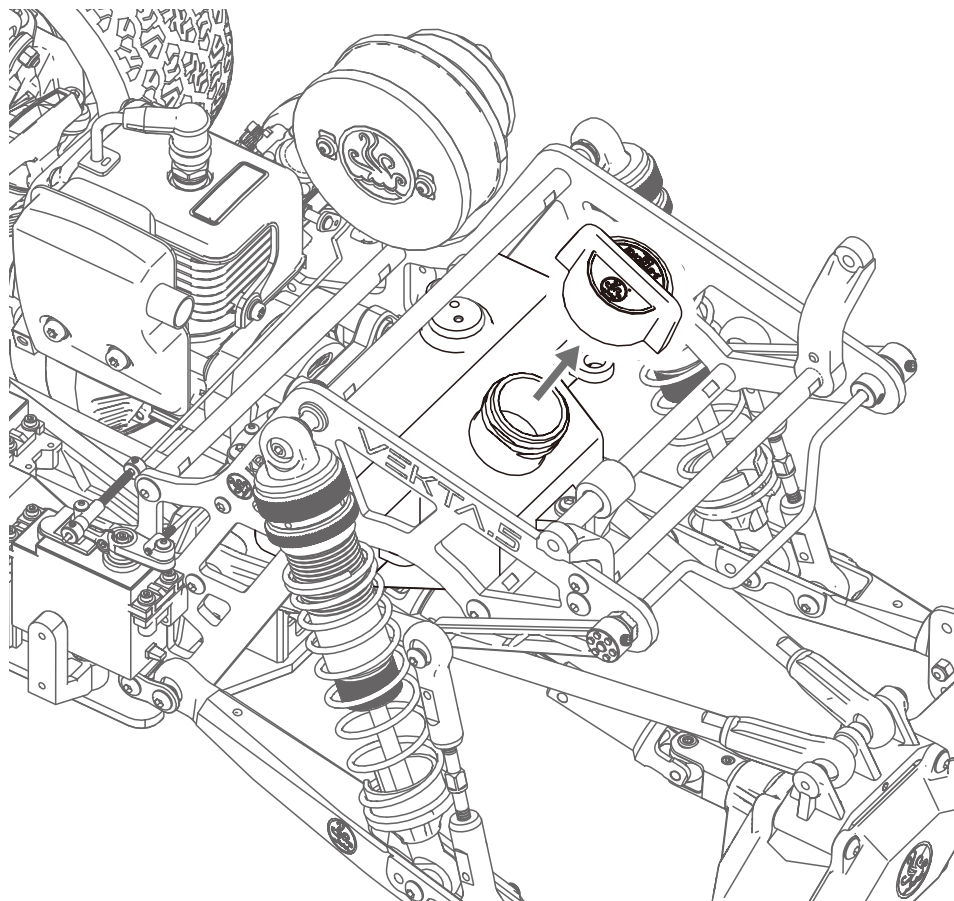

Locate the fuel tank on the back of the vehicle, remove the gas cap and safely pour gas into your fuel tank.

Do not overfill and avoid spilling gas onto your vehicle. When you are done securely attach your gas cap onto your fuel tank.



## HOW TO START THE CAR

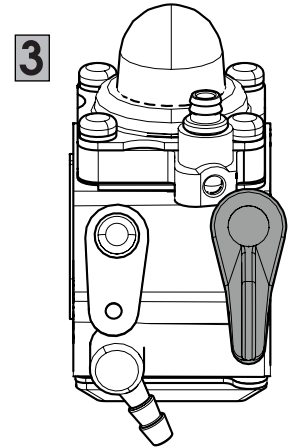
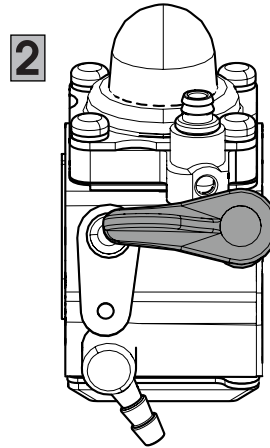
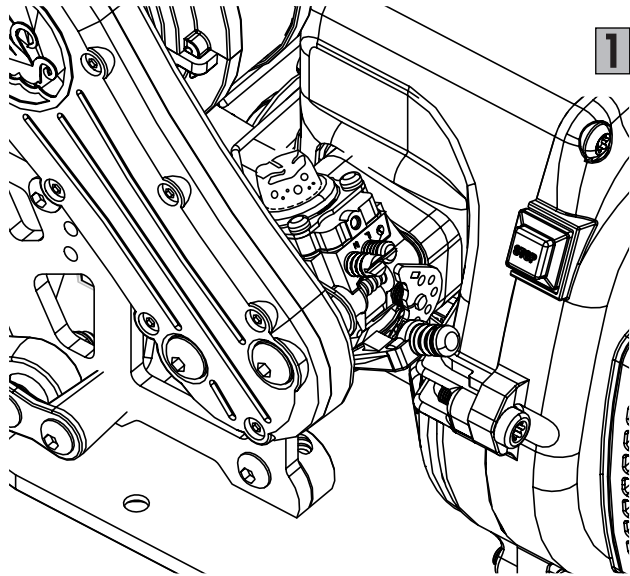

1. Locate your carburetor and prime the bulb
2. Locate the choke lever
3. Activate the choke lever by pushing it to the down position

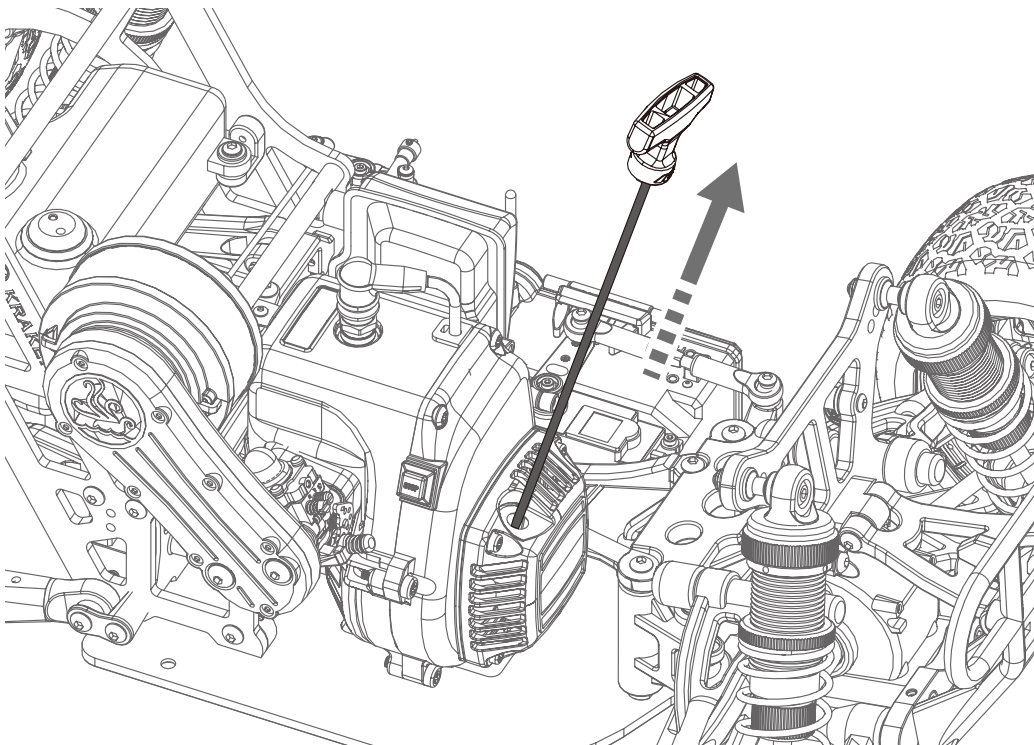

Slowly engage the pullstart and give it a couple of pulls until you hear a "pop" sound. Stop and return the choke lever to its neutral position. Give it a couple more pulls and your engine should fire and start.

**Note:** Avoid drastic and erratic pulling on your pullstart as you may break your pullstart.

### **WARNING:**

The break-in procedures for the 2 stroke motor is extremely important. Please follow the procedures correctly. Failure to do so may cause your engine to fail. Please research professional break-in procedures.



## PRE-RUN CHECK UP

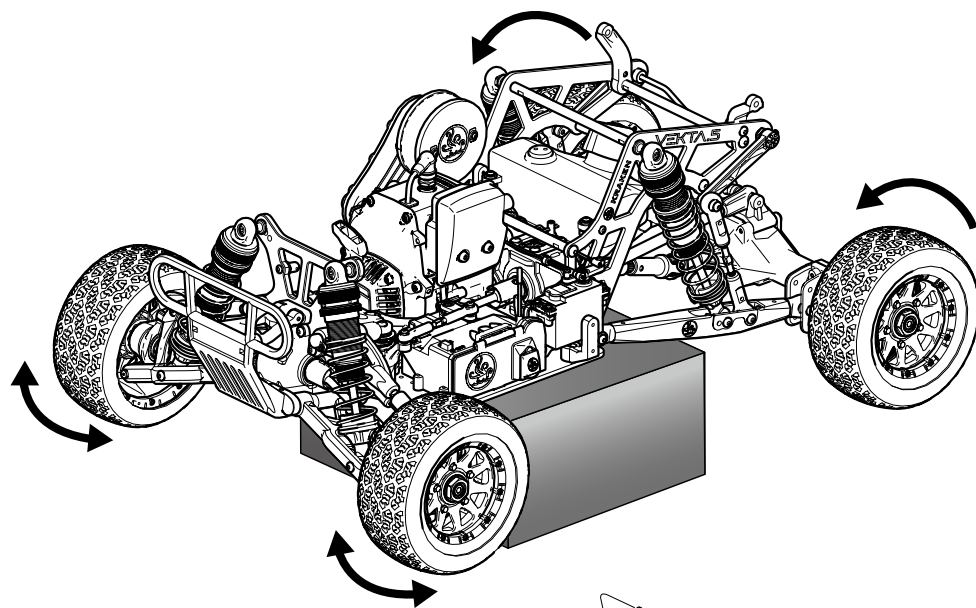

While your vehicle is still on the platform, make sure that your 4WD drivetrain is working properly and there is no binding. Check your brakes and make sure that they are working. If you feel that the vehicle is not operating correctly, do not run the vehicle. Stop the engine and inspect the vehicle.

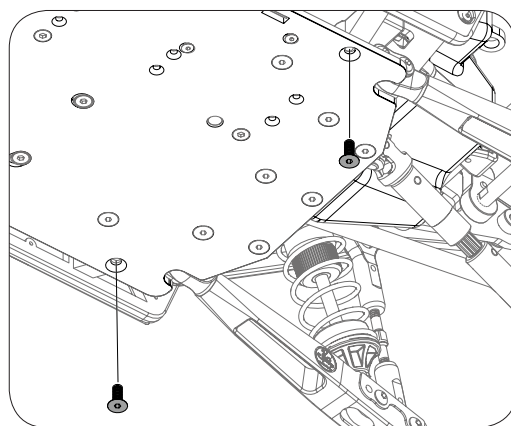
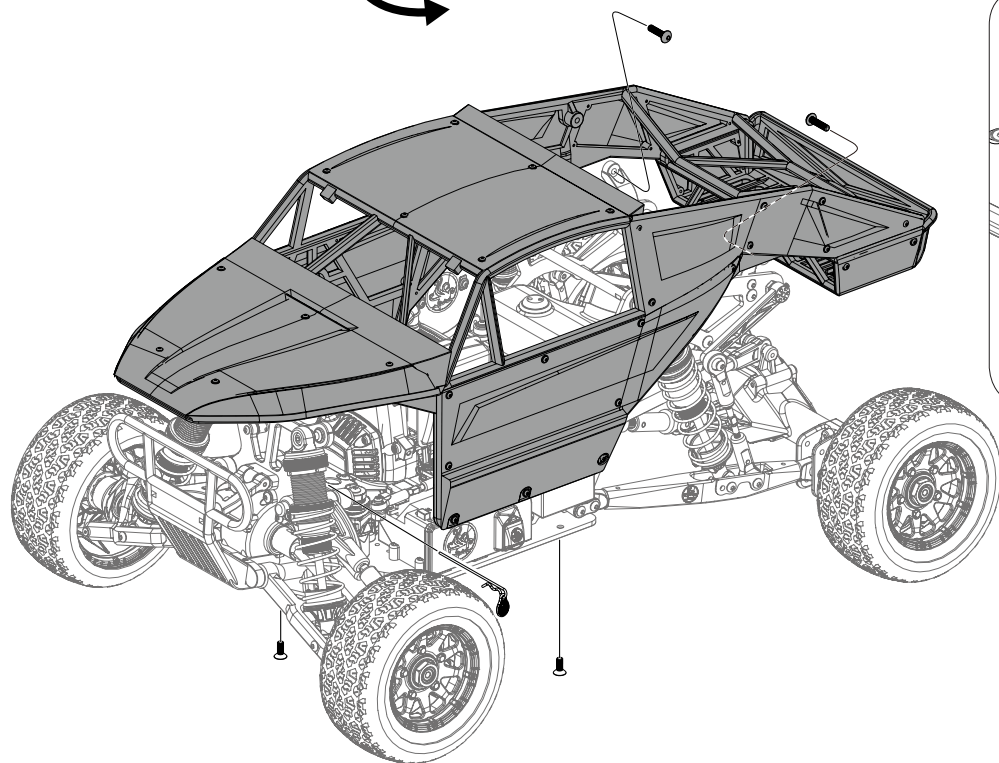

When you feel that your vehicle is ready, you can now go for a test drive. Observe the break in procedures for your engine. Break in the engine by driving slowly for the first half tank of fuel (about 25 minutes).

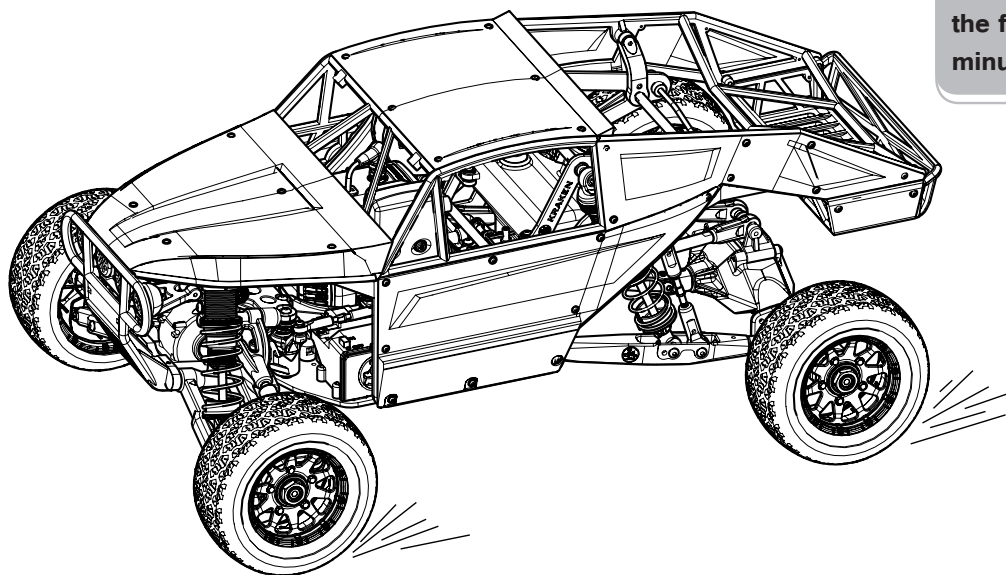

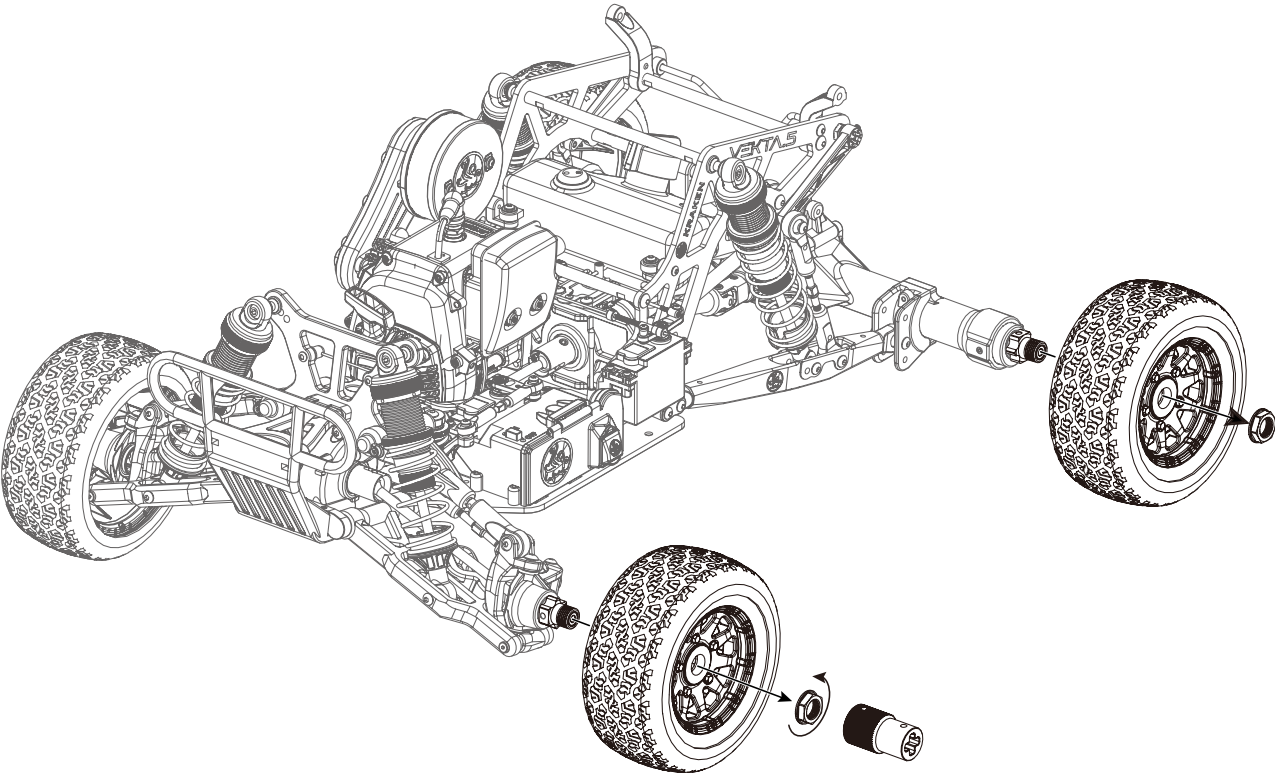
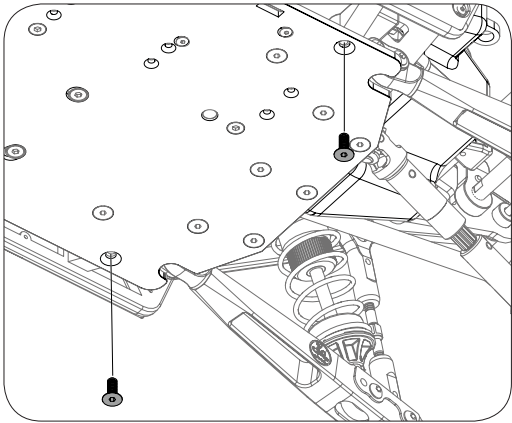
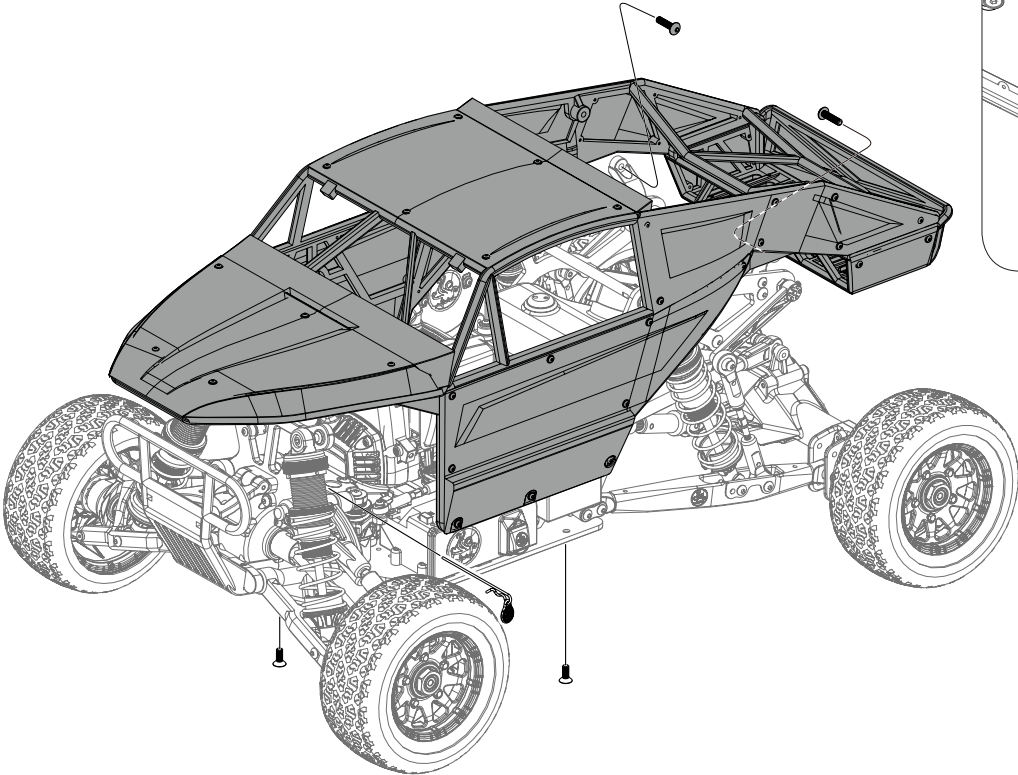



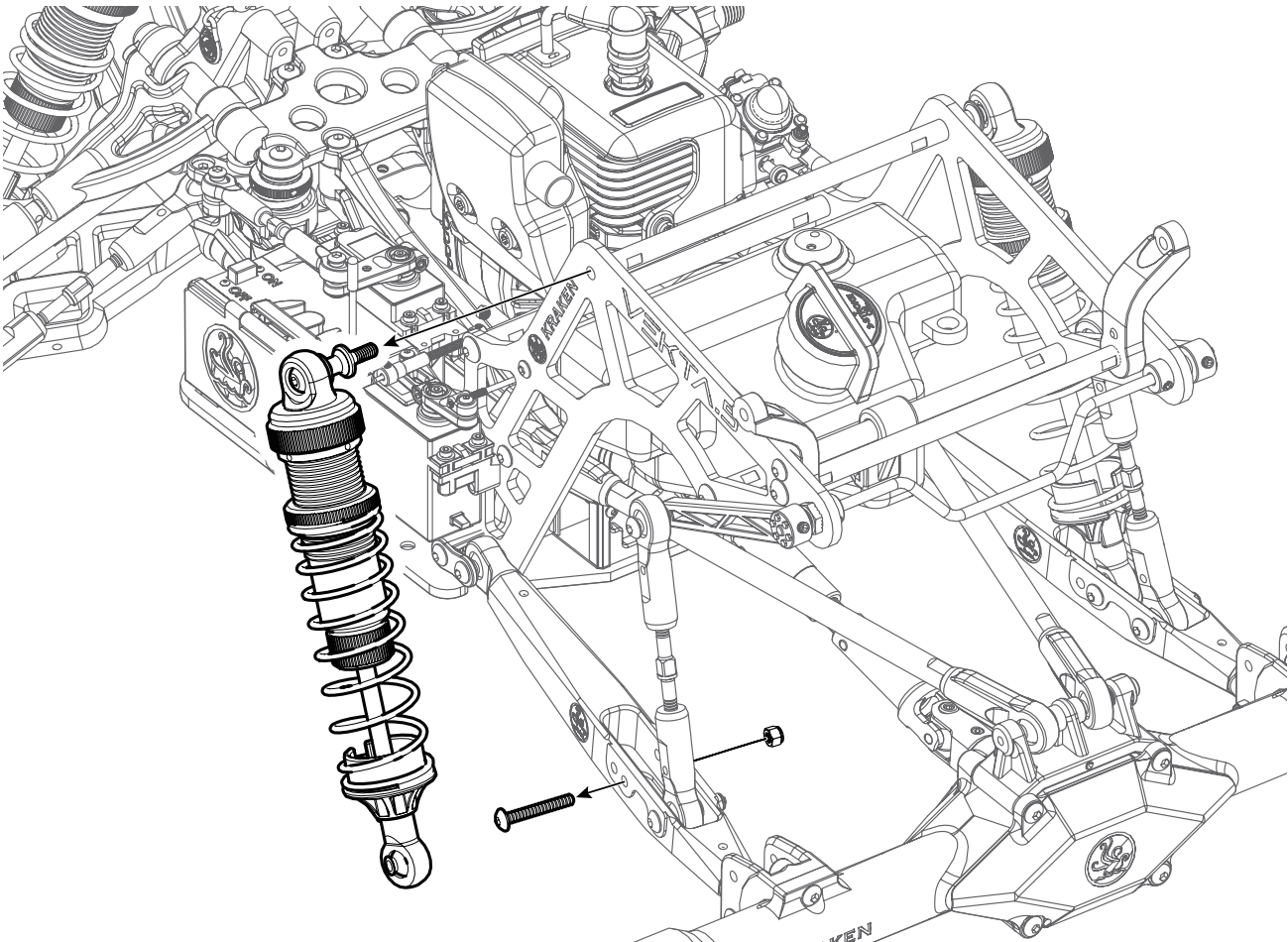
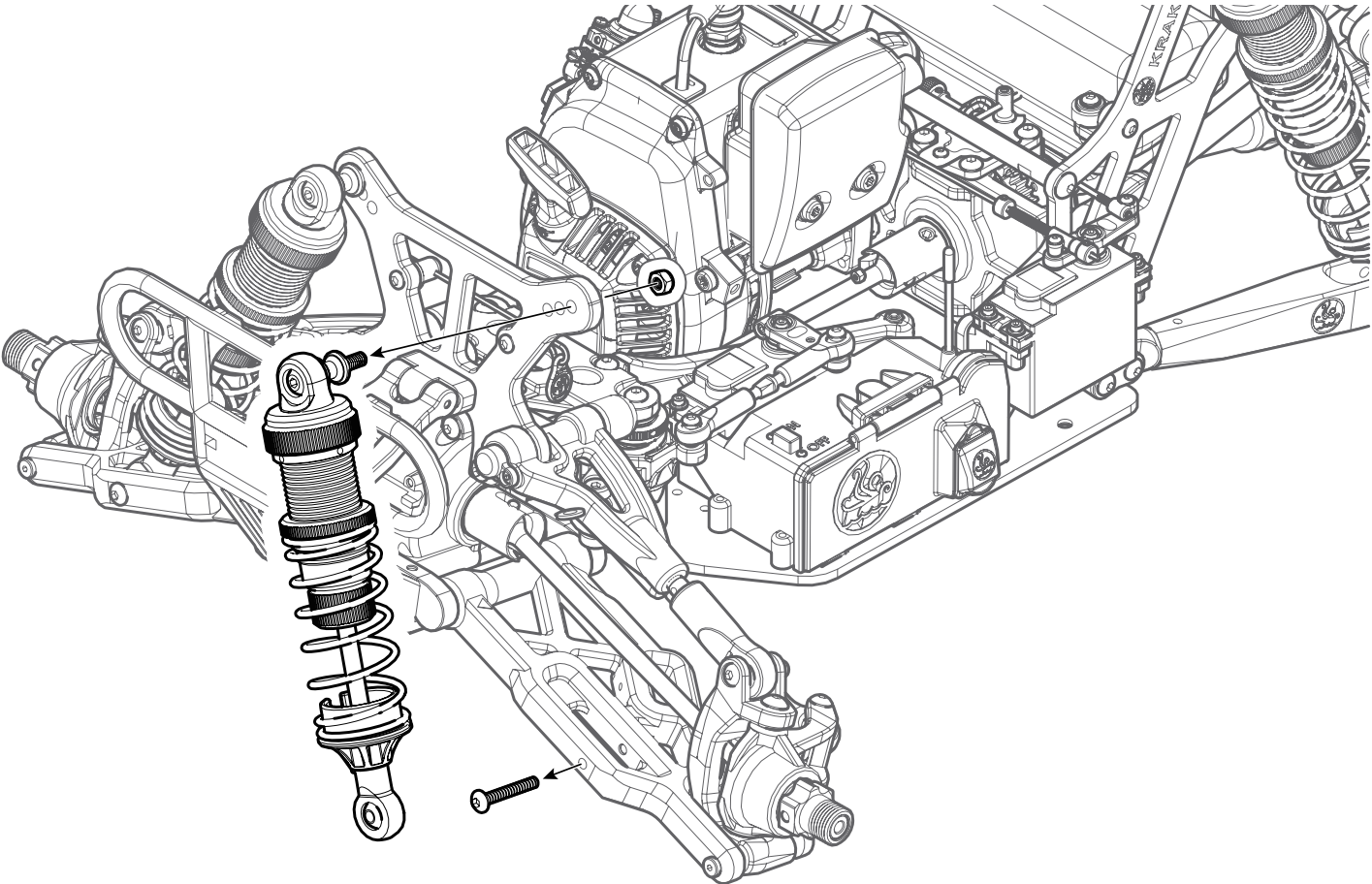

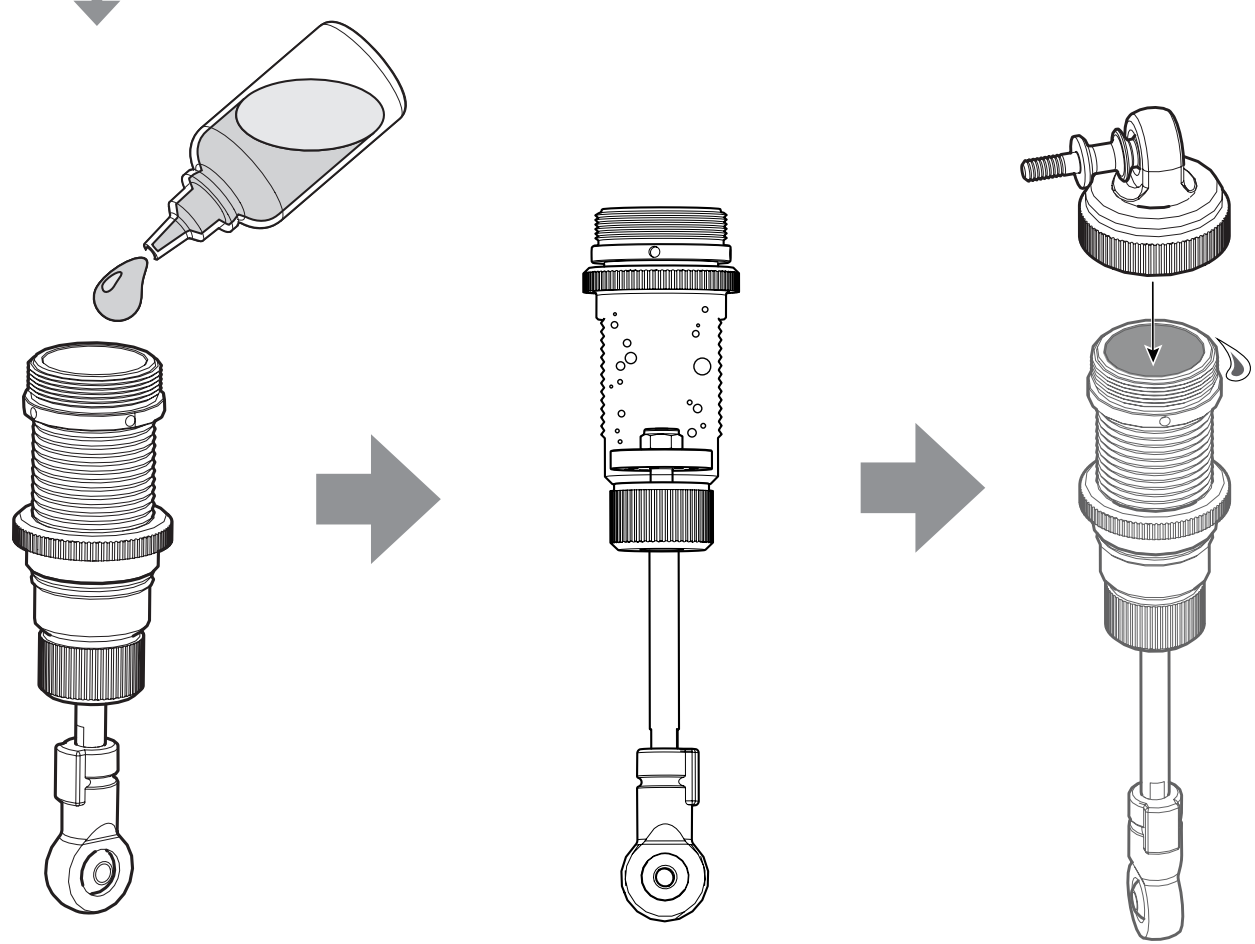
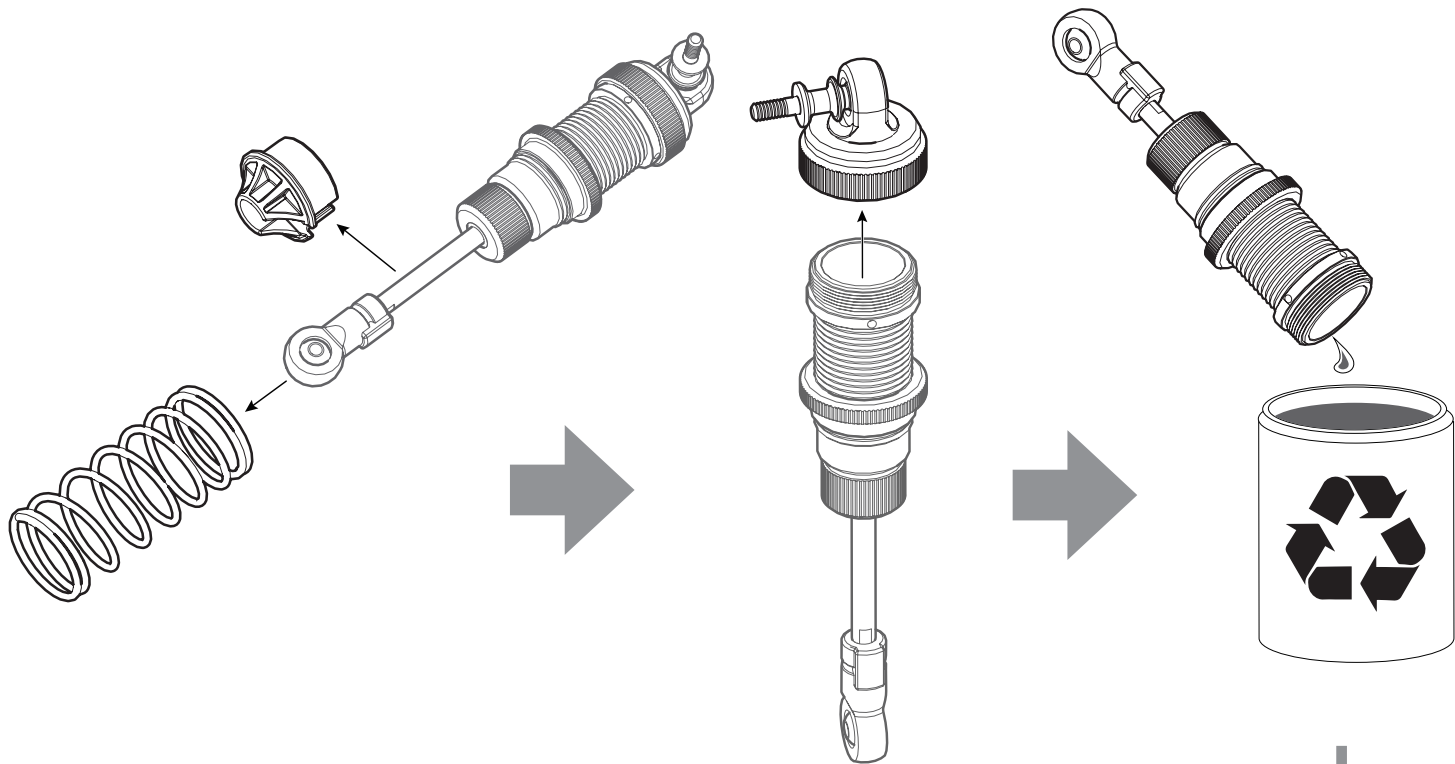



## FRONT ASSEMBLY

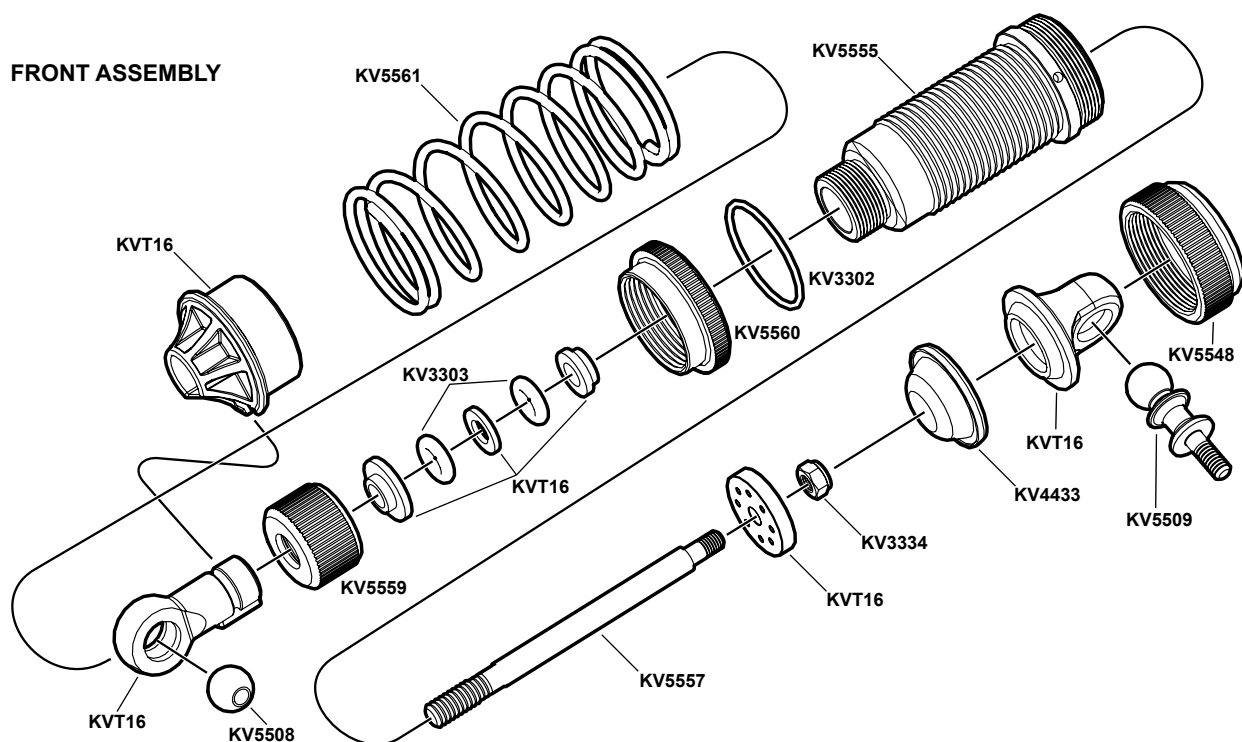

## REAR ASSEMBLY

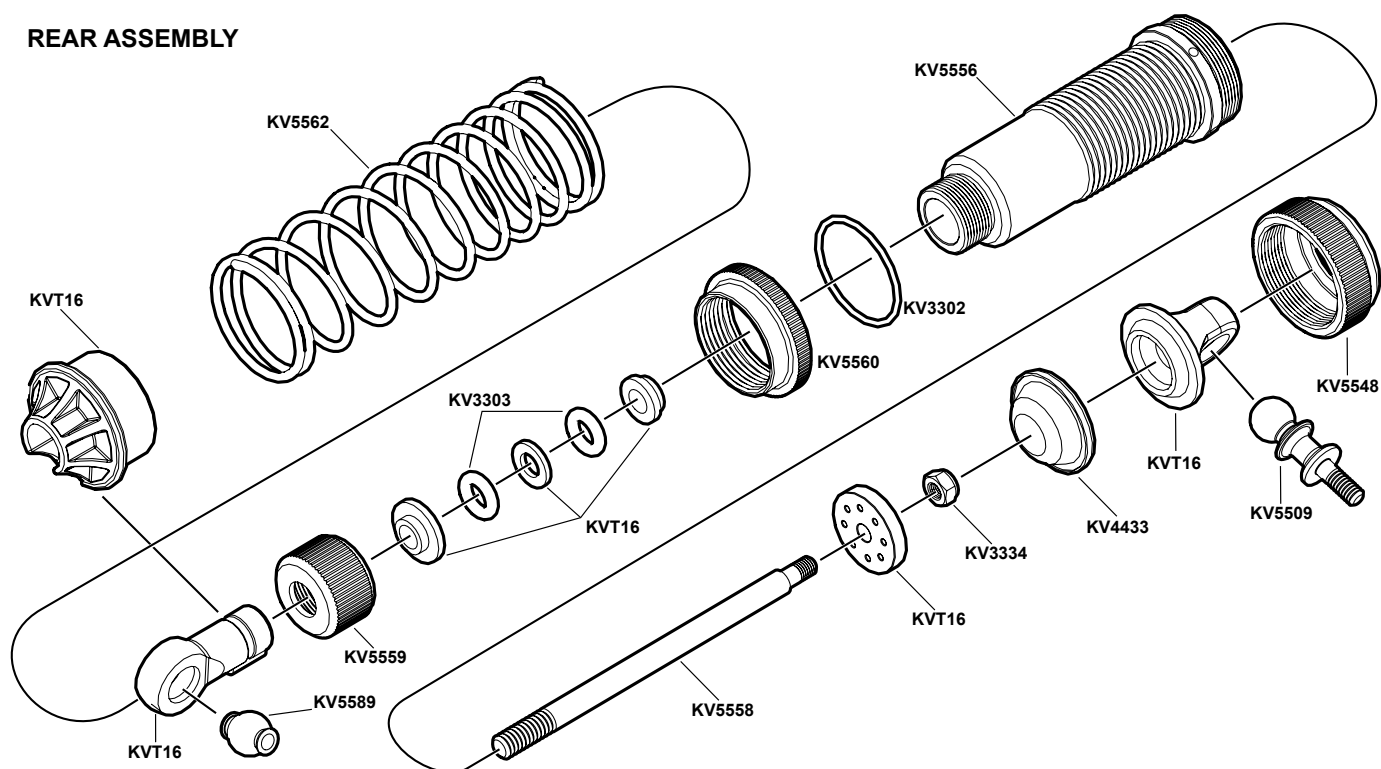

ADJUSTING FRONT TOE IN AND CAMBER

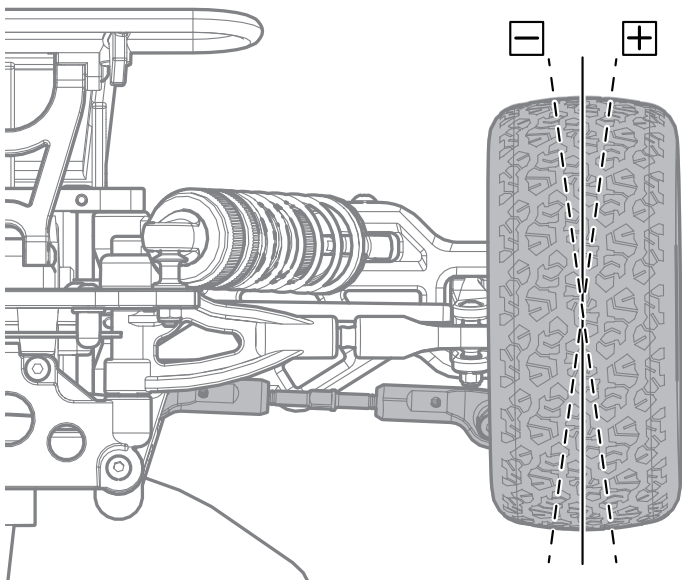
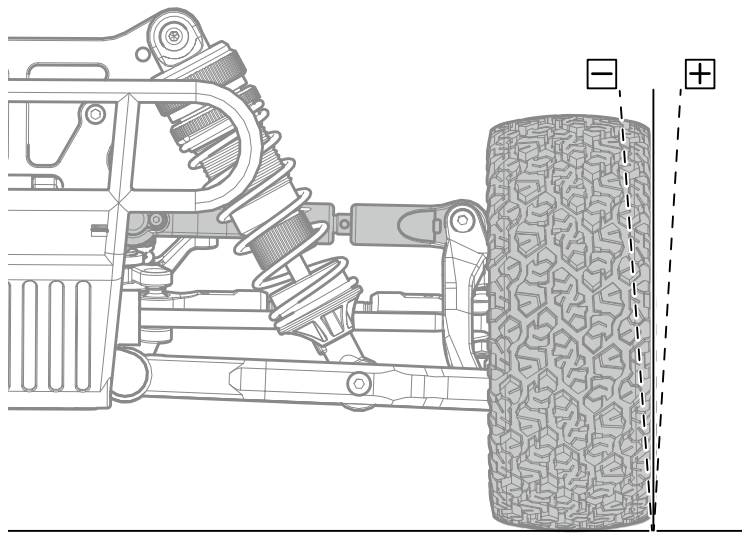
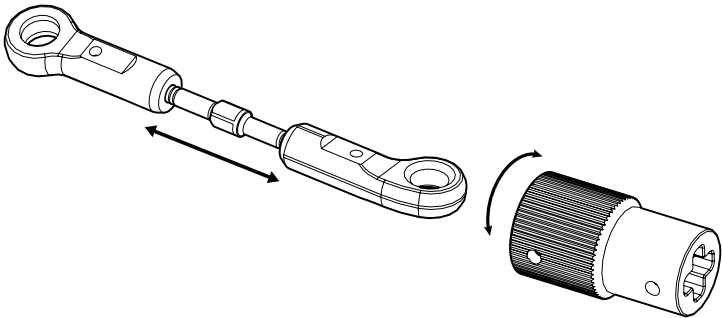
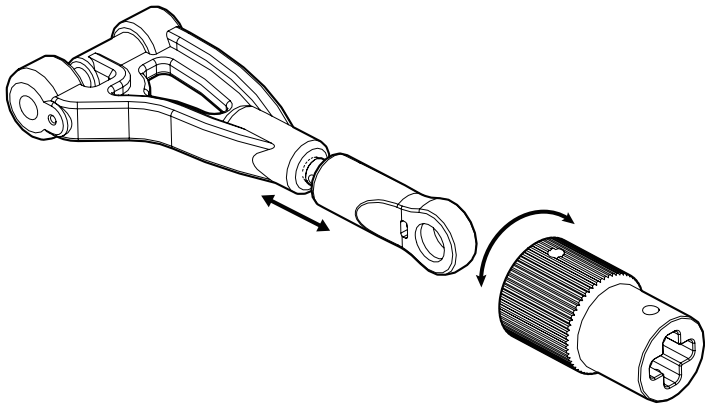
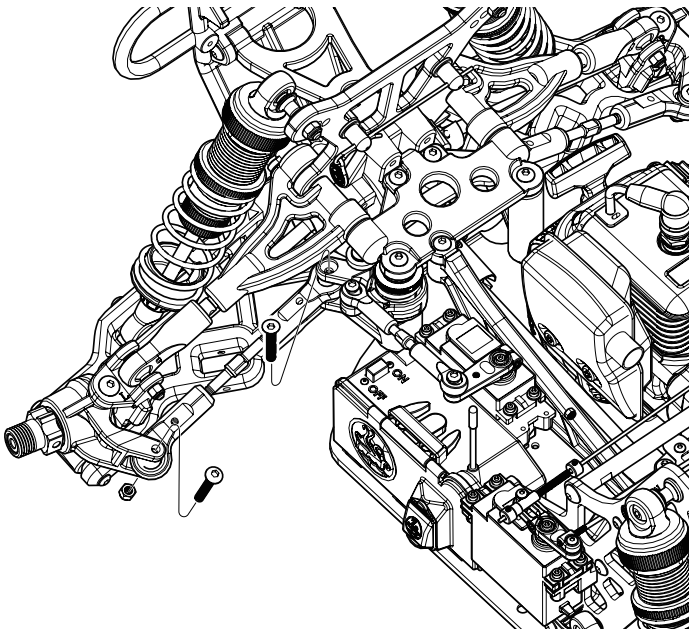
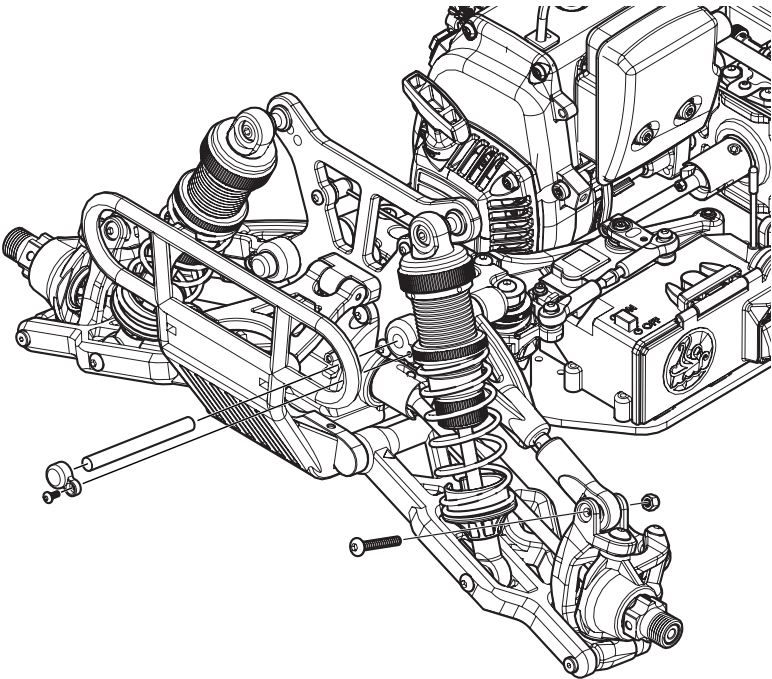

ADJUSTING REAR SOLID AXLE TOE IN AND CAMBER

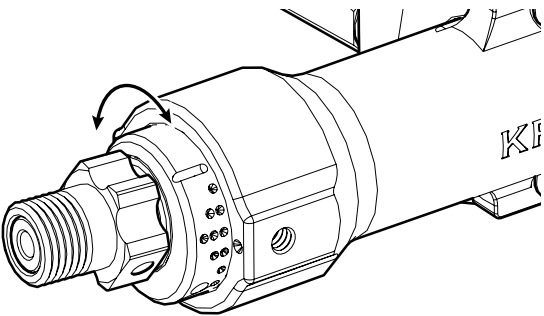
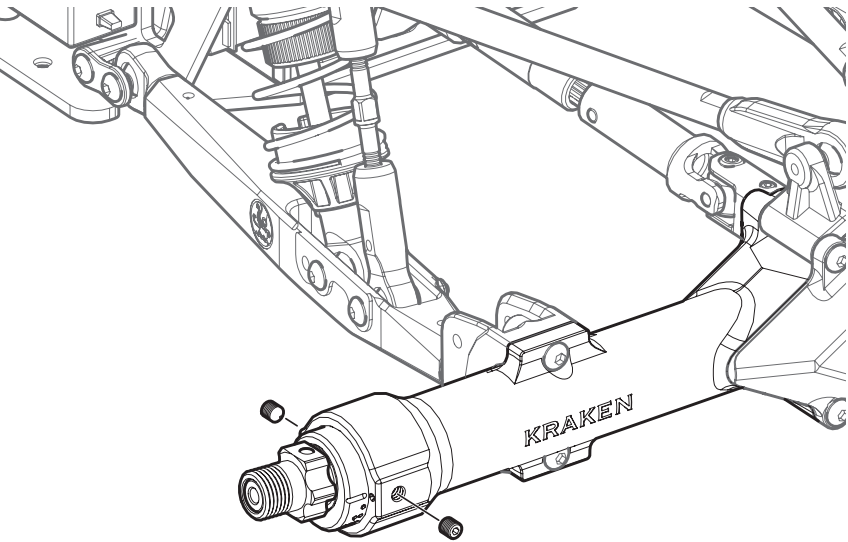

	Left	Right	TOE-IN		CAMBER	
1.			0°	—	3.5°	+
2.			1°	↓	3.4°	↑
3.			1.5°		3.0°	
4.			2.5°		2.5°	
5.			3.0°		1.5°	
6.			3.4°	↓	1°	↑
7.			3.5°	+	0°	—

The VEKTA.5's rear solid axle offers a unique type of adjustments. Unlike other rear solid axle which is fixed, the VEKTA.5 enables you to adjust your toe-ins and camber all at the same time. Please observe the chart above to adjust the settings.

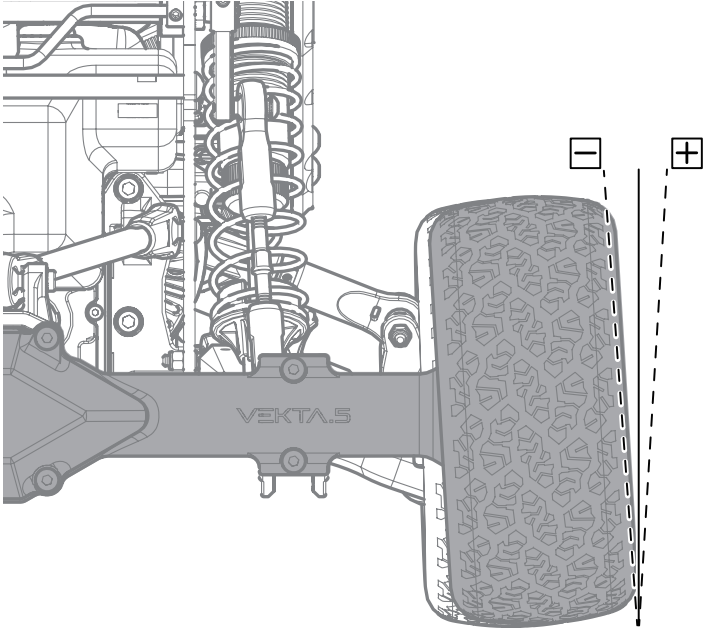
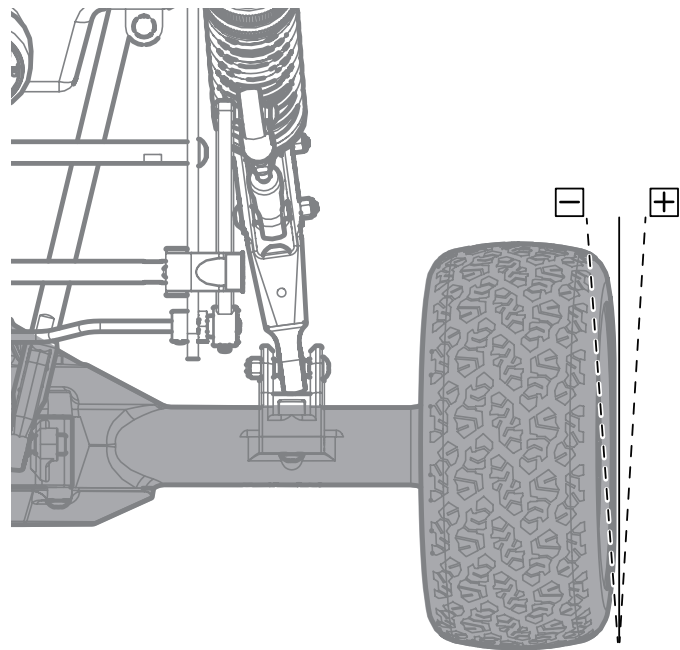



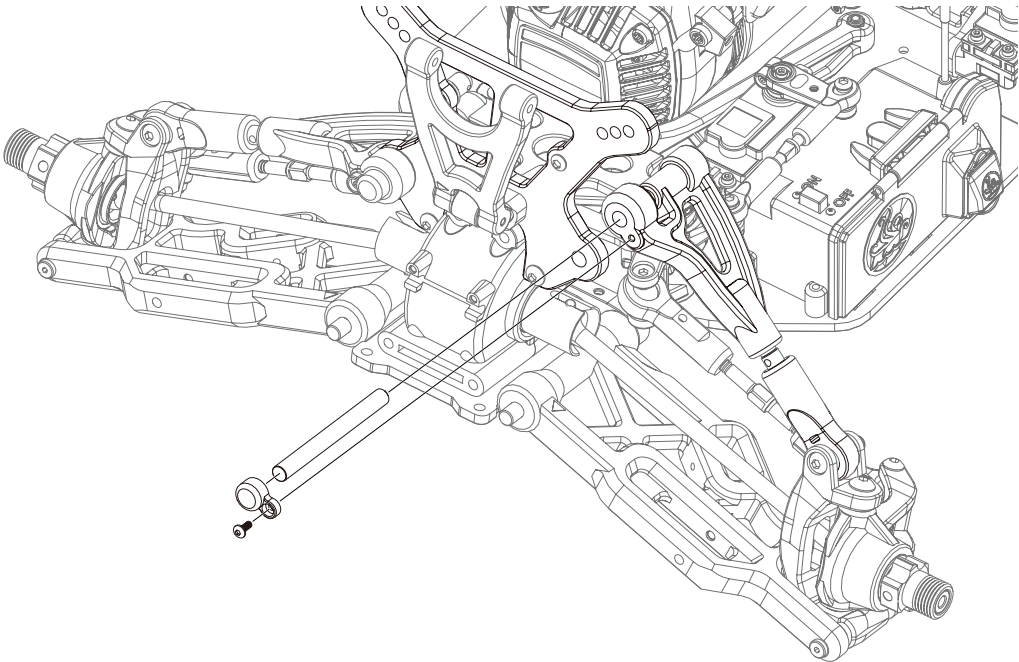
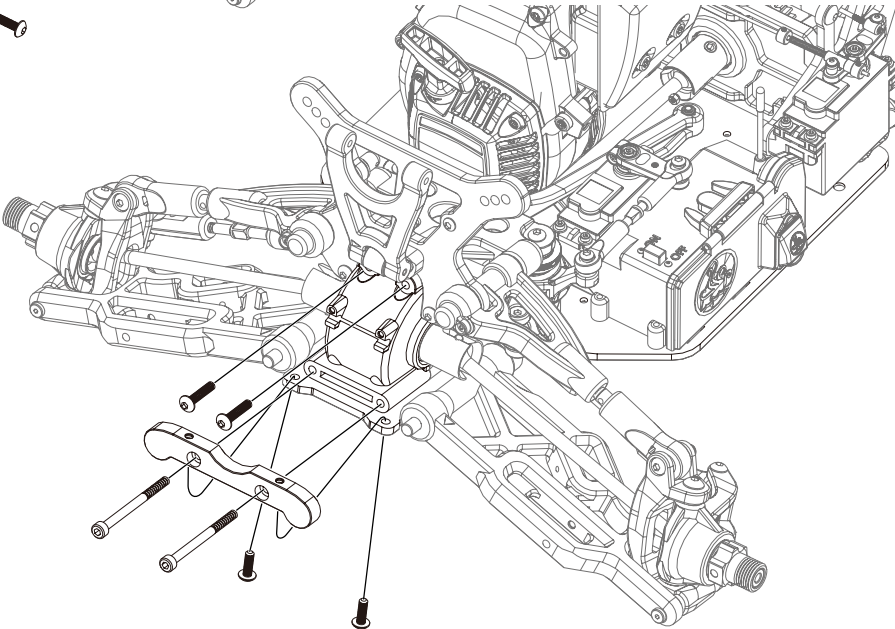
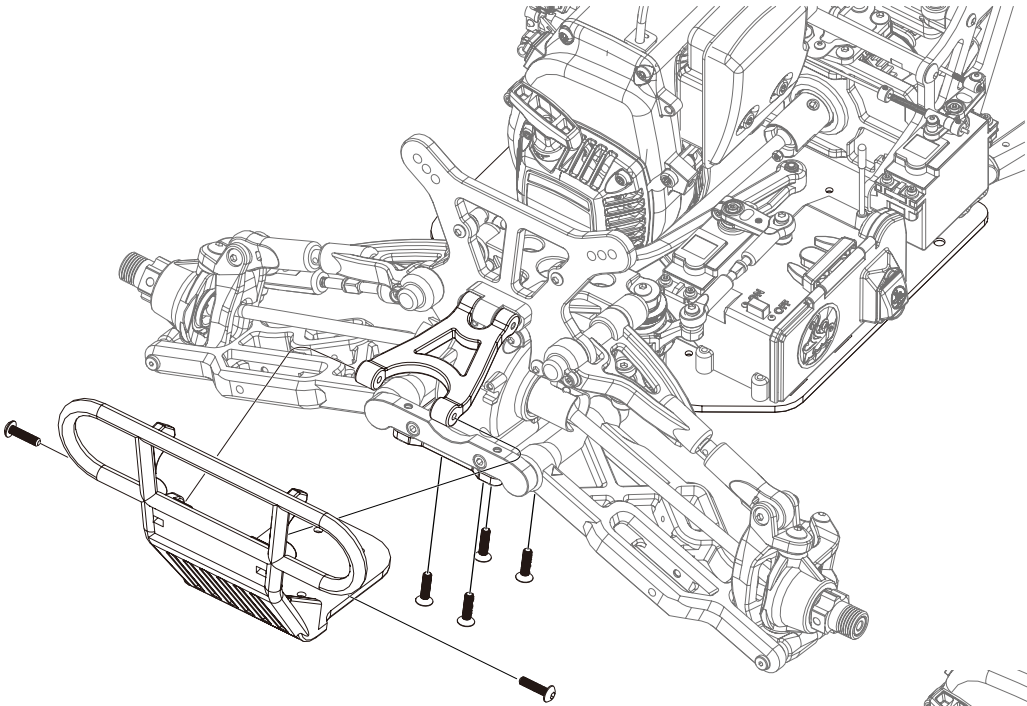



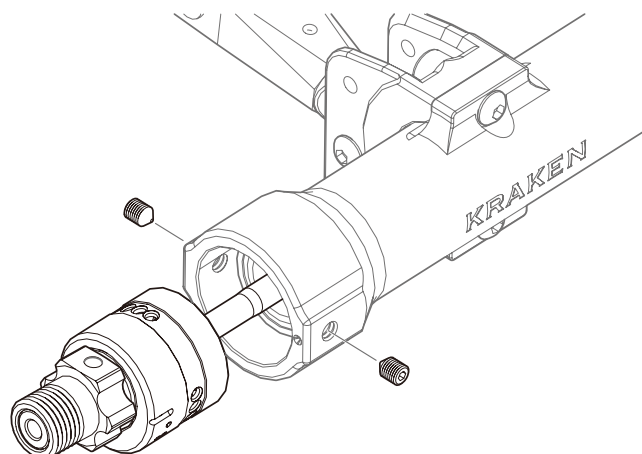
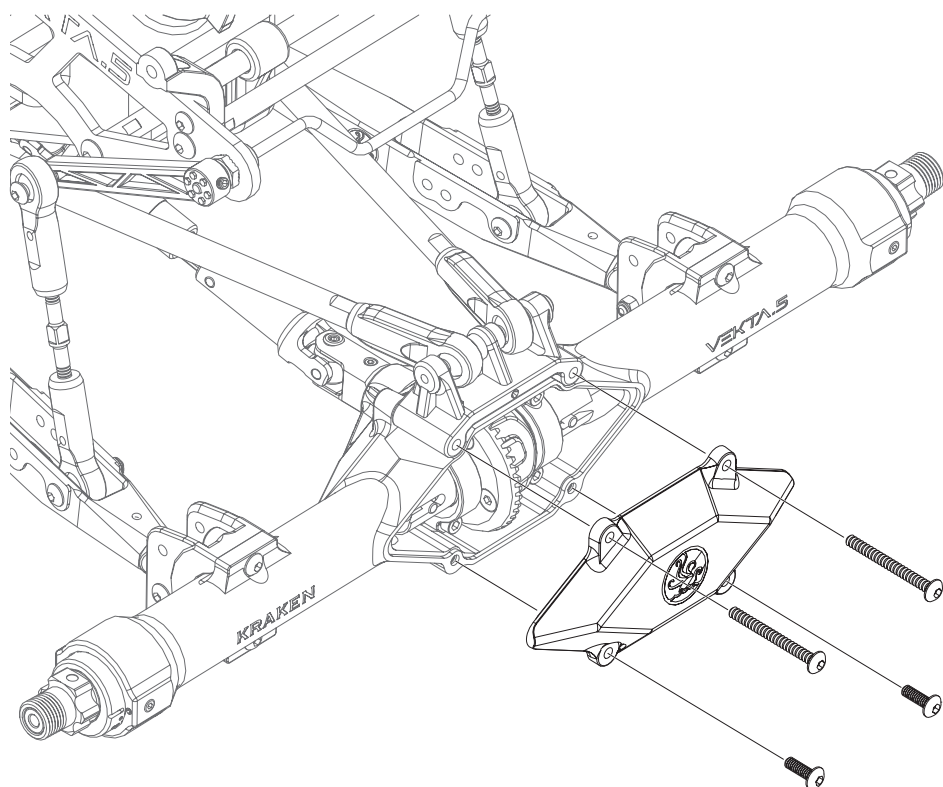
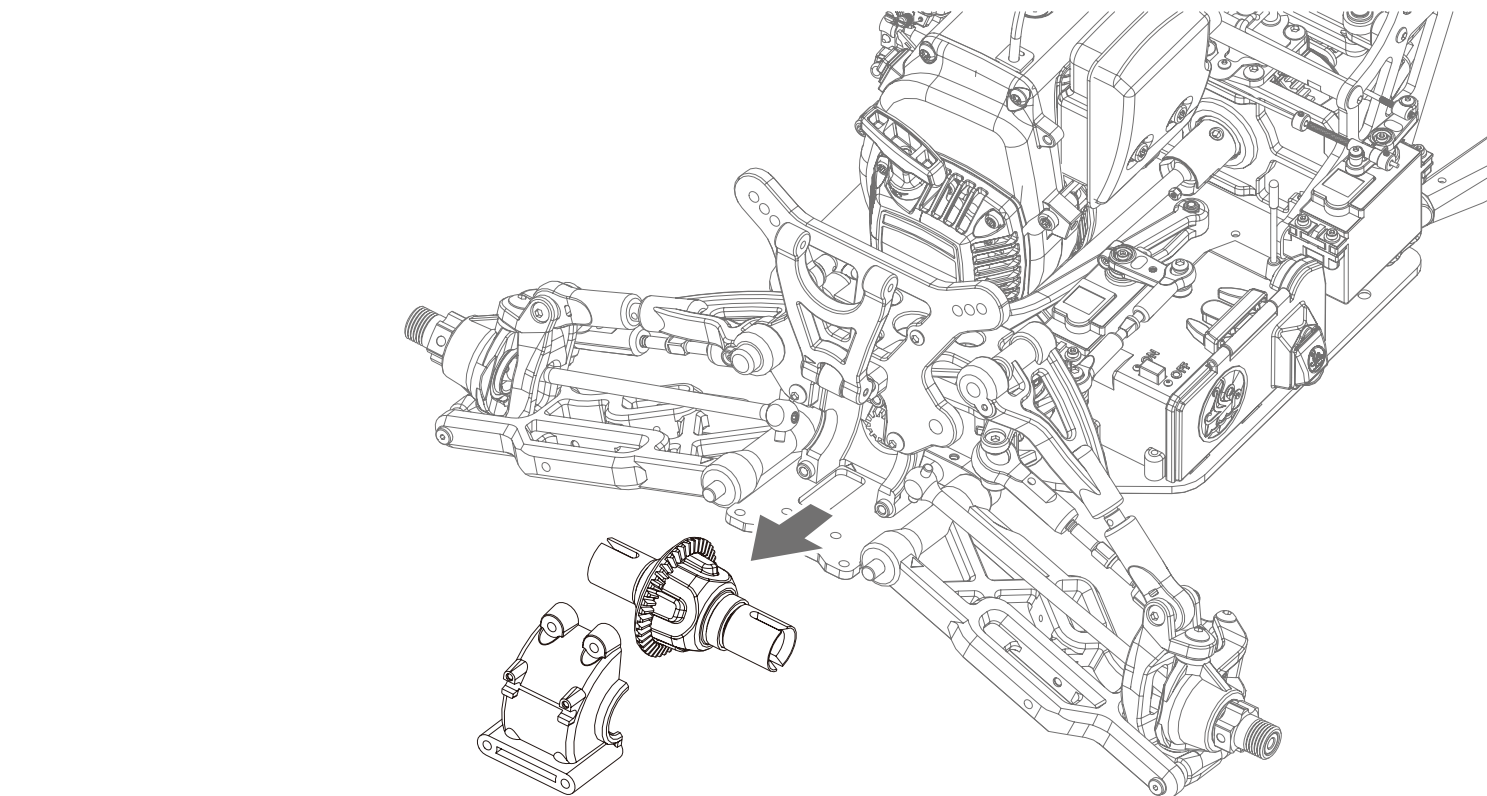

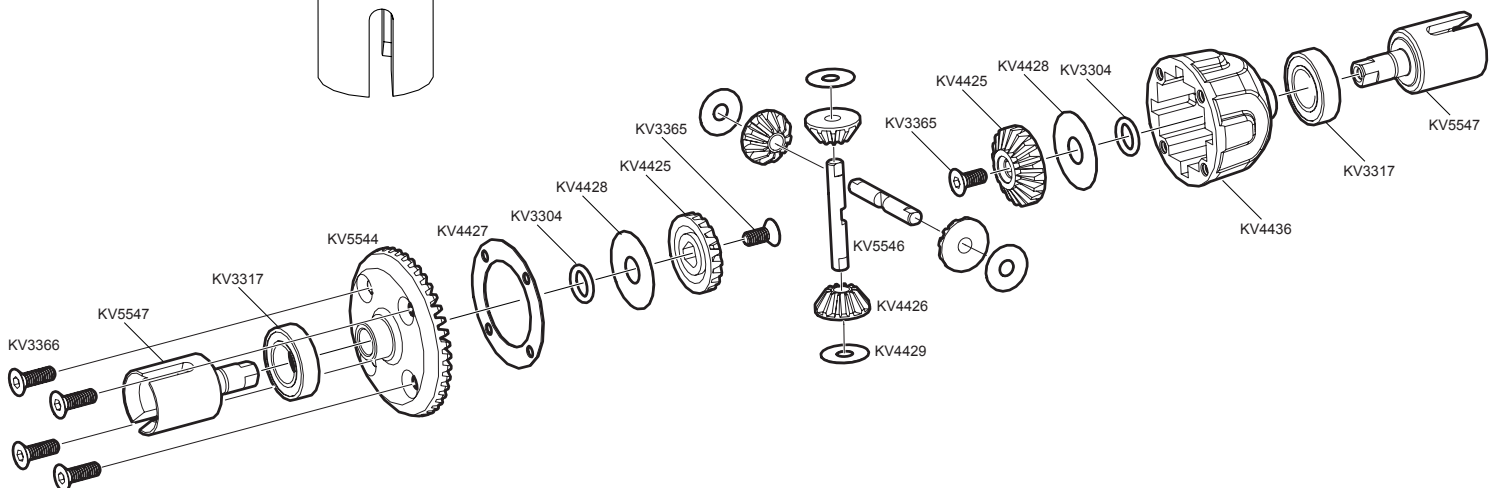
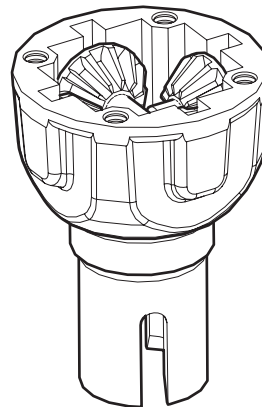
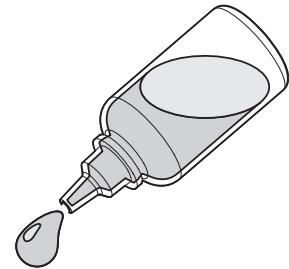
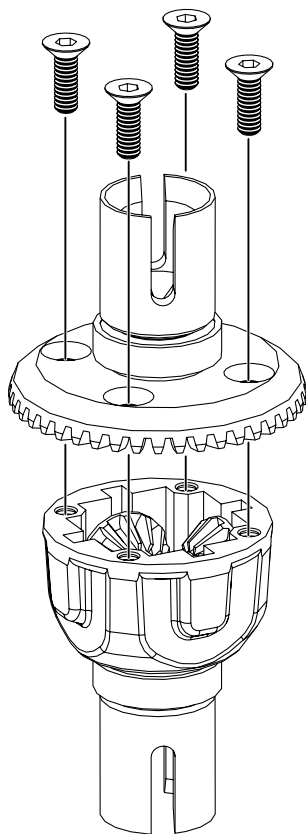
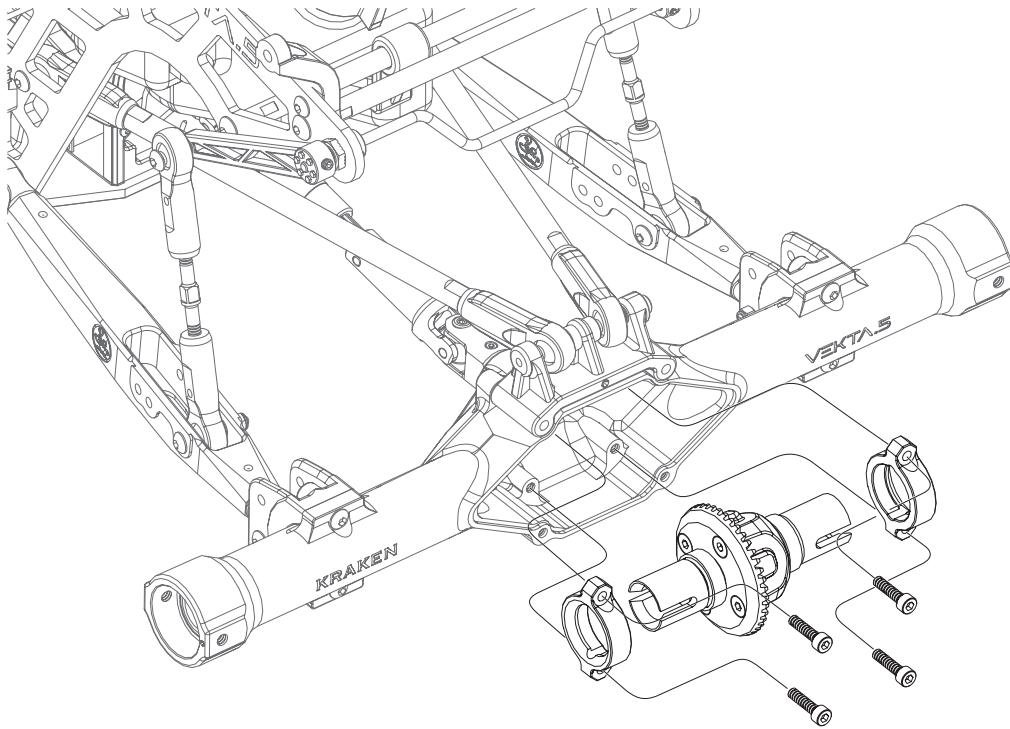

## ADJUSTING THE SLIPPER CLUTCH

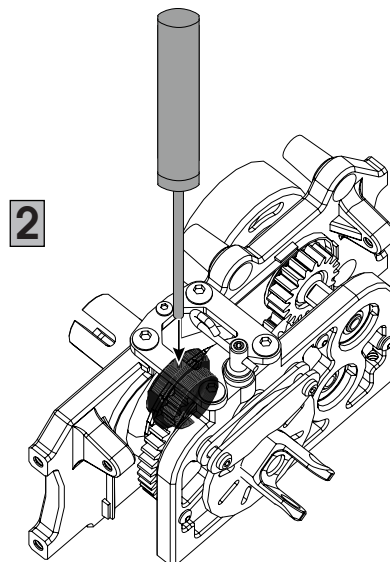
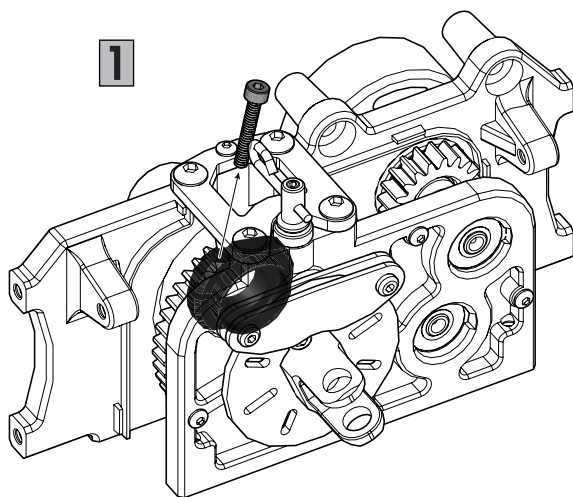

3

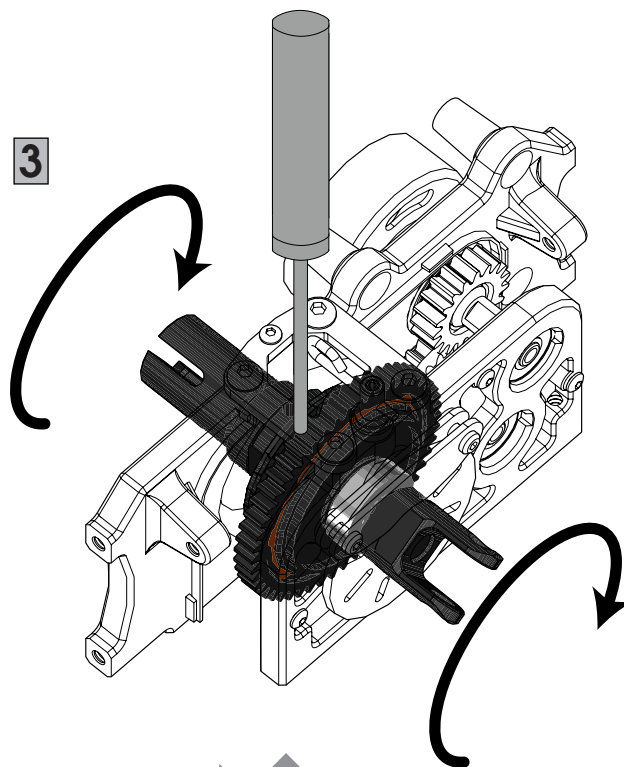

4

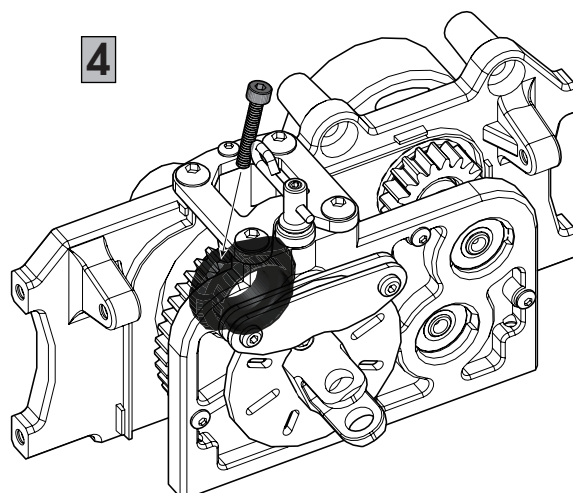

1. Remove or loosen the retainer screw.

2. Locate the jam hole on the other side of the adjusting nut. Use a 4mm driver to secure the nut. (Caution: Do not jam into the threaded hole where you just removed the screw from!)

3. While the adjusting nut is secured, rotate accordingly to loosen or tighten the slipper assembly.

4. When done, apply some blue threadlock and screw back in the retainer screw until snug. Be careful not to overtighten as you may strip it.

Tip: Alternatively, you can remove the entire Spur/Slipper assembly and adjust the nut using a wrench.



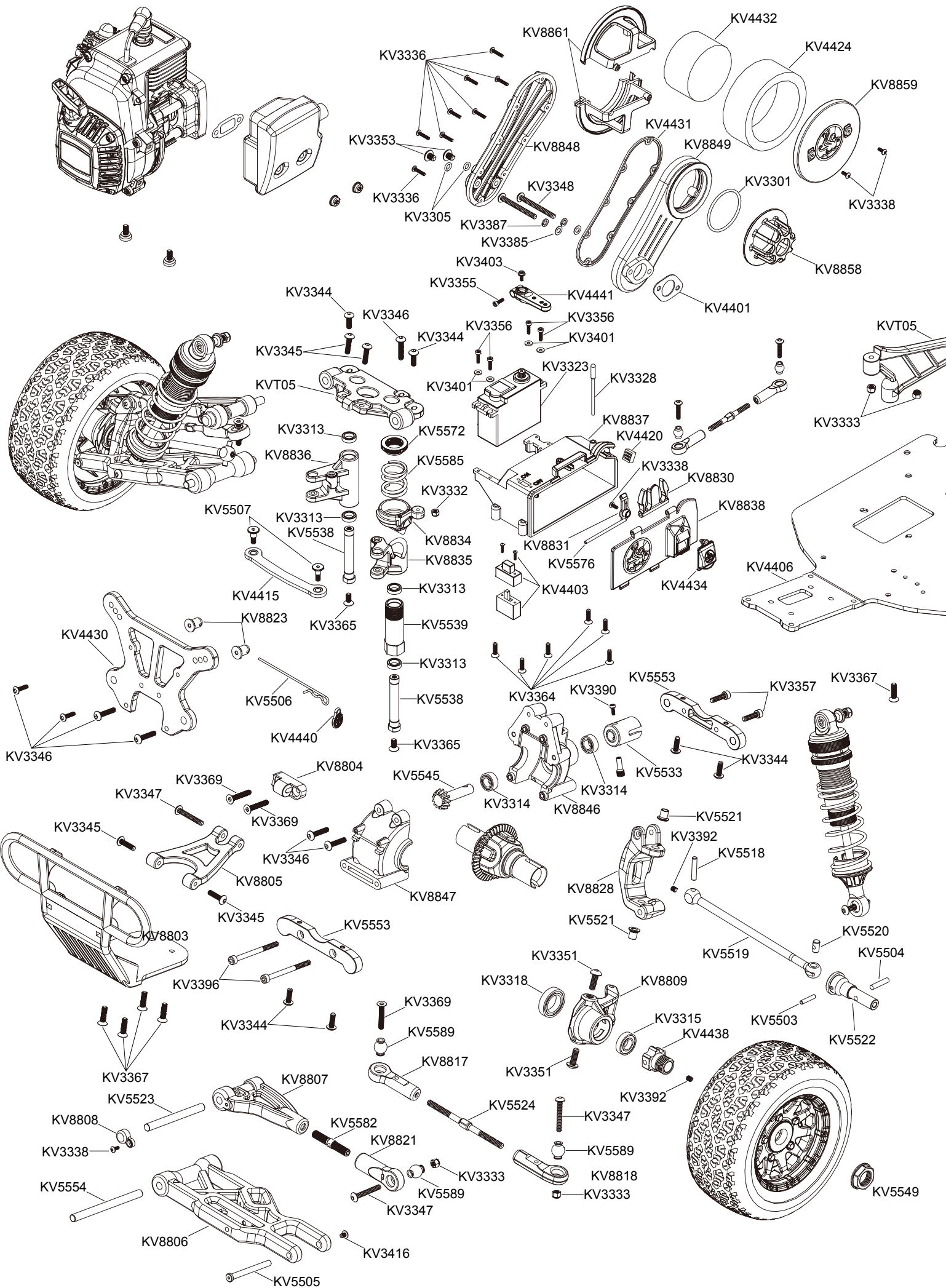







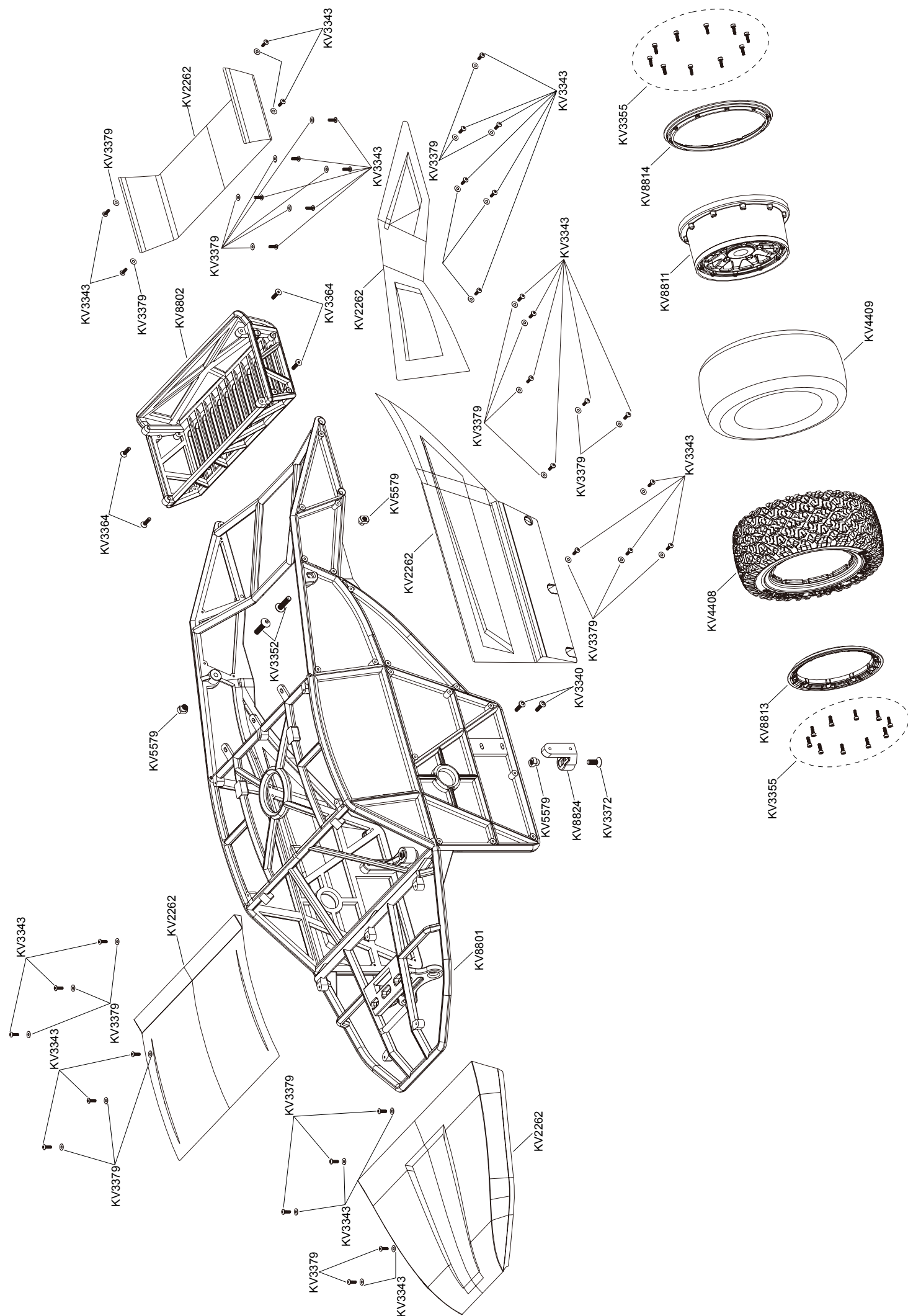



## PARTS LIST

Part #	PRODUCT DESCRIPTION	Part #	PRODUCT DESCRIPTION
KV7701	KV5 ARTR NO ENGINE	KV8840	KV5 Fuel Tank Air Room
KV7702	KV5 ARTR WITH ENGINE	KVT13	KV5 Fuel Tank Mounts
KV8801	KV5 Roll Cage	KV8841	KV5 Fuel Tank Mount 01
KV8802	KV5 Roll Cage Rear Basket	KV8842	KV5 Fuel Tank Mount 02
KVT01	KV5 Front Bumper Set	KV8843	KV5 Throttle Pivot
KV8803	KV5 Front Bumper	KV8844	KV5 Brake Pivot
KV8804	KV5 Front Bumper Support Mount	KV8845	KV5 Brake Pivot Washer
KV8805	KV5 Front Bumper Support Brace	KVT14	KV5 Front Transmission Case
KVT02	KV5 Front Arms Set	KV8846	KV5 Front Bulk, Inner
KV8806	KV5 Front Lower Arm	KV8847	KV5 Front Bulk, Outer
KV8807	KV5 Front Upper Arm	KVT15	KV5 Air Filter Plenum
KV8808	KV5 Front Upper Arm Shaft Retainer	KV8848	KV5 Air Filter Manifold Cover
KVT03	KV5 Spindle Set	KV8849	KV5 Air Filter Manifold Base
KV8809	KV5 Spindle Left	KVT16	KV5 Shocks Plastic Assembly Set
KV8810	KV5 Spindle Right	KV8850	KV5 Shock Spring Perch
KV8811	KV5 Wheel (set of 2)	KV8851	KV5 Shock Piston
KV8812	KV5 Hex	KV8852	KV5 Shock Back-Up Ring
KVT04	KV5 Wheel Beadlock (set of 2)	KV8853	KV5 Shock Shaft Guide
KV8813	KV5 Outer Wheel Beadlock (Set of 4)	KV8854	KV5 Shock Shaft End
KV8814	KV5 Inner Wheel Beadlock (Set 4)	KV8855	KV5 Shock Top End
KVT05	KV5 Brace Set	KV8856	KV5 Shock Shaft Guide A
KV8815	KV5 Steering Upper Brace	KVT17	KV5 4 Link Suspension Bracket Set
KV8816	KV5 Chassis Brace	KV8857	KV5 4 Link Upper Mount
KVT06	KV5 Rod Ends Set	KV8858	KV5 4 Link Lower Mount
KV8817	KV5 Ball End 13.8x50x6	KVT18	KV5 Air Filter Housing
KV8818	KV5 OffSet Ball End 13.8x50x6	KV8859	KV5 Air Filter Cover
KV8819	KV5 Ball End 9.8x35x5	KV8860	KV5 Air Filter Inner Cage
KV8820	KV5 Ball End 9.8x20x5	KV8861	KV5 Air Filter Clamp
KV8821	KV5 Ball End 13.8x50x8	KV8862	KV5 Air Filter Inner Plan
KV8870	KV5 Ball End B13.8x50x6,B	KV5501	KV5 Collar 5x10x7, ZenoAH
KV8871	KV5 Ball End B13.8x50x6,C	KV5502	KV5 L5-Ch2 Throttle Spring
KVT07	KV5 Roll Cage Brackets/Rear Sway Bar Mounts	KV5503	KV5 Pin 4x19.8
KV8822	KV5 Front Cage Support 2a	KV5504	KV5 Pin 5x23.4
KV8823	KV5 Front Cage Support 2b	KV5505	KV5 Hinge Pin 59
KV8824	KV5 Cage Mount 3	KV5506	KV5 R-Pin, 10 Long Leg
KV8825	KV5 Cage Mount 4	KV5507	KV5 Steering Drag Link Bolt (set of 2)
KV8826	KV5 Front Sway Rod	KV5508	KV5 Ball 13.8x5 (set of 2)
KV8827	KV5 Front Sway Bar Holder	KV5509	KV5 Shock Stand (set of 2)
KVT08	KV5 Front Spindle Carrier Set	KV5510	KV5 Rear Full Trailing Arm
KV8828	KV5 Front Spindle Carrier, Left	KV5511	KV5 Collar 5.3x10x10, KS
KV8829	KV5 Front Spindle Carrier, Right	KV5512	KV5 FlangeBushing 6x10 (Set of 2)
KVT09	KV5 Servo & Battery Mounts	KV5513	KV5 Frame Rods (Set of 4)
KV8830	KV5 Radio Tray Clip	KV5514	KV5 Center Drive Shaft B17x200
KV8831	KV5 Radio Tray Connector Mount	KV5515	KV5 Uni Drive Shaft
KV8832	KV5 Ch2 Sx Mount (Throttle Brackets (2))	KV5516	KV5 Pin 5x18
KV8833	KV5 Ch1 Sx Mount (Steering Bracket)	KV5517	KV5 Pin 5x23.5
KVT10	KV5 Steering Horn Assembly	KV5518	KV5 Pin 5x26.5
KV8834	KV5 Steering Horn A	KV5519	KV5 Uni Hub Pin 9x24x5
KV8835	KV5 Steering Horn B	KV5520	KV5 Uni Hub Pin 7x12.5x4
KV8836	KV5 St Horn C	KV5521	KV5 King Pin Bushing (set of 4)
KV8837	KV5 Radio Tray Box	KV5522	KV5 Uni Wheel Axle
KV8838	KV5 Radio Tray Cover	KV5523	KV5 Front Upper Arm Shaft
KV8839	KV5 Fuel Tank Cover	KV5524	KV5 Steering turnbuckle (set of 2)

## PARTS LIST

Part #	PRODUCT DESCRIPTION	Part #	PRODUCT DESCRIPTION
KV5525	KV5 Uni Hub	KV5578	KV5 King Pin Nut A
KV5526	KV5 Clutch Bolt	KV5579	KV5 Metal Roll Cage Inserts (set of 4)
KV5527	KV5 Brake Pad Bolt	KV5580	KV5 Rear Sway Bar Holder
KV5528	KV5 Brake Cam Shaft	KV5581	KV5 Lock Alum Nut M10
KV5529	KV5 Slipper Shaft	KV5582	KV5 Turnbuckle Set for Front Upper Arms (set of 2)
KV5530	KV5 Uni Yoke Joint, Brake	KV5583	KV5 Billet Alum. Rear Solid Axle Housing
KV5531	KV5 Uni Yoke Joint, TS-Hollow	KV5584	KV5 Rear Solid Axle Billet Alum. Cover
KV5532	KV5 Uni Yoke Joint, TS-Shaft	KV5585	KV5 Steering Torsion Spring
KV5533	KV5 Drive Cup	KV5586	KV5 Turnbuckle M5x30
KV5534	KV5 Transmission Spur Gear	KV5587	KV5 Turnbuckle M5x40
KV5535	KV5 Slipper Disc (set of 2)	KV5588	KV5 B9.8x12x4 (Rod End Ball) (set of 4)
KV5536	KV5 Adjusting Nut	KV5589	KV5 B13.8x17x5 (Rod End Balls) (set of 4)
KV5537	KV5 19T Transmission Pinion Gear	KV5590	KV5 Brake Lever
KV5538	KV5 Steering Post	KV5591	KV5 Front Cage Support Pin
KV5539	KV5 Steering Tube	KV4401	KV5 Air Filter Manifold Paper Gasket
KV5540	KV5 Rear Sway Bar	KV4402	KV5 Fuel Tank Rubber Damper
KV5541	KV5 Front Sway Bar	KV4403	KV5 Switch Boot
KV5542	KV5 Sway Bar Pivot Ball, B9.8	KV4404	KV5 Verticle Chassis Frame, Left
KV5543	KV5 Rear Upper Link Rod (set of 2)	KV4405	KV5 Verticle Chassis Frame, Right
KV5544	KV5 Diff Ring Gear	KV4406	KV5 Main Chassis
KV5545	KV5 F/R Differential Pinion Gear, 13T	KV4407	KV5 Main Gear Plate B
KV5546	KV5 Diff Cross Pin	KV4408	KV5 Kraken ATD Tires (set of 2)
KV5547	KV5 Diff out drive set (set of 2)	KV4409	KV5 Inner Sponge (set of 2)
KV5548	KV5 Shock Caps (set of 2)	KV4410	KV5 Main Gear Plate A
KV5549	KV5 Wheel Nuts (set of 4)	KV4411	KV5 Brake Pad
KV5550	KV5 Ch2 Brake Rod	KV4412	KV5 Brake Disc
KV5551	KV5 Ch2 Throttle Rod	KV4413	KV5 Fuel Tank Air Bubble
KV5552	KV5 Brake Cam Block	KV4414	KV5 Slipper Pad (set of 2)
KV5553	KV5 Aluminum Front Lower Arm Brace	KV4415	KV5 Steering Drag Linkage
KV5554	KV5 Front Lower Arm Shaft	KV4416	KV5 StSxUpper Bar
KV5555	KV5 Aluminum Front Shock Body (set of 2)	KV4417	KV5 Fuel Tank Rubber Diaphragm
KV5556	KV5 Aluminum Rear Shock Body (set of 2)	KV4418	KV5 Rear Sway Bar Lever
KV5557	KV5 Front Shock Shaft	KV4419	KV5 Rear Lower Link Mount (set of 2)
KV5558	KV5 Rear Shock Shaft	KV4420	KV5 Wire Grommet
KV5559	KV5 Aluminum Shock Seal Cap	KV4421	KV5 Clutch Bell
KV5560	KV5 Shock Spring Adjusting Ring	KV4422	KV5 Clutch Shaft
KV5561	KV5 Front Shock Spring (set of 2)	KV4423	KV5 Fuel Tank
KV5562	KV5 Rear Shock Spring (set of 2)	KV4424	KV5 Air Filter Outer Sponge
KV5563	KV5 Front Mount for Verticle Frames (set of 2)	KV4425	KV5 Diff Bevel Sun Gear
KV5564	KV5 TS-Hollow	KV4426	KV5 Diff Bevel Planet Gear
KV5565	KV5 TS-Shaft	KV4427	KV5 Diff Gasket
KV5566	KV5 Screw Pin 8x5x22	KV4428	KV5 Diff Washer 10x30x03
KV5567	KV5 King Pin Nut	KV4429	KV5 Diff Washer 6x18x03
KV5568	KV5 T19-22 Transmission Step Gears	KV4430	KV5 Front Shock Tower
KV5569	KV5 Rear Wheel Hub, L	KV4431	KV5 Air Filter Manifold Rubber Seal
KV5570	KV5 Rear Wheel Hub- R	KV4432	KV5 Air Filter Inner Sponge
KV5571	KV5 Brake Cam Shaft Bushing	KV4433	KV5 Shock Diaphragm
KV5572	KV5 St Spring Adj Ring	KV4434	KV5 Charge Boot
KV5573	KV5 Rod Adjusting Collar	KV4435	KV5 Center Upper Plate
KV5574	KV5 Rod Stopper 2.8	KV4436	KV5 Diff Case
KV5575	KV5 Engine Washer FH5 (set of 4)	KV4437	KV5 Diff Case Bushing
KV5576	KV5 Pin 3x60	KV4438	KV5 Wheel Hex Driver 24
KV5577	KV5 Rear Sway Bar Turnbuckles Set (set of 2)	KV4439	KV5 Diff Bearing Bracket for rear solid axle (set of 2)

PARTS LIST

Part #	PRODUCT DESCRIPTION	Part #	PRODUCT DESCRIPTION
KV4440	KV5 Pull Tabs for Hook Pin (set of 4)	KV3351	KV5 ScrewBH6x18
KV4441	KV5 Ch1 Sx Horn, 25T	KV3352	KV5 ScrewBH6x25
KV4442	KV5 Ch2 Sx Horn, 25T	KV3353	KV5 ScrewBH6x8
KV3301	KV5 ORing 44.12x2.62	KV3354	KV5 ScrewCap3x8
KV3302	KV5 ORing 33.5x2	KV3355	KV5 ScrewCap3x10
KV3303	KV5 ORing 8x4	KV3356	KV5 ScrewCap3x12
KV3304	KV5 ORing 9.8x2.4	KV3357	KV5 ScrewCap5x20
KV3305	KV5 ORing 5.8x1.9	KV3358	KV5 ScrewCap5x52
KV3306	KV5 Disk Spring 25.4x50x2 (set of 3)	KV3359	KV5 Washer5x10x1
KV3307	KV5 Gear Cover A, 0.8 (Transmission Cover)	KV3360	KV5 Washer5x10x1.5
KV3308	KV5 Gear Cover B, 0.8	KV3361	KV5 ScrewCap6x35
KV3309	KV5 (2702167) L5 Fuel Filter Stone	KV3362	KV5 Washer6x12x1.9(SW6)
KV3310	KV5 (2702164) L5 Fuel Tank Rubber Plug	KV3363	KV5 ScrewFH3x12
KV3311	KV5 Black Fuel Line	KV3364	KV5 ScrewFH4x16
KV3312	KV5 Yellow Carb Fuel Line	KV3365	KV5 ScrewFH5x12
KV3313	KV5 Bearing 10x15x4	KV3366	KV5 ScrewFH5x15
KV3314	KV5 Bearing 10x19x7	KV3367	KV5 ScrewFH5x20
KV3315	KV5 Bearing 12x24x6	KV3368	KV5 ScrewFH5x25
KV3316	KV5 Bearing 12x28x8	KV3369	KV5 ScrewFH5x30
KV3317	KV5 Bearing 15x28x7	KV3370	KV5 ScrewFH5x60
KV3318	KV5 Bearing 20x32x7	KV3371	KV5 ScrewFH5x70
KV3319	KV5 Bearing 8x22x7	KV3372	KV5 ScrewFH6x16
KV3320	KV5 BxSet5x1	KV3373	KV5 ScrewSS3x4
KV3321	KV5 BxSet Connector-Plug	KV3374	KV5 ScrewSS4x5
KV3322	KV5 BxSet Connector-Socket	KV3375	KV5 ScrewSS5x6
KV3323	KV5 Kraken TS-555HV Digital Torque Servo	KV3376	KV5 ScrewSS5x8
KV3324	KV5 Servo Grommet	KV3377	KV5 ScrewSS6x35
KV3325	KV5 Switch	KV3378	KV5 ScrewSS6x8(Taper)
KV3326	KV5 Lipo Bat, Light System, Sample Only	KV3379	KV5 Washer3x8x0.5
KV3327	KV5 Screw BH2x10	KV3380	KV5 Washer4x10x0.8
KV3328	KV5 RC-Ax Straw (avail in kit only)	KV3381	KV5 Washer6x12x1.6
KV3329	KV5 RC-Ax Straw Cap (avail in kit only)	KV3382	KV5 WasherS3x6x1
KV3330	KV5 Ch2 Brake Crush Tube	KV3383	KV5 WasherS8x15.6x2.5
KV3331	KV5 Lock Nut 3	KV3384	KV5 KS Racing 29cc Engine
KV3332	KV5 Lock Nut 4	KV3385	KV5 Washer5x10x0.8
KV3333	KV5 Lock Nut 5	KV3386	KV5 WasherS5x10x1.3
KV3334	KV5 Lock Nut 6		KV5 Lock Washer, S5x8.6x1.2
KV3335	KV5 ScrewBH3x10		KV5 Screw BH 5x10
KV3336	KV5 ScrewBH3x15		KV5 Screw Cap 4x25
KV3337	KV5 ScrewBH3x5		KV5 Screw FH 3x8
KV3338	KV5 ScrewBH3x8		KV5 Screw FH 4x12
KV3339	KV5 ScrewBH4x12		KV5 Screw SS 5x5
KV3340	KV5 ScrewBH4x16		KV5 Screw SS 5x10
KV3341	KV5 ScrewBH4x20		
KV3342	KV5 ScrewBH4x30		
KV3343	KV5 ScrewBH5x12		
KV3344	KV5 ScrewBH5x16		
KV3345	KV5 ScrewBH5x20		
KV3346	KV5 ScrewBH5x25		
KV3347	KV5 ScrewBH5x35		
KV3348	KV5 ScrewBH5x50		
KV3349	KV5 ScrewBH5x8		
KV3350	KV5 ScrewBH6x12		











***LIFE IS SHORT...BASH HARD!***



KRAKEN RC, INC. CALIFORNIA, USA.

[WWW.KRAKENRC.COM](http://WWW.KRAKENRC.COM)